

Acct ID: 536117 MTL: 093W02B001100 Date: *10/22/24* Appr: *WV* Prop Class: 581 RMV Prop Class: 581
 Situs: 9483 JACKSON HILL RD SE SALEM OR 97306 MaSaNh: 06 06 000 Unit: 29696 Year: 2024

Last Date Appraised: 04/26/2021 Appraiser: WENDY WILLIAMS Retag: Y N Tag info:

Owner: ASHER, LEE MATTHEW

Roll Type: R

Cycle Tag Sales Verification Other: _____ Inspection level: 1 *(2)* 3 4 LCB TTO INSP *SPW Steve - manager* AV: 140650
 RMV Land: 322740 RMV Imp: 133580 RMV Total: 456320 MAV: 85060 MSAV: 55590 SAV: 153141

Comment: 22-23: L4 11.18.21 WV
 Level 4 11.18.21 WV06
 LEVEL 2 4.26.21 CL10

Add new structures, gone up, began to

Notations

RP/MS	Code	Description
RP	DFL	DESIGNATED FORESTLAND
RP	ZONED	FARM EFU ZONED

Animal Sanctuary DFL ok No farm use DO all farm SA

OSDs

Count	Code	Description	RMV	Code Area	Exception
1	SAF	SA OSD - FAIR	35000	92590	0

Land

Site: 1	Code Area: 92590	Size: 1.00 Acres	Use Code: 005	Zone: REST	SAV Use: 011	Exception: 0
Class: 4HD	Value Source: Farm Homesite	Description: FOUR HILL DRY	RMV: 4730	Exception: Y N		
Adjustment(s): IRR	Fire Patrol:		Description:			
Comments: Liability year - 2021 / ***22-23: Per #06WV approved to requalify 4.0 additional acres farm use./cwo/**21-22: WAS SPECIALLY ASSESSED SINCE 1980. AT MARKET FOR 2018-19 THRU 2020- 21. 52.11 ACRES REQUALIFIED FOR 2021-2022 TAX YEAR.***/19-20: DISQ FARM USE. DISQ HOMESITE AND OSD AS IT IS NOT PART OF A PARCEL THAT HAS 10 ACRES OF TREES.// 18-19: DISQ 4.2 ACRES STF// 00-01; REAPPRAISAL, 04-05: ROLLOVER FROM DESIG FOREST TO STF PROGRAM						
Site: 3	Code Area: 92590	Size: 4.20 Acres	Use Code: 005	Zone: REST	SAV Use: 011	Exception: 0
Class: FTLC	Value Source: Designated Forest Land	Description: DFL Class C	RMV: 18900	Exception: Y N		
Adjustment(s): IRR	Fire Patrol:		Description:			
Comments: Liability year - 1980 / 00-01: ROLLOVER OF FARM LAND INTO DF /00-01; REAPPRAISAL, 2400190 04-05: ROLLOVER FROM DESIG FOREST TO STF PROGRAM; CHG LAND TYPE FROM DESIG FOREST FCO TO STF C. //07-08: 2.8 DISQ STF, ROLL INTO FARMLAND						
Site: 4	Code Area: 92590	Size: 51.61 Acres	Use Code: 005	Zone: REST	SAV Use: 011	Exception: 0
Class: 4HI	Value Source: Farm Use - EFU	Description: FOUR HILL IRR	RMV: 243860	Exception: Y N		
Adjustment(s): IRR	Fire Patrol:		Description:			
Comments: Liability year - 2021						
Site: 5	Code Area: 92590	Size: 0.50 Acres	Use Code: 005	Zone: REST	SAV Use: 011	Exception: 0
Class: Water	Value Source: Pond	Description: Ponds, rivers, creeks, streams, lakes	RMV: 2250	Exception: Y N		
Adjustment(s): IRR	Fire Patrol:		Description:			
Comments: Liability year - 2021						
Site: 6	Code Area: 92590	Size: 4.00 Acres	Use Code: 005	Zone: REST	SAV Use: 011	Exception: 0
Class: 4HD	Value Source: Farm Use - EFU	Description: FOUR HILL DRY	RMV: 18000	Exception: Y N		
Adjustment(s): IRR	Fire Patrol:		Description:			
Comments: 00-01: CHG OF SOIL CLASS FROM WOODLOT TO WASTELAND /00-01; REAPPRAISAL						

Improvements - Residence / Manufactured Structures

Bldg: 1	Code Area: 92590	Stat Class: 132	Year Blt: 1901	Eff Year Blt: 1922	Sq.Ft: 1800	% Complete: 100
Desc: Multi Story above grade			Dimensions:		RMV: 121130	
Func Obsc: 100	Econ %: 100	Other %: 100	Exception: 0	Adjust:	Adjust RMV: 0	

1960

Floors

Type	Class	Display Group	Floor Size	Beds	Baths	Yr Blt	Eff Yr Blt	Inventory	Exception: Y N
First Floor	3	Finished	900	2	FB-1/ HB-1	1901	1922	BATH - 1, BTH - 1, KIT-, ROOF, HVAC	Exception: Y N
Attic	3	Finished	900	3	0	1901	1922	HVAC	Exception: Y N
Garage Attached	2	Unfinished	394	0	0	1925	1901	ROOF	Exception: Y <i>(N)</i>

Should have updated before @ 1/0

Accessories

Description	Class	Size SqFt	Eff Yr Blt	RMV	Quantity	Exception: Y N
DECK	3	210	1922	2495	1	Exception: Y N
PATIO	3	210	1922	624	1	Exception: Y N
ROOF EXTENSION OR PATIO COVER	3	75	1922	1175	1	Exception: Y N
ROOF EXTENSION OR PATIO COVER	3	210	1922	3289	1	Exception: Y N

Y13FA 1/0

Improvements - Accessory Buildings

SKETCH/AREA TABLE ADDENDUM

SUBJECT INFO

File No.: 536117 Parcel No.: 093W 02B 01100
 Property Address: 9483 Jackson Hill Rd SE
 City: Salem County: MARION State: OR ZipCode: 97306
 Owner:
 Client: Client Address:
 Appraiser Name: Inspection Date:

SKETCH

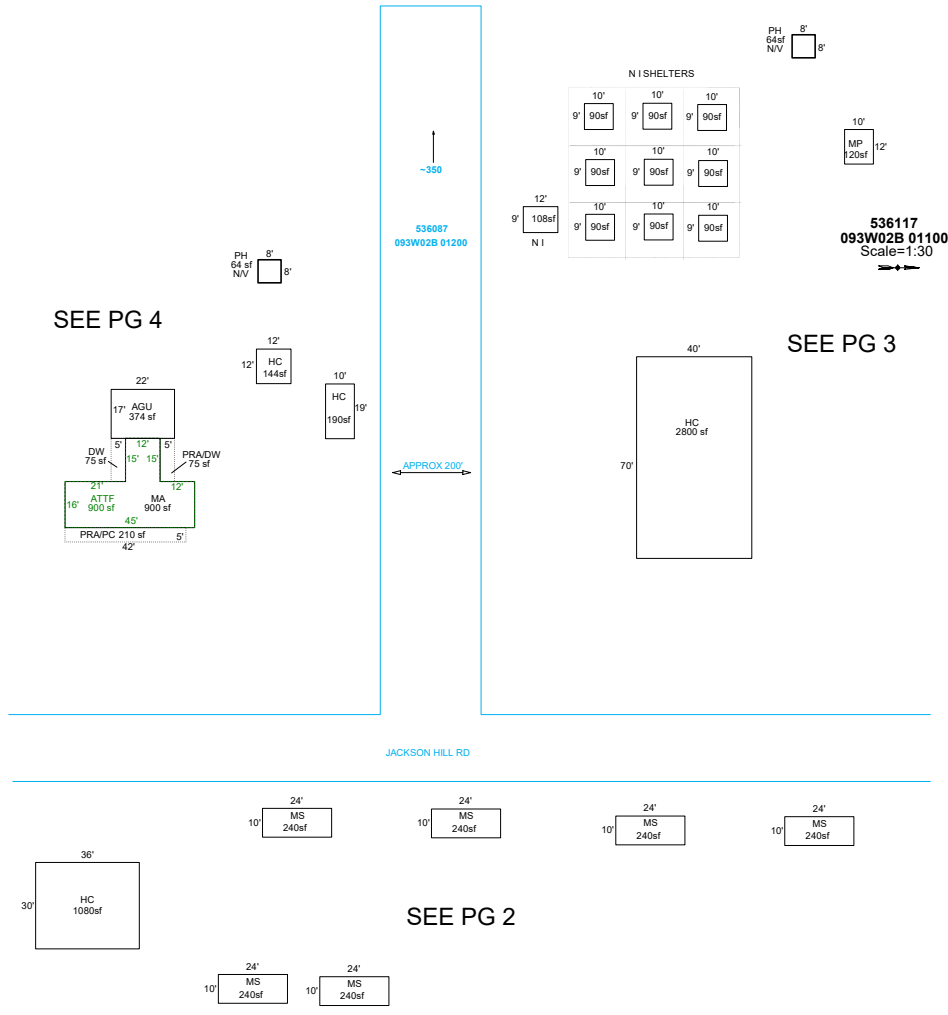

Sketch by ApexSketch

AREA CALCULATIONS SUMMARY

COMMENT TABLE 1

Code	Description	Factor	Net Size	Perimeter	Net Totals
GBA1	N I SHELTER	1.0	90.0	38.0	
	N I SHELTER	1.0	90.0	38.0	
	N I SHELTER	1.0	90.0	38.0	
	N I SHELTER	1.0	108.0	42.0	
	N I SHELTER	1.0	90.0	38.0	
	N I SHELTER	1.0	90.0	38.0	
	N I SHELTER	1.0	90.0	38.0	
	N I SHELTERS	1.0	90.0	38.0	
	N I SHELTER	1.0	90.0	38.0	
	PH	1.0	64.0	32.0	
	HC	1.0	2800.0	220.0	
GBA3	MP	1.0	120.0	44.0	3846.0
	HC	1.0	1080.0	132.0	120.0
GBA6	MS	1.0	240.0	68.0	
	13 addl items				
	Net LIVABLE	cnt	2 (rounded)		1,800
	Net BUILDING	cnt	21 (rounded)		6,486

Apex 5/27/2011 Jane UPDATED BY CHRIS 10/25/19 UPD BY PHU 01.12.20 UPDATED BY CJURAN 06/16/2021 UPDATED BY WWILLIAMS 6/26/25	
COMMENT TABLE 2	COMMENT TABLE 3
#10 CL 04/26/2021 WW 10/22/24	TAGS L2 CYCLE L2

SKETCH/AREA TABLE ADDENDUM

SUBJECT INFO

File No.: 536117 Parcel No.: 093W 02B 01100
 Property Address: 9483 Jackson Hill Rd SE
 City: Salem County: MARION State: OR ZipCode: 97306
 Owner:
 Client: Client Address:
 Appraiser Name: Inspection Date:

SKETCH

E SIDE OF JACKSON HILL RD

536117
093W02B 01100
 Scale=1:30

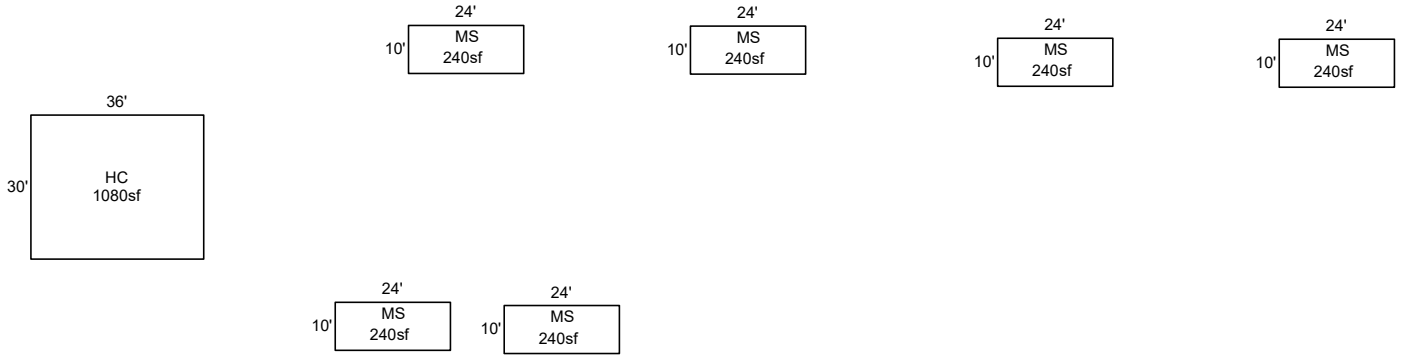

Sketch by ApexSketch

AREA CALCULATIONS SUMMARY

Code	Description	Factor	Net Size	Perimeter	Net Totals
GBA6	MS	1.0	240.0	68.0	
	MS	1.0	240.0	68.0	
	MS	1.0	240.0	68.0	
	MS	1.0	240.0	68.0	
	MS	1.0	240.0	68.0	
	MS	1.0	240.0	68.0	
	HC	1.0	1080.0	132.0	2520.0
	Net BUILDING	cnt	7 (rounded)		2,520

COMMENT TABLE 1

Apex 5/27/2011 Jane
 UPDATED BY CHRIS 10/25/19
 UPD BY PHU 01.12.20
 UPDATED BY CJURAN 06/16/2021
 UPDATED BY WWILLIAMS 6/26/25

COMMENT TABLE 2

#10 CL 04/26/2021
 WW 10/22/24

COMMENT TABLE 3

TAGS L2
 CYCLE L2

SKETCH/AREA TABLE ADDENDUM

SUBJECT INFO

File No.: 536117 Parcel No.: 093W 02B 01100
 Property Address: 9483 Jackson Hill Rd SE
 City: Salem County: MARION State: OR ZipCode: 97306
 Owner:
 Client: Client Address:
 Appraiser Name: Inspection Date:

SKETCH

N SIDE OF PROPERTY

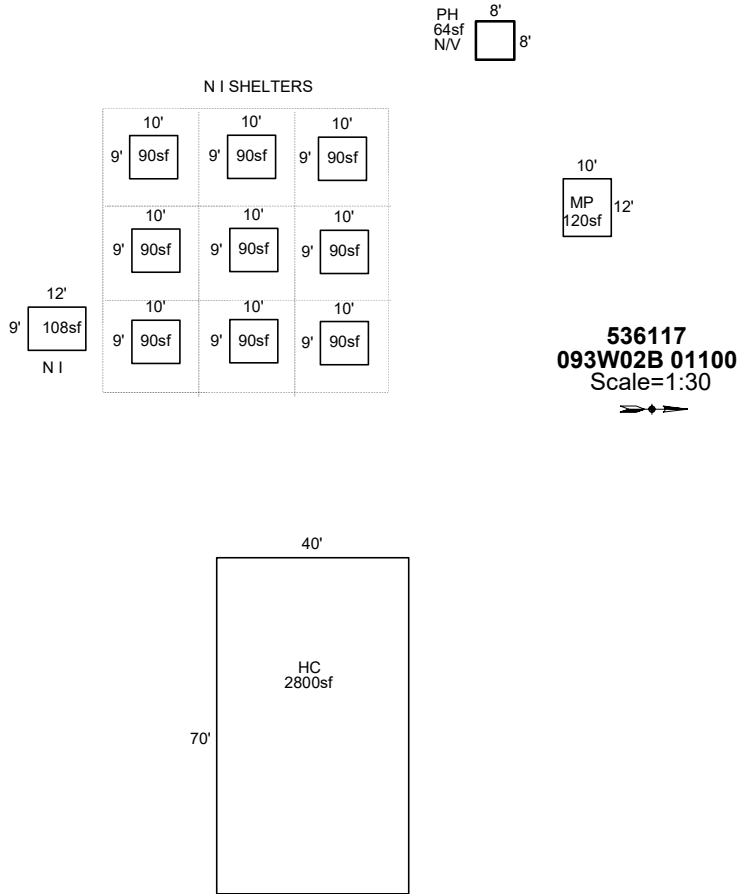

Sketch by ApexSketch

AREA CALCULATIONS SUMMARY

COMMENT TABLE 1

Code	Description	Factor	Net Size	Perimeter	Net Totals
GBA1	N I SHELTER	1.0	90.0	38.0	
	N I SHELTERS	1.0	90.0	38.0	
	PH	1.0	64.0	32.0	
	N I SHELTER	1.0	90.0	38.0	
	N I SHELTER	1.0	90.0	38.0	
	N I SHELTER	1.0	90.0	38.0	
	N I SHELTER	1.0	90.0	38.0	
	N I SHELTER	1.0	108.0	42.0	
	HC	1.0	2800.0	220.0	
	N I SHELTER	1.0	90.0	38.0	
	N I SHELTER	1.0	90.0	38.0	
	N I SHELTER	1.0	90.0	38.0	3782.0
	GBA3	MP	1.0	120.0	44.0
	Net BUILDING	cnt	13 (rounded)		3,902

Apex 5/27/2011 Jane UPDATED BY CHRIS 10/25/19 UPD BY PHU 01.12.20 UPDATED BY CJURAN 06/16/2021 UPDATED BY WWILLIAMS 6/26/25	
COMMENT TABLE 2	COMMENT TABLE 3
#10 CL 04/26/2021 WW 10/22/24	TAGS L2 CYCLE L2

SKETCH/AREA TABLE ADDENDUM

SUBJECT INFO

File No.: 536117 Parcel No.: 093W 02B 01100
 Property Address: 9483 Jackson Hill Rd SE
 City: Salem County: MARION State: OR ZipCode: 97306
 Owner:
 Client: Client Address:
 Appraiser Name: Inspection Date:

SKETCH

S SIDE OF PROPERTY

536117
093W02B 01100
 Scale=1:30

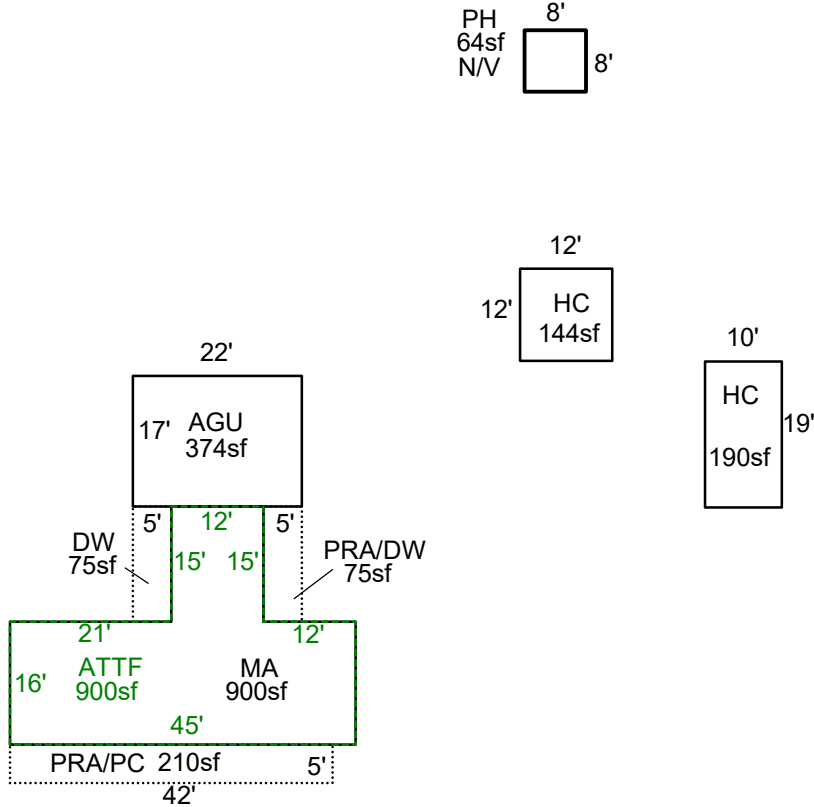

Sketch by ApexSketch

AREA CALCULATIONS SUMMARY

Code	Description	Factor	Net Size	Perimeter	Net Totals
GBA1	PH	1.0	64.0	32.0	64.0
GLA1	MA	1.0	900.0	152.0	900.0
GLA2	ATTF	1.0	900.0	152.0	900.0
GAR	HC	1.0	144.0	48.0	
	HC	1.0	190.0	58.0	
YI	AGU	1.0	374.0	78.0	708.0
	PRA/PC	1.0	210.0	94.0	
	PRA/DW	1.0	75.0	40.0	
	DW	1.0	75.0	40.0	360.0
	Net LIVABLE	cnt	2 (rounded)		1,800
	Net BUILDING	cnt	1 (rounded)		64

COMMENT TABLE 1

Apex 5/27/2011 Jane
 UPDATED BY CHRIS 10/25/19
 UPD BY PHU 01.12.20
 UPDATED BY CJURAN 06/16/2021
 UPDATED BY WWILLIAMS 6/26/25

COMMENT TABLE 2

#10 CL 04/26/2021
 WW 10/22/24

COMMENT TABLE 3

TAGS L2
 CYCLE L2

