

lak 7.24.25

Summary

Lead Appr: _____ Clerk: _____ Lead Clerk: _____ Appr: _____

Print Date: 5/19/2025

Acct ID: 132205

MTL: 062W31D001100P1

Date: 6/16/25

Appr: 02

Prop Class: 019

RMV Prop Class: 019

Situs: 5135 COPPER CREEK LOOP NE # 68 SALEM, OR 97305

MaSaNh: 13 05 000

Unit: 143078

Year: 2025

Last Date Appraised: 02/26/2025

Appraiser: THERESA SWEARINGEN

Retag: Y N

Tag info:

Owner: BARAJAS, ANNALILIA

Roll Type: MS

Cycle Tag Sales Verification

Other: _____

Inspection level: 1 2 3 4 LCP

TTO INSP

AV: 37440

RMV Land: 0

RMV Imp: 73140

RMV Total: 73140

MAV: 37440

MSAV: 0

SAV: 0

Comment: 25-26: SV; L2 02.26.25 TS

Notations

No notation data available.

done during cycle

OSDs

No OSD data available.

Land

No land data available.

Improvements - Residence / Manufactured Structures

Bldg: 1

Code Area: 24010

Stat Class: 447 +

Year Blt: 1992

Eff Year Blt: 2000

Sq.Ft: 1080

% Complete: 100

Desc: MANUF STRUCT, CLASS 4, 26' THROUGH 28' WIDE DOUBLE

Dimensions: 40x27

RMV: 73140

Func Obsc: 100

Econ %: 100

Other %: 100

Exception: 0

Adjust:

Adjust RMV: 0

Floors

Type	Class	Display Group	Floor Size	Beds	Baths	Yr Blt	Eff Yr Blt	Inventory
First Floor	4 +	Finished	1080	3	FB-2	1992	2000	ROOF+, SKIRT, HVAC+, KIT-, BATH - 2
								Exception: Y N

Accessories

Description	Class	Size SqFt	Eff Yr Blt	RMV	Quantity
DECK	4	60	2000	845	0
ROOF EXTENSION OR PATIO COVER	4	260	2000	4826	0

Improvements - Accessory Buildings

No improvement data available for all other stat class types.

BUILDING DIAGRAM AND OUTBUILDINGS

ACCT NO: **M132205**

MAP NO: **62W-31D**

TAX LOT: **01100**

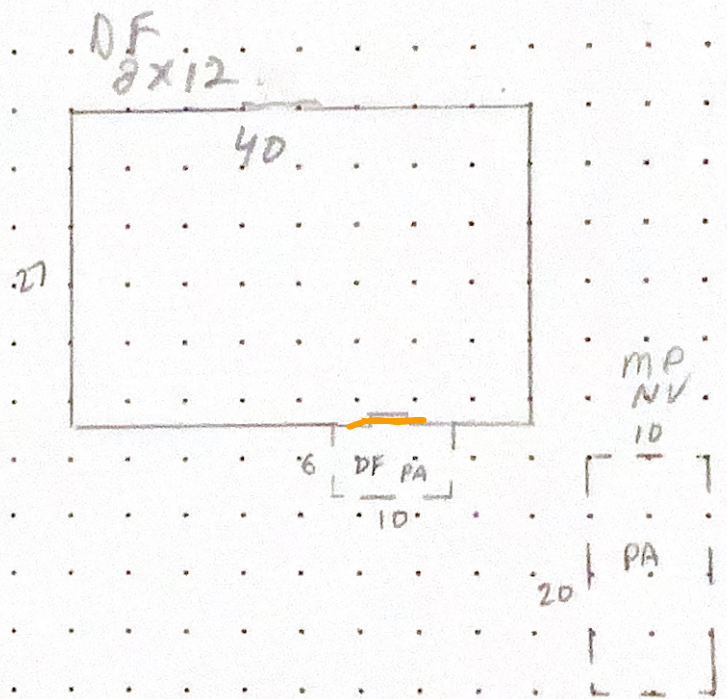

CALCULATIONS: **27 X 40 = 1,080 SF**

SCALE: 1" = 20'

COPPER CRK EST

MEASUREMENT
VERIFIED

YR BLT: **92**

ADDRESS: **5135 COPPER CRK LP.**

SALES
Date Amt.

DATE
8-10-92

BY
DT/4

REMARKS:

BUILDER: **GVERDON**

5-10-95

DT/4

N/U

4-20-04

DT/4

N/U

7-14-10

DT/4

NV-cycle



Marion County
OREGON
ASSESSOR'S OFFICE

Appraiser Sales Verification From

Primary Acct: 132205
MTL: 062W31D001100
MaSaNh/P.Class: 1305000/019
Appraiser: THERESA SWEARINGEN
MS Acct: 132205

Date Printed: 5/19/2025

Situs: 5135 COPPER CREEK LOOP NE # 68 SALEM, OR 97305

Grantor:
ROLLING ON LLC

Grantee:
BARAJAS, ANNALILIA

Sale ID: 34026
Deed: 34026
Accts In Sale: 1
Sale Date: 3/20/2025
Sale Price: 75,000
Condition Code: 00

Tax Statement RMV
Land & OSD: 0
Imp: 53,690
Total: 53,690
Ratio (Cert. Total RMV/Sale Price): 72

Attempt	Date/Time	Reason
1 st	2-26-25	LCB
2 nd		

Contact: _____ Phone/email: _____

1. Was the property listed on the open market? Days: _____ MLS: _____ Y N
2. Was property other than real estate included in the sale? Y N
Describe: _____ Est. \$: _____
3. Did the seller pay closing costs or make other concessions? \$ _____ Y N
4. Was the sale between related parties? (business or family) Y N
5. Was this a distressed sale? E.g. foreclosure, short, court order, etc... Y N
6. Condition at time of sale: | Poor | Fair | Avg. | Good | Exc. | Y N
Describe: _____

7. Have any improvements been made since the time of sale? Y N
If yes, describe: _____

Comments: _____

Appraiser: 02 Date: 6/16/25