

lk 7.24.25

Summary

Lead Appr: _____ Clerk: _____ Lead Clerk: _____ Appr: _____

Print Date: 5/19/2025

Acct ID: 130079

MTL: 072W29C000900P1

Date: 4/25/25 Appr: 02 ts 7-29-25

Prop Class: 019

RMV Prop Class: 019

Situs: 243 BROADMORE AVE NE SALEM, OR 97301

MaSaNh: 14 05 000

Unit: 142105

Year: 2025

Last Date Appraised: 09/28/2016

Appraiser: THERESA SWEARINGEN

Retag: Y N

Tag info:

Owner: MITCHELL, DIANE

Roll Type: MS

Cycle Tag Sales Verification Other: _____

Inspection level: 1 2 3 4 LCB TTO INSP

AV: 19770

RMV Land: 0

RMV Imp: 35840

RMV Total: 35840

MAV: 19770

MSAV: 0

SAV: 0

Comment: ROYAL MOBILE ESTATES, MS SERIAL # M046744E, X # X00183890, PERSONAL MS

Notations

No notation data available.

OSDs

No OSD data available.

Land

No land data available.

Improvements - Residence / Manufactured Structures

Bldg: 1

Code Area: 24622

Stat Class: 456

Year Blt: 1971

Eff Year Blt: 1971

Sq.Ft: 1152

% Complete: 100

Desc: MANUF STRUCT, CLASS 5, 24' WIDE DOUBLE

Dimensions: 48x24

RMV: 35840

Func Obsc: 100

Econ %: 100

Other %: 100

Exception: 0

Adjust:

Adjust RMV: 0

Floors

Type	Class	Display Group	Floor Size	Beds	Baths	Yr Blt	Eff Yr Blt	Inventory
First Floor	5	Finished	1152	2	FB-2	1971	1971	SKIRT, ROOF, HVAC+, KIT, BATH - 2
								Exception: Y N

Accessories

Description	Class	Size SqFt	Eff Yr Blt	RMV	Quantity	
DECK	5	152	1971	936	0	Exception: Y N
ROOF EXTENSION OR PATIO COVER	5	96	1971	780	0	Exception: Y N
ROOF EXTENSION OR PATIO COVER	5	240	1971	1949	0	Exception: Y N

Improvements - Accessory Buildings

No improvement data available for all other stat class types.



V. Wild
cm

BUILDING DIAGRAM AND OUTBUILDINGS

M130079

ACCT NO: M130079

MAP NO:

TAX LOT:

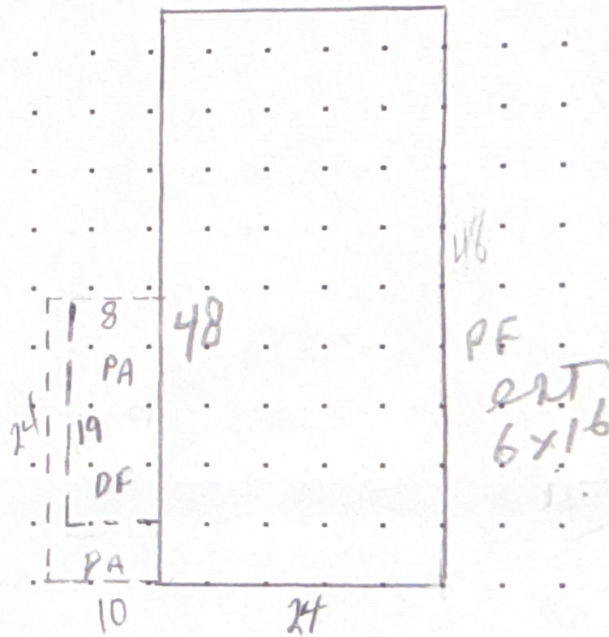

CALCULATIONS: $24 \times 48 = 1152 \text{ SF.}$

SCALE: 1" = 20'

Royal Mobile Estates

MEASUREMENT VERIFIED		YR BLT:	ADDRESS:	SALES	
DATE	BY			Date	Amt.
8-16-85	65	71	243 Broadmore Ave		
6-24-94	DT/4	REMARKS:	BUILDER: SKYLINE Hornette		
6-24-04	28	N.V.			
4-27-09	DT/4	NV			



Marion County
OREGON
ASSESSOR'S OFFICE

Appraiser Sales Verification From

Primary Acct: 130079
MTL: 072W29C000900
MaSaNh/P.Class: 1405000/019
Appraiser: THERESA SWEARINGEN
MS Acct: 130079

Date Printed: 5/19/2025

Situs: 243 BROADMORE AVE NE SALEM, OR 97301

Grantor: ACF VI HOMES LLC
Grantee: MITCHELL, DIANE

Sale ID: 33009
Deed: 33009
Accts In Sale: 1
Sale Date: 1/16/2025
Sale Price: 12,900
Condition Code: 00
Tax Statement RMV
Land & OSD: 0
Imp: 41,470
Total: 41,470
Ratio (Cert. Total RMV/Sale Price): 321

Attempt	Date/Time	Reason
1 st	6/25/25 12:00	LCB
2 nd		

Contact: _____ Phone/email: _____

1. Was the property listed on the open market? Days: _____ MLS: _____ Y N
2. Was property other than real estate included in the sale? Y N
Describe: _____ Est. \$: _____
3. Did the seller pay closing costs or make other concessions? \$ _____ Y N
4. Was the sale between related parties? (business or family) Y N
5. Was this a distressed sale? E.g. foreclosure, short, court order, etc... Y N
6. Condition at time of sale: | Poor | Fair | Avg. | Good | Exc. | Y N
Describe: _____

7. Have any improvements been made since the time of sale? Y N
If yes, describe: _____

Comments: _____

Appraiser: 02 Date: 7/7/25