

Summary Lead Appr: WW Clerk: _____ Lead Clerk: _____ Appr: MDL Input Print Date: 1/25/2024

Acct ID: 536682 MTL: 093W35CA01800 Date: 3/20/25 Appr: MDL Prop Class: 459 RMV Prop Class: 459
 Situs: 14586 HELEN ST SE JEFFERSON OR 97352 MaSaNh: 07 06 000 Unit: 56901 Year: 2024
 Last Date Appraised: 08/23/2018 Appraiser: MATT LORD Retag: Y (N) Tag info: 2025
 Owner: WILD, GARY & WILD, LINDA Roll Type: R
 Cycle Tag Sales Verification Other: _____ Inspection level: 1 2 (3) 4 LCB TTO INSP AV: 260110
 RMV Land: 267900 RMV Imp: 146390 RMV Total: 414290 MAV: 260110 MSAV: 0 SAV: 0
 Comment:

Notations 25-26 cycle

No notation data available.

OSDs

| Count | Code | Description | RMV | Code Area | Exception |
|-------|------|---------------|-------|-----------|-----------|
| 1 | MKTA | OSD - AVERAGE | 45000 | 14530 | 0 |

Land

| | | | | | | |
|--|---------------------------------|----------------------------|---------------|--------------|-------------|----------------|
| Site: 1 | Code Area: 14530 | Size: 3.14 Acres | Use Code: 005 | Zone: REST | SAV Use: | Exception: 0 |
| Class: 6H | Value Source: Rural Restrictive | Description: SIX HILL | | | RMV: 182020 | Exception: Y N |
| Adjustment(s): FSOIL | | Fire Patrol: | | Description: | | |
| Comments: 03-04: REAPPRAISAL /04-05: LAND ADJUSTMENT FOR RECALCULATION DONE BY #29 ON 5-4-04 | | | | | | |
| Site: 2 | Code Area: 14530 | Size: 0.67 Acres | Use Code: 005 | Zone: REST | SAV Use: | Exception: 0 |
| Class: 4HD | Value Source: Rural Restrictive | Description: FOUR HILL DRY | | | RMV: 40880 | Exception: Y N |
| Adjustment(s): FSOIL | | Fire Patrol: | | Description: | | |
| Comments: 03-04: REAPPRAISAL /04-05: LAND ADJUSTMENT FOR RECALCULATION DONE BY #29 ON 5-4-04 | | | | | | |

Improvements - Residence / Manufactured Structures

| | | | | | | |
|-------------------------|------------------|-----------------|--------------|--------------------|---------------|-----------------|
| Bldg: 2 | Code Area: 14530 | Stat Class: 107 | Year Blt: | Eff Year Blt: 1997 | Sq.Ft: 0 | % Complete: 100 |
| Desc: Yard Improvements | | | Dimensions: | | RMV: 24270 | |
| Func Obsc: 100 | Econ %: 100 | Other %: 100 | Exception: 0 | Adjust: | Adjust RMV: 0 | |

Floors

| Type | Class | Display Group | Floor Size | Beds | Baths | Yr Blt | Eff Yr Blt | Inventory |
|------|-------|---------------|------------|------|-------|--------|------------|-----------|
|------|-------|---------------|------------|------|-------|--------|------------|-----------|

No floor data available

Accessories

| Description | Class | Size SqFt | Eff Yr Blt | RMV | Quantity |
|------------------------|-------|-----------|------------|-------|----------|
| YARD IMPROVEMENTS GOOD | 3 | 1 | 1997 | 24273 | 1 |

| | | | | | | |
|------------------------------|------------------|-----------------|----------------|--------------------|---------------|-----------------|
| Bldg: 3 | Code Area: 14530 | Stat Class: 138 | Year Blt: 1997 | Eff Year Blt: 1997 | Sq.Ft: 0 | % Complete: 100 |
| Desc: Res other improvements | | | Dimensions: | | RMV: 29560 | |
| Func Obsc: 100 | Econ %: 100 | Other %: 100 | Exception: 0 | Adjust: | Adjust RMV: 0 | |

Floors

| Type | Class | Display Group | Floor Size | Beds | Baths | Yr Blt | Eff Yr Blt | Inventory |
|-----------------|-------|---------------|------------|------|-------|--------|------------|-----------|
| Garage Attached | 3 | Unfinished | 484 | 0 | 0 | 1997 | 1997 | ROOF |

Accessories

| Description | Class | Size SqFt | Eff Yr Blt | RMV | Quantity |
|-------------|-------|-----------|------------|-----|----------|
|-------------|-------|-----------|------------|-----|----------|

No accessory data available

| | | | | | | |
|---|------------------|-----------------|----------------|--------------------|---------------|-----------------|
| Bldg: 4 | Code Area: 14530 | Stat Class: 478 | Year Blt: 1997 | Eff Year Blt: 1997 | Sq.Ft: 2080 | % Complete: 100 |
| Desc: MANUF STRUCT, CLASS 7, 36' WIDE TRIPLE/QUAD | | | Dimensions: | | RMV: 92560 | |
| Func Obsc: 100 | Econ %: 100 | Other %: 100 | Exception: 0 | Adjust: | Adjust RMV: 0 | |

Floors

| Type | Class | Display Group | Floor Size | Beds | Baths | Yr Blt | Eff Yr Blt | Inventory |
|-------------|-------|---------------|------------|------|-------|--------|------------|------------------------------------|
| First Floor | 7 | Finished | 2080 | 2 | FB-2 | 1997 | 1997 | KIT-, HVAC+, SKRT+, ROOF, BATH - 2 |

Accessories

| Description | Class | Size SqFt | Eff Yr Blt | RMV | Quantity |
|-------------|-------|-----------|------------|-----|----------|
|-------------|-------|-----------|------------|-----|----------|

No accessory data available

Improvements - Accessory Buildings

No improvement data available for all other stat class types.

SKETCH/AREA TABLE ADDENDUM

SUBJECT INFO

File No.: 536682 Parcel No.: 093W35CA01800
 Property Address: 14586 HELEN ST SE
 City: JEFFERSON County: MARION State: OR ZipCode: 97352
 Owner:
 Client: Client Address:
 Appraiser Name: Inspection Date:

SKETCH

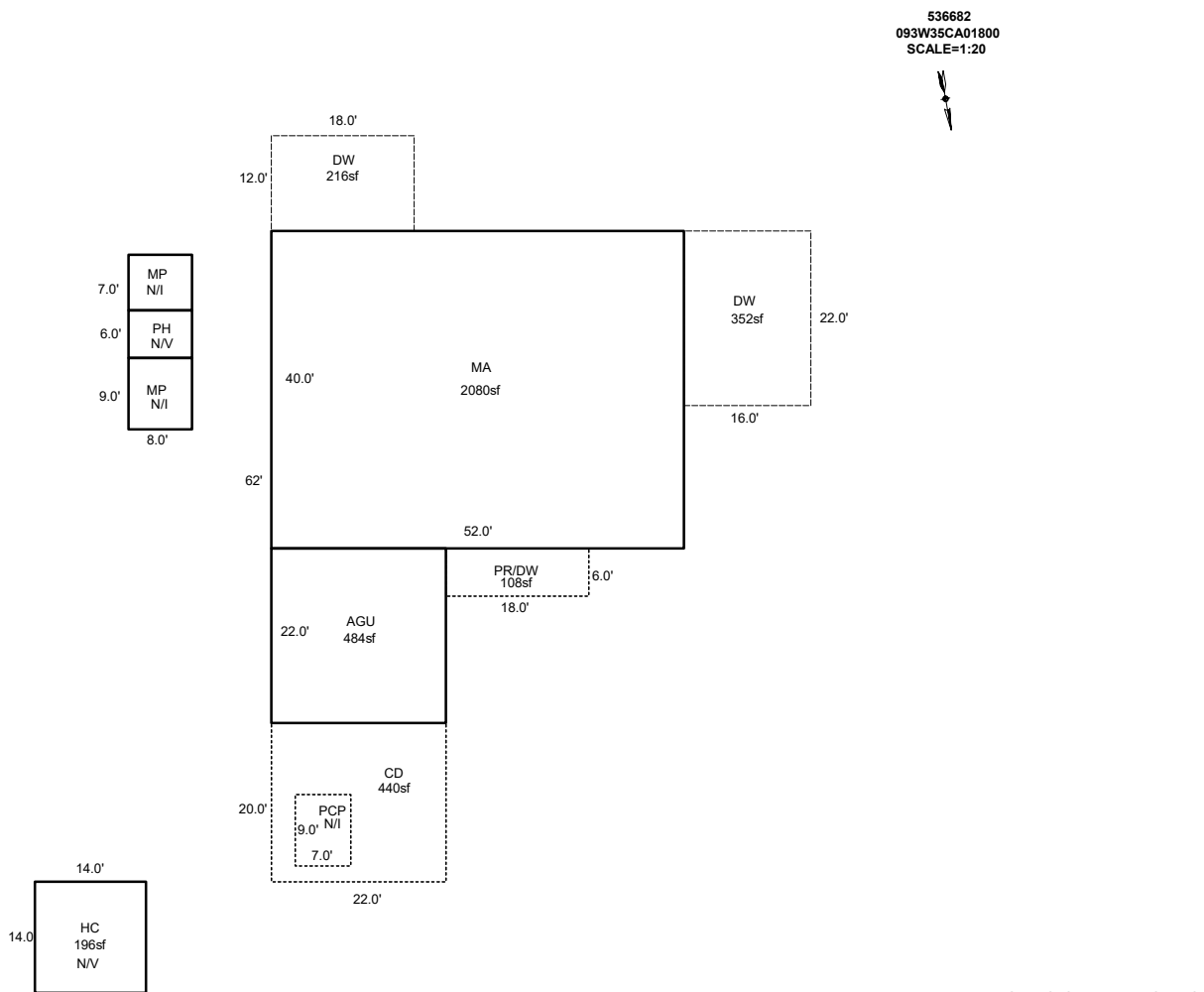

Sketch by ApexSketch

| AREA CALCULATIONS SUMMARY | | | | | | COMMENT TABLE 1 | | | |
|---|-----------------|--------|----------|-----------|------------|---|-----------------|--------------|----------|
| Code | Description | Factor | Net Size | Perimeter | Net Totals | | | | |
| GBA1 | HC | 1.0 | 196.0 | 56.0 | 196.0 | DRAWN BY SH 8-21-08 UPDATED BY JRONDEMA 9/11/18 UPDATED BY CLOBERG 07/24/25 | | | |
| GLA1 | MA | 1.0 | 2080.0 | 184.0 | 2080.0 | | | | |
| GAR | AGU | 1.0 | 484.0 | 88.0 | 484.0 | | | | |
| P/P | DW | 1.0 | 216.0 | 60.0 | | | | | |
| | DW | 1.0 | 352.0 | 76.0 | | | | | |
| | PR/DW | 1.0 | 108.0 | 48.0 | | | | | |
| | CD | 1.0 | 440.0 | 84.0 | 1116.0 | | | | |
| <div style="display: flex; justify-content: space-between;"> <div style="width: 45%;"> <p>Net LIVABLE cnt 0 (rounded) 2,080</p> <p>Net BUILDING cnt 1 (rounded) 196</p> </div> <div style="width: 45%; border-left: 1px solid black; padding-left: 5px;"> <table border="1" style="width: 100%; border-collapse: collapse;"> <thead> <tr style="background-color: #cccccc;"> <th style="text-align: left;">COMMENT TABLE 2</th> <th style="text-align: left;">COMMENT TABLE 3</th> </tr> </thead> <tbody> <tr> <td style="padding: 5px;">MDL 03/20/25</td> <td style="padding: 5px;">CYCLE L3</td> </tr> </tbody> </table> </div> </div> | | | | | | COMMENT TABLE 2 | COMMENT TABLE 3 | MDL 03/20/25 | CYCLE L3 |
| COMMENT TABLE 2 | COMMENT TABLE 3 | | | | | | | | |
| MDL 03/20/25 | CYCLE L3 | | | | | | | | |

SCALE=1:20



| | |
|----|-----------|
| 7' | MP N/I |
| 6' | PH N/V |
| 9' | MP N/I |
| 8' | |

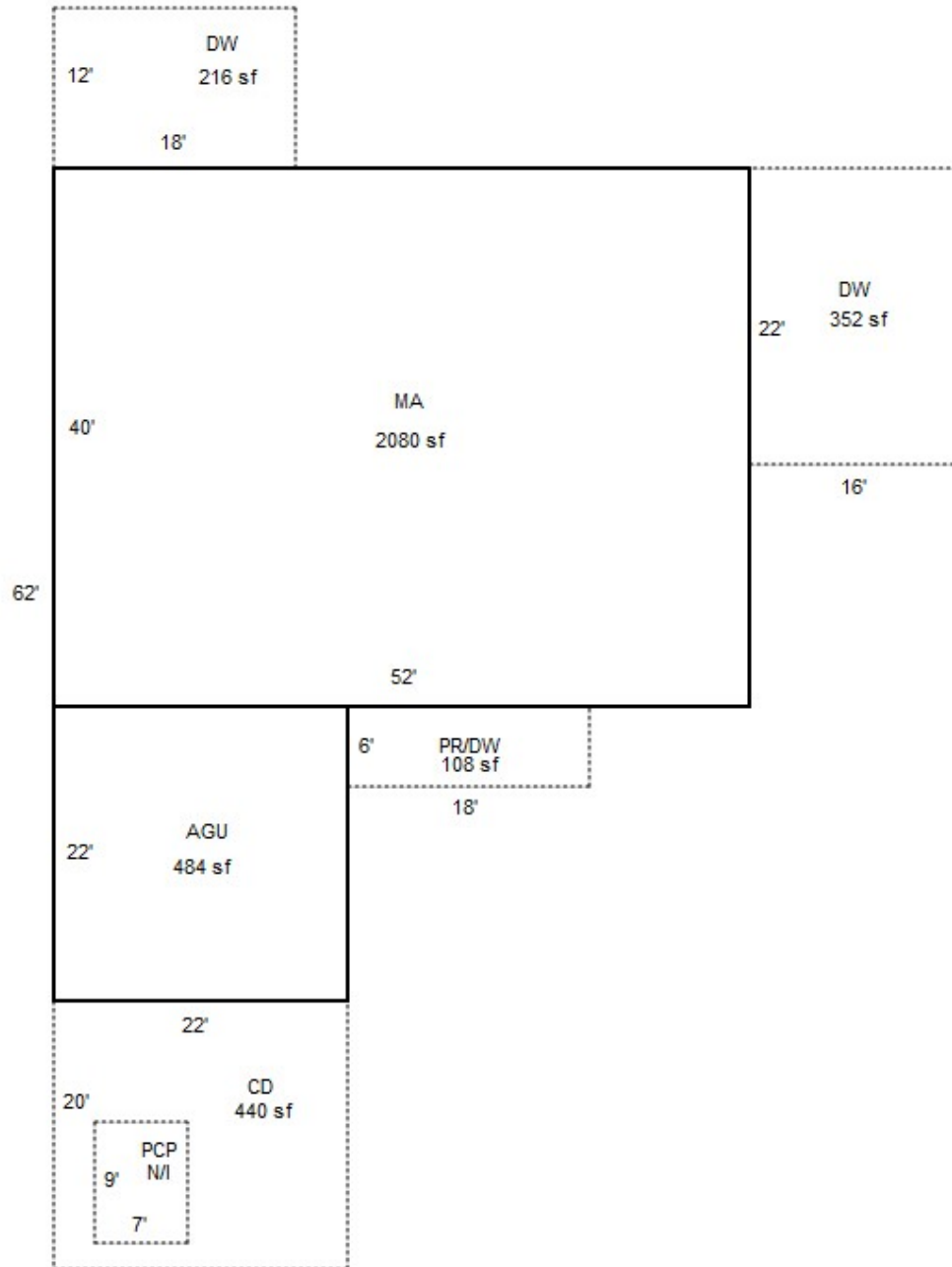

14 p/v
HC 14

R36682
093W35CA01800

