

Acct ID: 528741 MTL: 081W30D001300 Date: **5/30/25** Appr: **MLH** Prop Class: 551 RMV Prop Class: **551451**  
 Situs: 10241 LEVERMAN RD SE AUMSVILLE OR 97325 MaSaNh: 07 06 000 Unit: 95523 Year: 2025

Last Date Appraised: 08/28/2013 Appraiser: MATT LORD Retag: Y N Tag info:  
 Owner: PEREZ TR Roll Type: R  
 Cycle Tag Sales Verification Other: **Clean up** Inspection level: 1 2 3 **4** LCB TTO INSP AV: 238973  
 RMV Land: 401630 RMV Imp: 485383 RMV Total: 887013 MAV: 206980 MSAV: 31993 SAV: 55368  
 Comment:

**Notations** **update Inventory** **Input MLH 7/10/25**  
**Farm Livestock**

RP/MS	Code	Description	RMV	Code Area	Exception
RP	ZONED	FARM EFU ZONED			

**Land**  
 Site: 1 Code Area: 05558 Size: 1.00 Acres Use Code: 005 Zone: REST SAV Use: 011 Exception: 0  
 Class: 2BDS Value Source: Farm Homesite Description: TWO BENCH DRY SOUTH SPECIAL RMV: 26810 Exception: Y N  
 Adjustment(s): GSOIL Fire Patrol: Description:  
 Comments: Liability year - 2009 / //09-10: GW39 changed land type per Excel analysis//00-01: UPDATE OF MKT VALUE /02-03: REAPPRAISAL

Site: 2 Code Area: 05558 Size: 3.90 Acres Use Code: 005 Zone: REST SAV Use: 011 Exception: 0  
 Class: 2BDS Value Source: Farm Use - EFU Description: TWO BENCH DRY SOUTH SPECIAL RMV: 104540 Exception: Y N  
 Adjustment(s): GSOIL Fire Patrol: Description:  
 Comments: Liability year - 1981 / 00-01: UPDATE OF MKT VALUE

Site: 3 Code Area: 05558 Size: 9.45 Acres Use Code: 005 Zone: REST SAV Use: 011 Exception: 0  
 Class: 4BDS Value Source: Farm Use - EFU Description: FOUR BENCH DRY SPECIAL SOUTH RMV: 230280 Exception: Y N  
 Adjustment(s): GSOIL Fire Patrol: Description:  
 Comments: Liability year - 1982 / 00-01: UPDATE OF MKT VALUE

**Improvements - Residence / Manufactured Structures**  
 Bldg: 1 Code Area: 05558 Stat Class: 142 - Year Blt: 1948 Eff Year Blt: 1996 Sq.Ft: 2903 % Complete: 100  
 Desc: Multi Story above grade Dimensions: RMV: 437840  
 Func Obsc: 100 Econ %: 100 Other %: 100 Exception: 0 Adjust: Adjust RMV: 0 **I/O**

**Floors**

Type	Class	Display Group	Floor Size	Beds	Baths	Yr Blt	Eff Yr Blt	Inventory	Exception
First Floor	4 -	Finished	1770	3	FB-2	1948	1996	ROOF, HVAC, KIT-, BATH - 2	Y N
Second Floor	4 -	Finished	655	2	FB-1	2002	1996	HVAC, BATH - 1	Y N
<b>Attic</b>	4 -	Finished	478	0	FB-1	2005	2005	BATH - 1	Y N
Garage Attached	4	Finished	360	0	0	1948	1996	ROOF	Y N
Garage Attached	4	Finished	598	0	0	2005	2005	ROOF	Y N

**Accessories**  
 Description: No accessory data available **YI 4 A**  
 Class: Size SqFt: Eff Yr Blt: RMV: Quantity:

**Improvements - Accessory Buildings**  
 Bldg: 2 Code Area: 05558 Stat Class: 351 Year Blt: 1995 Eff Year Blt: **1984** Sq.Ft: 1250 % Complete: 100  
 Desc: General Purpose Building (GB) Dimensions: 50x25 RMV: 11319  
 Func Obsc: 100 Econ %: 100 Other %: 100 Exception: 0 Adjust: Adjust RMV: 0 **I/O**

**Floors**

Type	Class	Display Group	Floor Size	Beds	Baths	Yr Blt	Eff Yr Blt	Inventory	Exception
General Purpose Bldg	5	Finished	1250	0	0	1995	1995	FAIR	Y N

**Accessories**  
 Description: No accessory data available  
 Class: Size SqFt: Eff Yr Blt: RMV: Quantity:

Bldg: 3 Code Area: 05558 Stat Class: 341 Year Blt: Eff Year Blt: Sq.Ft: 0 % Complete: 100

Desc: Multi Purpose Shed (MP)				Dimensions: 34x14		RMV: 0		
Func Obsc: 0		Econ %: 100	Other %: 100	Exception: 0		Adjust:	Adjust RMV: 0	
<b>Floors</b>								
<b>Type</b>	<b>Class</b>	<b>Display Group</b>	<b>Floor Size</b>	<b>Beds</b>	<b>Baths</b>	<b>Yr Blt</b>	<b>Eff Yr Blt</b>	<b>Inventory</b>
Multi-Purpose Bldg	5	Finished	0	0	0	0	0	FAIR
								Exception: Y N

N/C

<b>Accessories</b>							
<b>Description</b>	<b>Class</b>	<b>Size SqFt</b>	<b>Eff Yr Blt</b>	<b>RMV</b>	<b>Quantity</b>		
No accessory data available							

Bldg: 4	Code Area: 05558	Stat Class: 312	Year Blt:	Eff Year Blt:	Sq.Ft: 0	% Complete: 100	
Desc: Loft Barn (LB)				Dimensions: 38x32		RMV: 0	
Func Obsc: 0		Econ %: 100	Other %: 100	Exception: 0		Adjust:	Adjust RMV: 0

N/C

<b>Floors</b>								
<b>Type</b>	<b>Class</b>	<b>Display Group</b>	<b>Floor Size</b>	<b>Beds</b>	<b>Baths</b>	<b>Yr Blt</b>	<b>Eff Yr Blt</b>	<b>Inventory</b>
Loft Barn	4	Finished	0	0	0	0	0	FAIR
								Exception: Y N

<b>Accessories</b>							
<b>Description</b>	<b>Class</b>	<b>Size SqFt</b>	<b>Eff Yr Blt</b>	<b>RMV</b>	<b>Quantity</b>		
No accessory data available							

Bldg: 5	Code Area: 05558	Stat Class: 301	Year Blt:	Eff Year Blt:	Sq.Ft: 0	% Complete: 100	
Desc: Accessory Improvements & Misc.				Dimensions: 0x0		RMV: 0	
Func Obsc: 100		Econ %: 100	Other %: 100	Exception: 0		Adjust:	Adjust RMV: 0

I/O

<b>Floors</b>								
<b>Type</b>	<b>Class</b>	<b>Display Group</b>	<b>Floor Size</b>	<b>Beds</b>	<b>Baths</b>	<b>Yr Blt</b>	<b>Eff Yr Blt</b>	<b>Inventory</b>
Building Structure	0	Finished	0	0	0	0	0	FAIR
								Exception: Y N

<b>Accessories</b>							
<b>Description</b>	<b>Class</b>	<b>Size SqFt</b>	<b>Eff Yr Blt</b>	<b>RMV</b>	<b>Quantity</b>		
No accessory data available							

Bldg: 6	Code Area: 05558	Stat Class: 301	Year Blt:	Eff Year Blt:	Sq.Ft: 0	% Complete: 100	
Desc: Accessory Improvements & Misc.				Dimensions: 200x25		RMV: 0	
Func Obsc: 100		Econ %: 100	Other %: 100	Exception: 0		Adjust:	Adjust RMV: 0

I/O

<b>Floors</b>								
<b>Type</b>	<b>Class</b>	<b>Display Group</b>	<b>Floor Size</b>	<b>Beds</b>	<b>Baths</b>	<b>Yr Blt</b>	<b>Eff Yr Blt</b>	<b>Inventory</b>
Building Structure	0	Finished	0	0	0	0	0	FAIR
								Exception: Y N

<b>Accessories</b>							
<b>Description</b>	<b>Class</b>	<b>Size SqFt</b>	<b>Eff Yr Blt</b>	<b>RMV</b>	<b>Quantity</b>		
No accessory data available							

Bldg: 7	Code Area: 05558	Stat Class: 353	Year Blt: 2000	Eff Year Blt: 2000	Sq.Ft: 1728	% Complete: 100	
Desc: Machine Shed (MS)				Dimensions: 36x48		RMV: 13270	
Func Obsc: 100		Econ %: 100	Other %: 100	Exception: 0		Adjust:	Adjust RMV: 0

2009 M/M

56 M/M

<b>Floors</b>								
<b>Type</b>	<b>Class</b>	<b>Display Group</b>	<b>Floor Size</b>	<b>Beds</b>	<b>Baths</b>	<b>Yr Blt</b>	<b>Eff Yr Blt</b>	<b>Inventory</b>
Machine Shed	5	Finished	1728	0	0	2000	2000	FAIR
								Exception: Y N

FAIR I/O

<b>Accessories</b>							
<b>Description</b>	<b>Class</b>	<b>Size SqFt</b>	<b>Eff Yr Blt</b>	<b>RMV</b>	<b>Quantity</b>		
No accessory data available							

Bldg: 8	Code Area: 05558	Stat Class: 351	Year Blt: 2000	Eff Year Blt: 2000	Sq.Ft: 1656	% Complete: 100	
Desc: General Purpose Building (GB)				Dimensions: 36x46		RMV: 17949	
Func Obsc: 100		Econ %: 100	Other %: 100	Exception: 0		Adjust:	Adjust RMV: 0

N/C

<b>Floors</b>								
<b>Type</b>	<b>Class</b>	<b>Display Group</b>	<b>Floor Size</b>	<b>Beds</b>	<b>Baths</b>	<b>Yr Blt</b>	<b>Eff Yr Blt</b>	<b>Inventory</b>
General Purpose Bldg	5	Finished	1656	0	0	2000	2000	FAIR
								Exception: Y N

<b>Accessories</b>							
<b>Description</b>	<b>Class</b>	<b>Size SqFt</b>	<b>Eff Yr Blt</b>	<b>RMV</b>	<b>Quantity</b>		
No accessory data available							

Bldg: 9	Code Area: 05558	Stat Class: 353	Year Blt: 1991	Eff Year Blt: 1991	Sq.Ft: 432	% Complete: 100	
Desc: Machine Shed (MS)				Dimensions: 18x24		RMV: 2773	
Func Obsc: 100		Econ %: 100	Other %: 100	Exception: 0		Adjust:	Adjust RMV: 0

Gone

**Floors**

Type	Class	Display Group	Floor Size	Beds	Baths	Yr Blt	Eff Yr Blt	Inventory	Exception: Y N
Machine Shed	5	Finished	432	0	0	1991	1991	FAIR	

**Accessories**

Description	Class	Size SqFt	Eff Yr Blt	RMV	Quantity
No accessory data available					

Bldg: 10    Code Area: 05558    Stat Class: 321    Year Blt: 2010    Eff Year Blt: 2010    Sq.Ft: 392    % Complete: 100  
 Desc: Hay Cover (HC)    Dimensions: 14x28    RMV: 2232  
 Func Obsc: 100    Econ %: 100    Other %: 100    Exception: 0    Adjust:    Adjust RMV: 0

ID

**Floors**

Type	Class	Display Group	Floor Size	Beds	Baths	Yr Blt	Eff Yr Blt	Inventory	Exception: Y N
Hay Cover	5 4 ✓	Finished	392	0	0	2010	2010	FAIR	

**Accessories**

Description	Class	Size SqFt	Eff Yr Blt	RMV	Quantity
No accessory data available					

# SKETCH/AREA TABLE ADDENDUM

## SUBJECT INFO

File No.: 528741 Parcel No.: 081W30D 01300  
 Property Address: 10241 LEVERMAN RD SE  
 City: AUMSVILLE County: MARION State: OR ZipCode: 97325  
 Owner:  
 Client Address:  
 Appraiser Name: Inspection Date:

## SKETCH

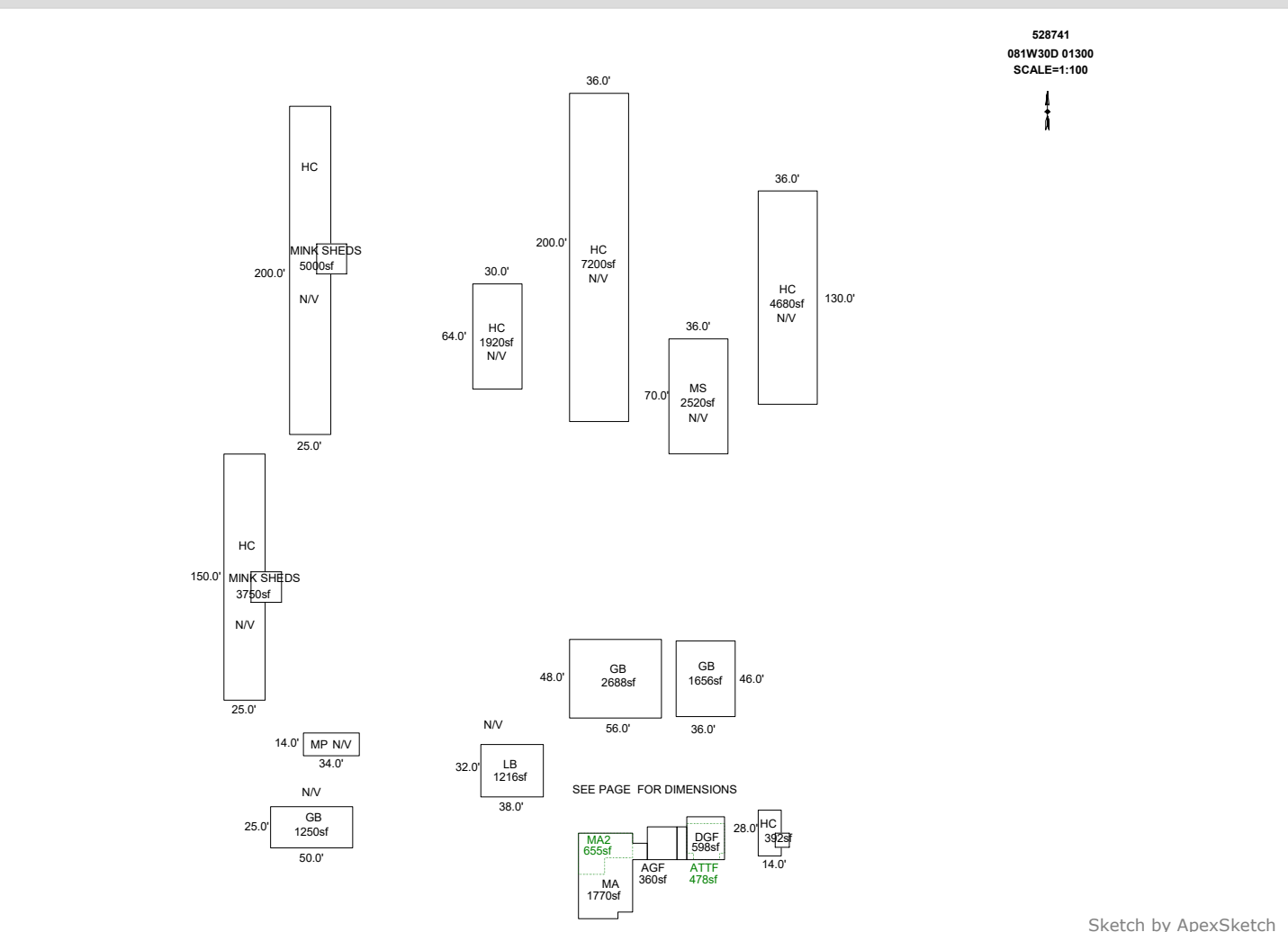

AREA CALCULATIONS SUMMARY						COMMENT TABLE 1	
Code	Description	Factor	Net Size	Perimeter	Net Totals		
GBA1	HC	1.0	4680.0	332.0		DRAWN BY JRONDEMA 2/6/18 UPDATED BY CLOBERG 07/09/25	
	HC	1.0	1920.0	188.0			
	HC	1.0	7200.0	472.0			
	GB	1.0	1250.0	150.0			
	HC	1.0	392.0	84.0			
	LB	1.0	1216.0	140.0			
	MS	1.0	2520.0	212.0			
	GB	1.0	1656.0	164.0			
	GB	1.0	2688.0	208.0	23522.0		
GLA1	MA	1.0	1770.0	188.0	1770.0	<b>COMMENT TABLE 2</b>	<b>COMMENT TABLE 3</b>
GLA2	MA2	1.0	655.0	116.0	655.0		
GAR	ATTF	1.0	478.0	90.0		MLH 05/30/25	
	DGF	1.0	598.0	98.0			
	AGF	1.0	360.0	76.0	1436.0		
OTH	HC	1.0	5000.0	450.0			
	HC	1.0	3750.0	350.0	8750.0		
	Net LIVABLE	cnt	0	(rounded)	2,425		
	Net BUILDING	cnt	9	(rounded)	23,522		

# SKETCH/AREA TABLE ADDENDUM

## SUBJECT INFO

File No.: 528741 Parcel No.: 081W30D 01300  
 Property Address: 10241 LEVERMAN RD SE  
 City: AUMSVILLE County: MARION State: OR ZipCode: 97325  
 Owner:  
 Client: Client Address:  
 Appraiser Name: Inspection Date:

## SKETCH

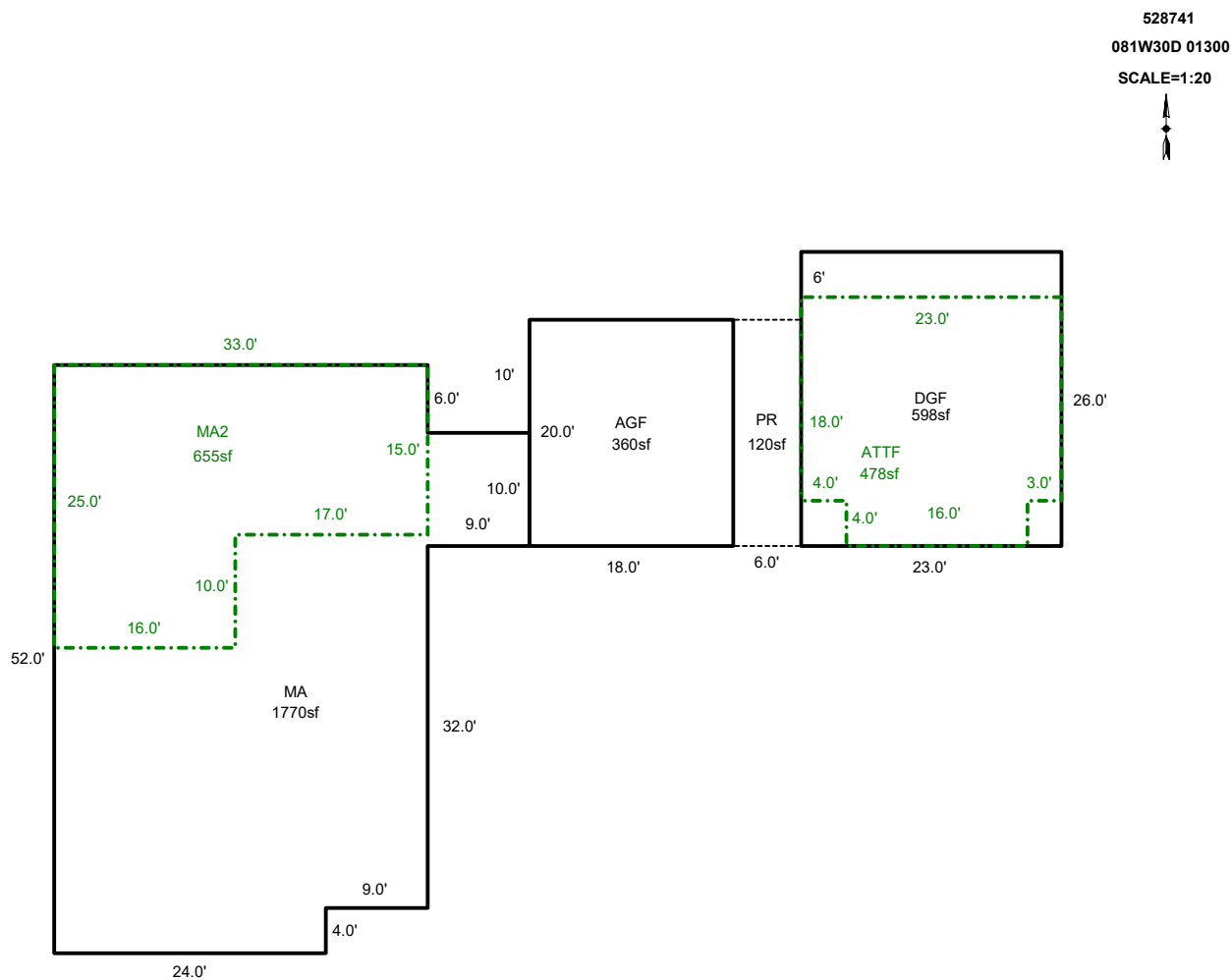

Sketch by ApexSketch

### AREA CALCULATIONS SUMMARY

Code	Description	Factor	Net Size	Perimeter	Net Totals
GLA1	MA	1.0	1770.0	188.0	1770.0
GLA2	MA2	1.0	655.0	116.0	655.0
GAR	AGF	1.0	360.0	76.0	
	DGF	1.0	598.0	98.0	
	ATTF	1.0	478.0	90.0	1436.0
P/P	PR	1.0	120.0	52.0	120.0

### COMMENT TABLE 1

DRAWN BY JRONDEMA 2/6/18  
 UPDATED BY CLOBERG 07/09/25

### COMMENT TABLE 2

MLH 05/30/25

### COMMENT TABLE 3

CLEAN UP L4

Net LIVABLE                      cnt                      0      (rounded)                      2,425

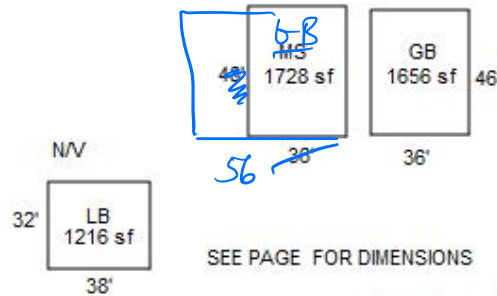
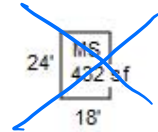
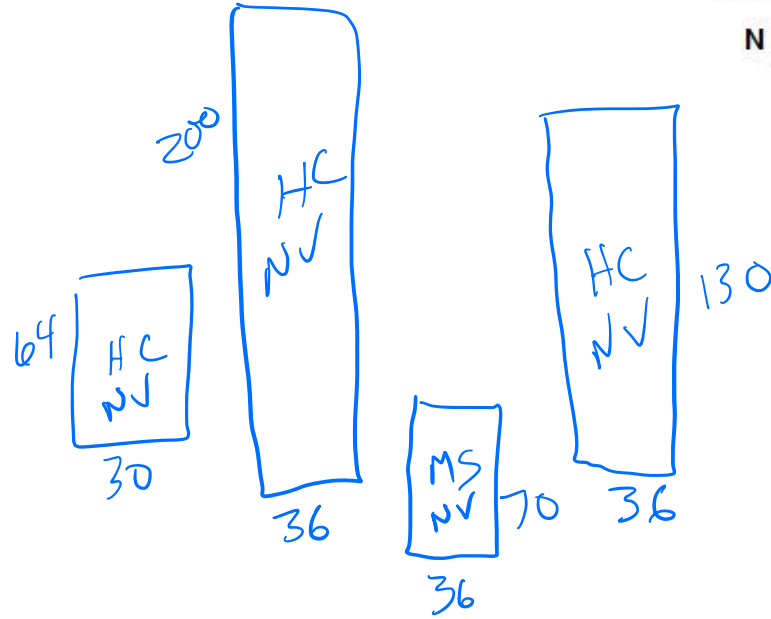
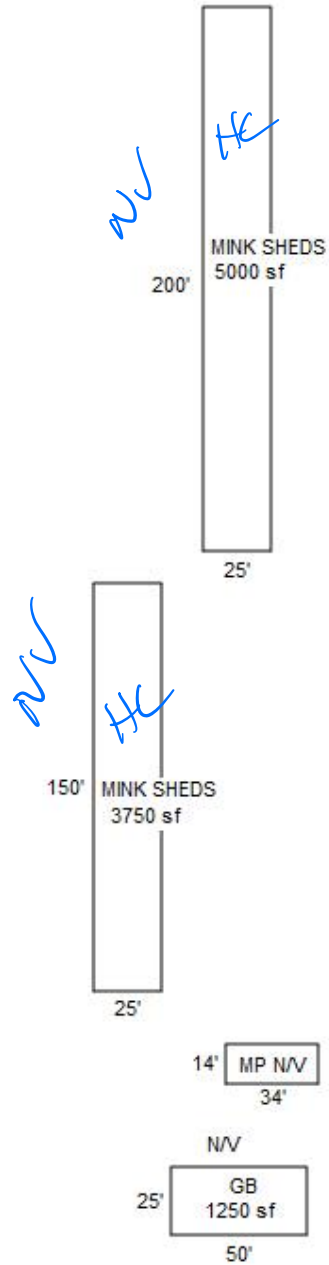
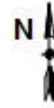

SEE PAGE FOR DIMENSIONS

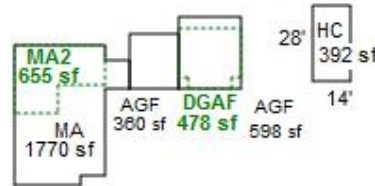

See next  
Page

5/30/25 MLH Cleanup 24

