

Acct ID: 530141 MTL: 082W210001200 Date: 6/25/25 Appr: MLH Prop Class: 451 RMV Prop Class: 451
 Situs: 6922 WITZEL RD SE SALEM OR 97317 MaSaNh: 07 06 000 Unit: 34061 Year: 2025

Last Date Appraised: 05/06/2015 Appraiser: MATT LORD Retag: Y N Tag info:
 Owner: CAROL S KEEFER RLT Roll Type: R
 Cycle Tag Sales Verification Other: Clean up Inspection level: 1 2 3 4 LCB TTO INSP AV: 375180
 RMV Land: 286160 RMV Imp: 624170 RMV Total: 910330 MAV: 375180 MSAV: 0 SAV: 0
 Comment:

Notations

No notation data available.

update Inventory

Input MLH 6/25/25

OSDs

| Count | Code | Description | RMV | Code Area | Exception |
|-------|------|-------------|-------|-----------|-----------|
| 2 | MKTG | OSD - GOOD | 60000 | 05598 | 0 |

Land

| | | | | | | |
|--|---------------------------------|------------------|---------------|--------------|-------------|----------------|
| Site: 1 | Code Area: 05598 | Size: 1.71 Acres | Use Code: 005 | Zone: REST | SAV Use: | Exception: 0 |
| Class: <u>48055</u> | Value Source: Rural Restrictive | Description: | | | RMV: 180720 | Exception: Y N |
| Adjustment(s): | | | Fire Patrol: | Description: | | |
| Comments: 2002-03 REAPPRAISAL. | | | | | | |
| Site: 2 | Code Area: 05590 | Size: 0.43 Acres | Use Code: 005 | Zone: REST | SAV Use: | Exception: 0 |
| Class: <u>48055</u> | Value Source: Rural Restrictive | Description: | | | RMV: 45440 | Exception: Y N |
| Adjustment(s): | | | Fire Patrol: | Description: | | |
| Comments: 15-16: CYCLE WORK #36 NO CHG//2002-03 REAPPRAISAL. | | | | | | |

Improvements - Residence / Manufactured Structures

| | | | | | | |
|-------------------------------|------------------|-------------------|----------------|--------------------|---------------|-----------------|
| Bldg: 1 | Code Area: 05598 | Stat Class: 152 + | Year Blt: 1981 | Eff Year Blt: 1981 | Sq.Ft: 3142 | % Complete: 100 |
| Desc: Multi Story above grade | | | Dimensions: | | RMV: 619170 | |
| Func Obsc: 100 | Econ %: 100 | Other %: 100 | Exception: 0 | Adjust: | Adjust RMV: 0 | <i>N/C</i> |

Floors

| Type | Class | Display Group | Floor Size | Beds | Baths | Yr Blt | Eff Yr Blt | Inventory | Exception |
|-----------------|-------|---------------|------------|------|---------------|--------|------------|------------------------------------|-----------|
| First Floor | 5 + | Finished | 1704 | 0 | FB-1/ HB-1 | 1981 | 1981 | ROOF+, FP - 1, HVAC+, KIT, BTH - 1 | Y N |
| Second Floor | 5 + | Finished | 1438 | 4 | FB-2 | 1981 | 1981 | HVAC+, BATH - 2 | Y N |
| Garage Attached | 5 | Finished | 512 | 0 | 0 | 1981 | 1981 | ROOF+ | Y N |

Accessories

| Description | Class | Size SqFt | Eff Yr Blt | RMV | Quantity | Exception |
|------------------------|-------|-----------|------------|-------|----------|-----------|
| YARD IMPROVEMENTS GOOD | 5 | 1 | 1981 | 44043 | 1 | Y N |

Improvements - Accessory Buildings

| | | | | | | |
|--------------------------------------|------------------|-----------------|--------------|---------------|---------------|-----------------|
| Bldg: 2 | Code Area: 05598 | Stat Class: 301 | Year Blt: | Eff Year Blt: | Sq.Ft: 0 | % Complete: 100 |
| Desc: Accessory Improvements & Misc. | | | Dimensions: | | RMV: 5000 | |
| Func Obsc: 100 | Econ %: 100 | Other %: 100 | Exception: 0 | Adjust: | Adjust RMV: 0 | |

Floors

| Type | Class | Display Group | Floor Size | Beds | Baths | Yr Blt | Eff Yr Blt | Inventory | Exception |
|--------------------|-------|---------------|------------|------|-------|--------|------------|-----------|-----------|
| Building Structure | 0 | Finished | 0 | 0 | 0 | 0 | 0 | | Y N |

Accessories

| Description | Class | Size SqFt | Eff Yr Blt | RMV | Quantity |
|-----------------------------|-------|-----------|------------|-----|----------|
| No accessory data available | | | | | |

Gate part of YI's move MAU

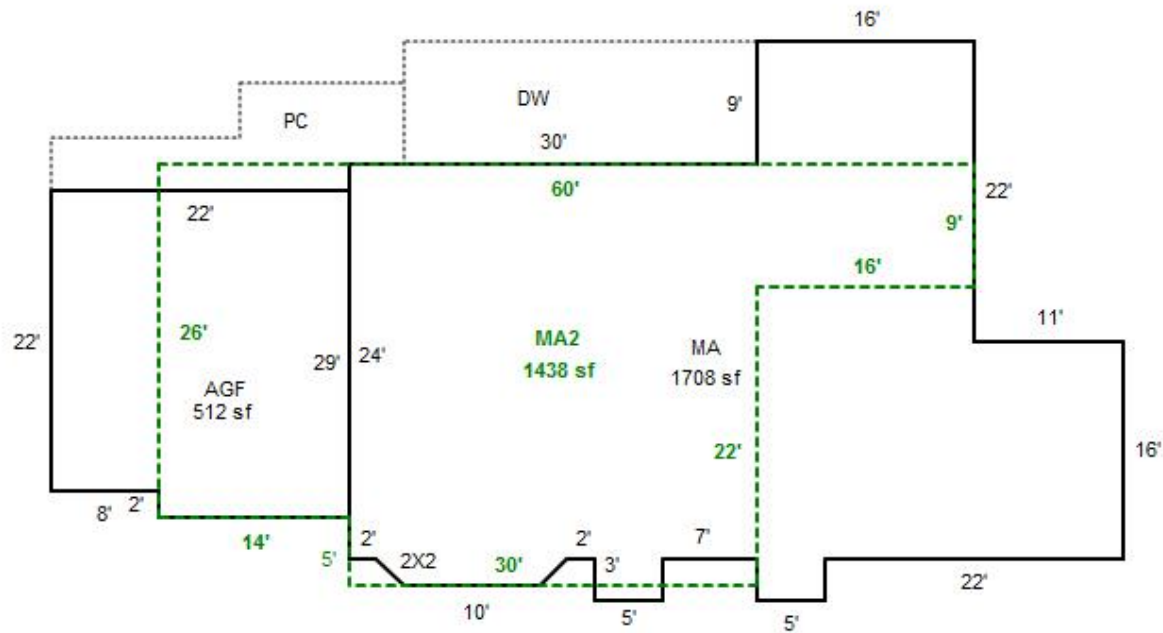

6/25/25 MLH clean up LY

