

SKETCH/AREA TABLE ADDENDUM

SUBJECT INFO

File No.: 129291 Parcel No.: 072W30DA00100
 Property Address: 4730 AUBURN RD NE #104
 City: SALEM County: State: OR ZipCode: 97301
 Owner:
 Client: Client Address:
 Appraiser Name: Inspection Date:

SKETCH

129291
072W30DA00100

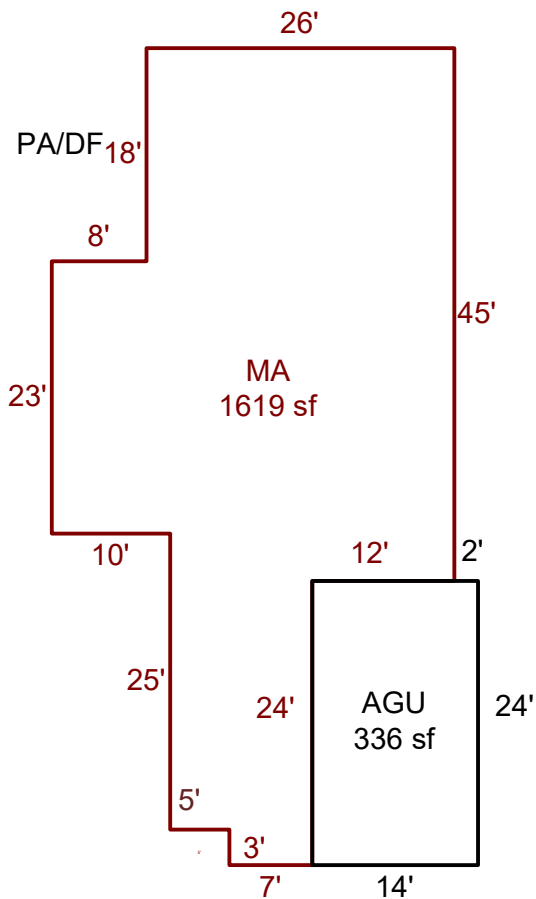

Sketch by ApexSketch

AREA CALCULATIONS SUMMARY

Code	Description	Factor	Net Size	Perimeter	Net Totals
GAR	AGU	1.0	336.0	76.0	336.0
MFH	MA	1.0	1619.0	206.0	1619.0

COMMENT TABLE 1

DRAWN BY LK 7.24.25

COMMENT TABLE 2

6.25.25 SV TS

COMMENT TABLE 3

Net LIVABLE cnt 1 (rounded) 1,619