

SKETCH/AREA TABLE ADDENDUM

SUBJECT INFO

File No.: 131029 Parcel No.: 083W23A002200
 Property Address: 2120 ROBINS LN SE #147
 City: SALEM County: State: OR ZipCode: 97306
 Owner:
 Client: Client Address:
 Appraiser Name: Inspection Date:

SKETCH

131029
083W23A002200

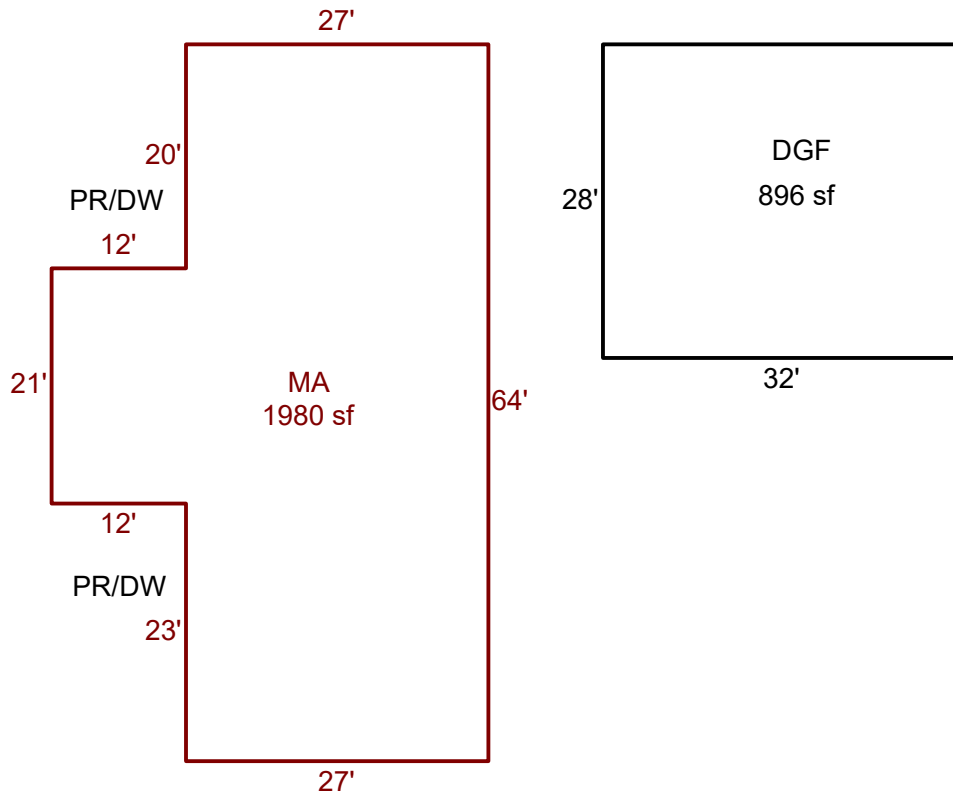

Sketch by ApexSketch

AREA CALCULATIONS SUMMARY						COMMENT TABLE 1	
Code	Description	Factor	Net Size	Perimeter	Net Totals	DRAWN BY LK 7.31.25	
GAR	DGF	1.0	896.0	120.0	896.0		
MFH	MA	1.0	1980.0	206.0	1980.0		
<div style="display: flex; justify-content: space-between; align-items: flex-end;"> Net LIVABLE cnt 1 (rounded) 1,980 </div>						COMMENT TABLE 2	COMMENT TABLE 3
						10.3.24 CYCLE ZH	