

SKETCH/AREA TABLE ADDENDUM

SUBJECT INFO

File No.: 131137 Parcel No.: 083W23D000100
 Property Address: 2120 ROBINS LN SE #209
 City: SALEM County: State: OR ZipCode: 97306
 Owner:
 Client: Client Address:
 Appraiser Name: Inspection Date:

SKETCH

131137
083W23D000100

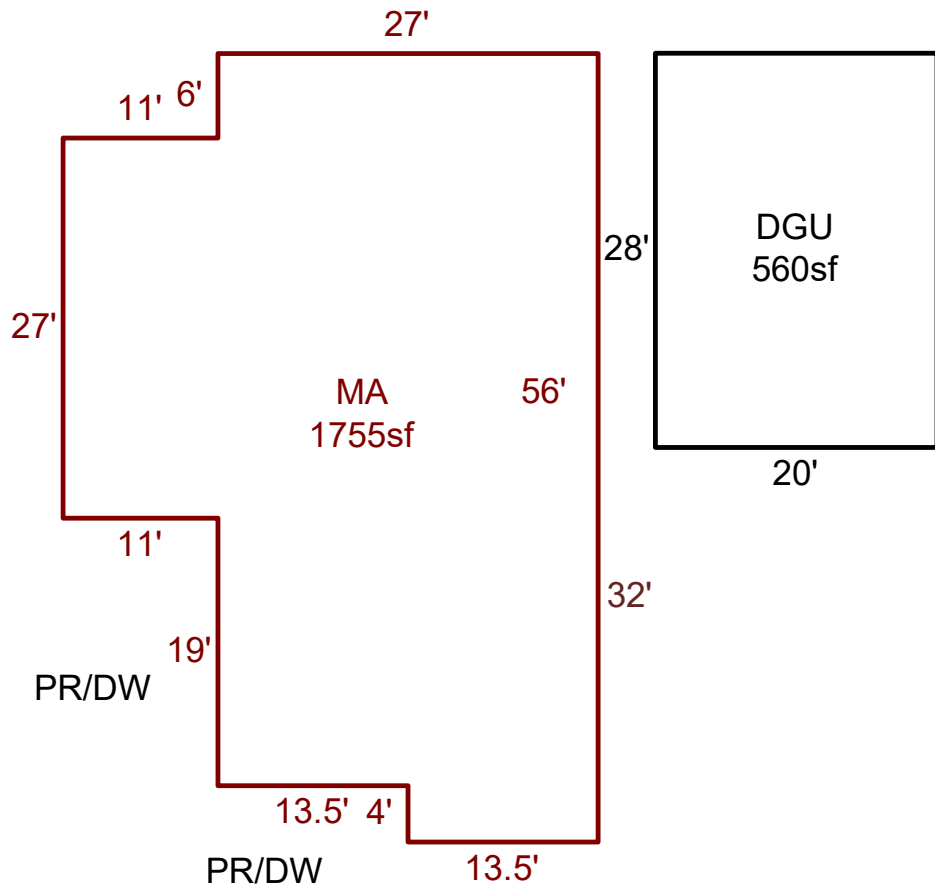

Sketch by ApexSketch

AREA CALCULATIONS SUMMARY

Code	Description	Factor	Net Size	Perimeter	Net Totals
GAR	DGU	1.0	560.0	96.0	560.0
MFH	MA	1.0	1755.0	188.0	1755.0

COMMENT TABLE 1

APEXED BY LK 8.6.25

COMMENT TABLE 2

7-3-24 SV TS

COMMENT TABLE 3

Net LIVABLE cnt 1 (rounded) 1,755