

SKETCH/AREA TABLE ADDENDUM

SUBJECT INFO

File No.: 131490 Parcel No.: 083W23D000100
 Property Address: 2120 ROBINS LN SE #217
 City: SALEM County: State: OR ZipCode: 97306
 Owner:
 Client: Client Address:
 Appraiser Name: Inspection Date:

SKETCH

131490
083W23D000100

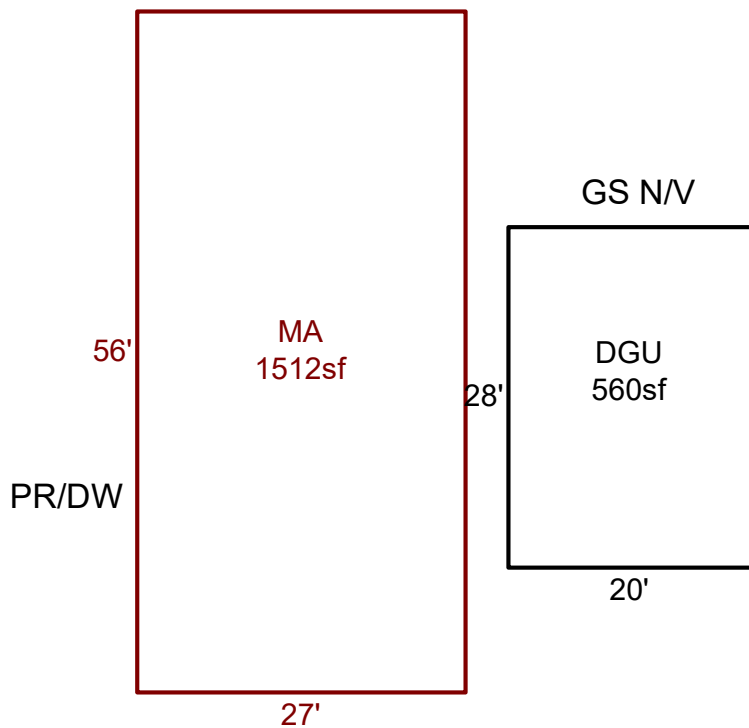

Sketch by ApexSketch

AREA CALCULATIONS SUMMARY

Code	Description	Factor	Net Size	Perimeter	Net Totals
GAR	DGU	1.0	560.0	96.0	560.0
MFH	MA	1.0	1512.0	166.0	1512.0

COMMENT TABLE 1

APEXED BY LK 8.6.25

COMMENT TABLE 2

10.3.24 CYCLE ZH

COMMENT TABLE 3

Net LIVABLE cnt 1 (rounded) 1,512