

SKETCH/AREA TABLE ADDENDUM

SUBJECT INFO

File No.: 132145 Parcel No.: 083W23A002200
 Property Address: 2120 ROBINS LN SE #32
 City: SALEM County: State: OR ZipCode: 97306
 Owner:
 Client: Client Address:
 Appraiser Name: Inspection Date:

SKETCH

132145
083W23A002200

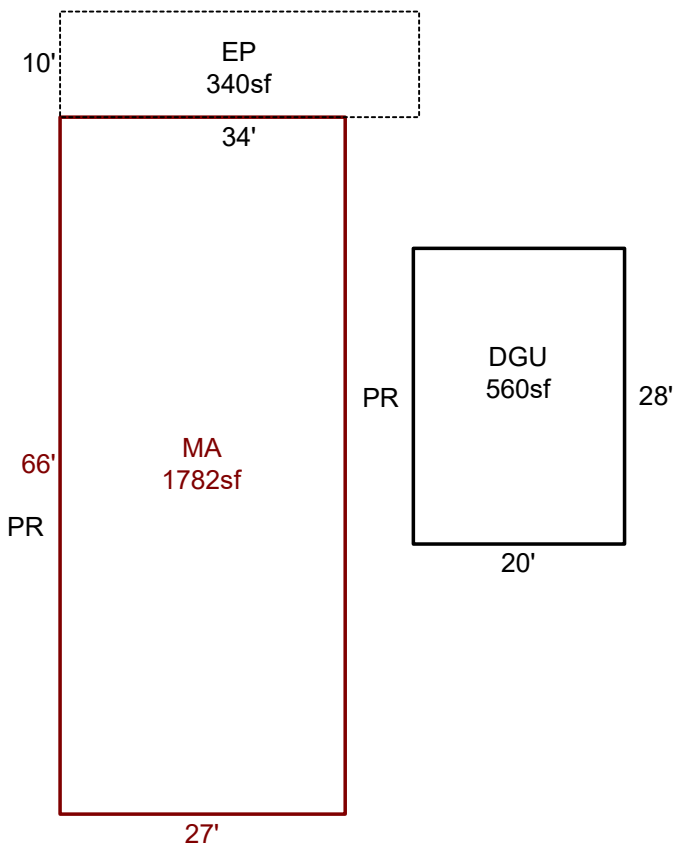

Sketch by ApexSketch

AREA CALCULATIONS SUMMARY

Code	Description	Factor	Net Size	Perimeter	Net Totals
GAR	DGU	1.0	560.0	96.0	560.0
MFH	MA	1.0	1782.0	186.0	1782.0
PR	EP	1.0	340.0	88.0	340.0

COMMENT TABLE 1

APEXED BY LK 8.7.25

COMMENT TABLE 2

10.3.24 CYCLE ZH

COMMENT TABLE 3

Net LIVABLE cnt 1 (rounded) 1,782