

SKETCH/AREA TABLE ADDENDUM

SUBJECT INFO

File No.: 132529 Parcel No.: 083W23A002200
 Property Address: 2120 ROBINS LN SE #175
 City: SALEM County: State: OR ZipCode: 97306
 Owner:
 Client: Client Address:
 Appraiser Name: Inspection Date:

SKETCH

132529
083W23A002200

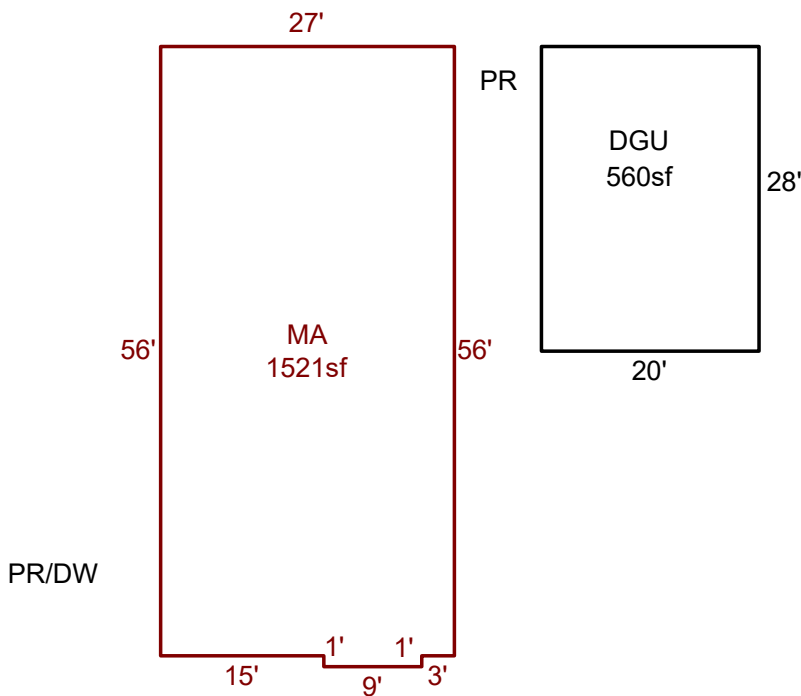

Sketch by ApexSketch

AREA CALCULATIONS SUMMARY						COMMENT TABLE 1	
Code	Description	Factor	Net Size	Perimeter	Net Totals		
GAR	DGU	1.0	560.0	96.0	560.0	APEXED BY LK 8.8.25	
MFH	MA	1.0	1521.0	168.0	1521.0		
						COMMENT TABLE 2	COMMENT TABLE 3
						10.3.24 CYCLE ZH	
Net LIVABLE		cnt	1	(rounded)	1,521		