

SKETCH/AREA TABLE ADDENDUM

SUBJECT INFO

File No.: 132532 Parcel No.: 083W23A002200
 Property Address: 2120 ROBINS LN SE #127
 City: SALEM County: State: OR ZipCode: 97306
 Owner:
 Client: Client Address:
 Appraiser Name: Inspection Date:

SKETCH

132532
083W23A002200

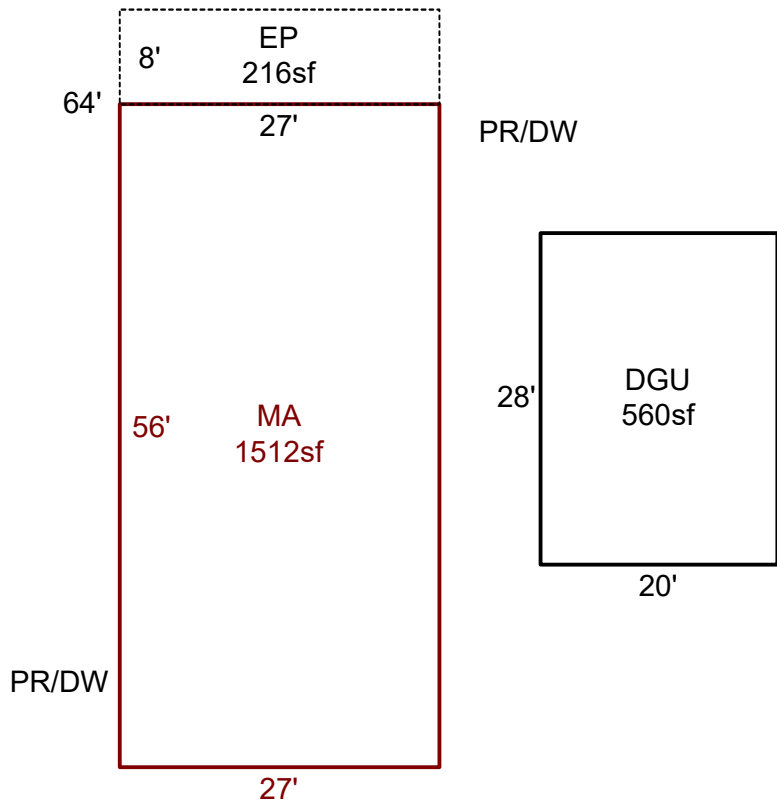

Sketch by ApexSketch

AREA CALCULATIONS SUMMARY						COMMENT TABLE 1	
Code	Description	Factor	Net Size	Perimeter	Net Totals		
GAR	DGU	1.0	560.0	96.0	560.0	APEXED BY LK 8.8.25	
MFH	MA	1.0	1512.0	166.0	1512.0		
PR	EP	1.0	216.0	70.0	216.0		
Net LIVABLE		cnt	1 (rounded)		1,512	COMMENT TABLE 2	COMMENT TABLE 3
						10.3.24 CYCLE ZH	