

# SKETCH/AREA TABLE ADDENDUM

## SUBJECT INFO

File No.: 132627 Parcel No.: 083W23A002200  
 Property Address: 2120 ROBINS LN SE #36  
 City: SALEM County: State: OR ZipCode: 97306  
 Owner:  
 Client: Client Address:  
 Appraiser Name: Inspection Date:

## SKETCH

**132627**  
**083W23A002200**

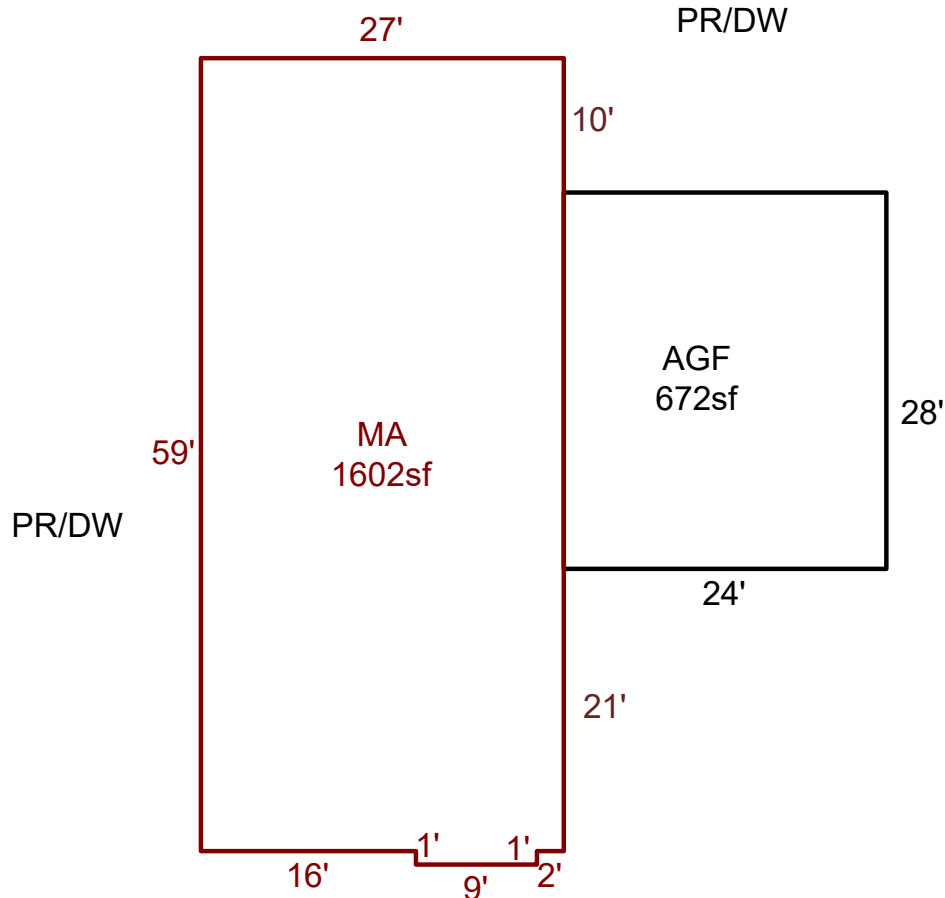

Sketch by ApexSketch

### AREA CALCULATIONS SUMMARY

Code	Description	Factor	Net Size	Perimeter	Net Totals
GAR	AGF	1.0	672.0	104.0	672.0
MFH	MA	1.0	1602.0	174.0	1602.0

### COMMENT TABLE 1

APEXED BY LK 8.8.25

### COMMENT TABLE 2

10.3.24 CYCLE ZH

### COMMENT TABLE 3

Net LIVABLE                      cnt                      1      (rounded)                      1,602