

SKETCH/AREA TABLE ADDENDUM

SUBJECT INFO

File No.: 132628 Parcel No.: 083W23D000100
 Property Address: 2120 ROBINS LN SE #195
 City: SALEM County: State: OR ZipCode: 97306
 Owner:
 Client: Client Address:
 Appraiser Name: Inspection Date:

SKETCH

132628
083W23D000100

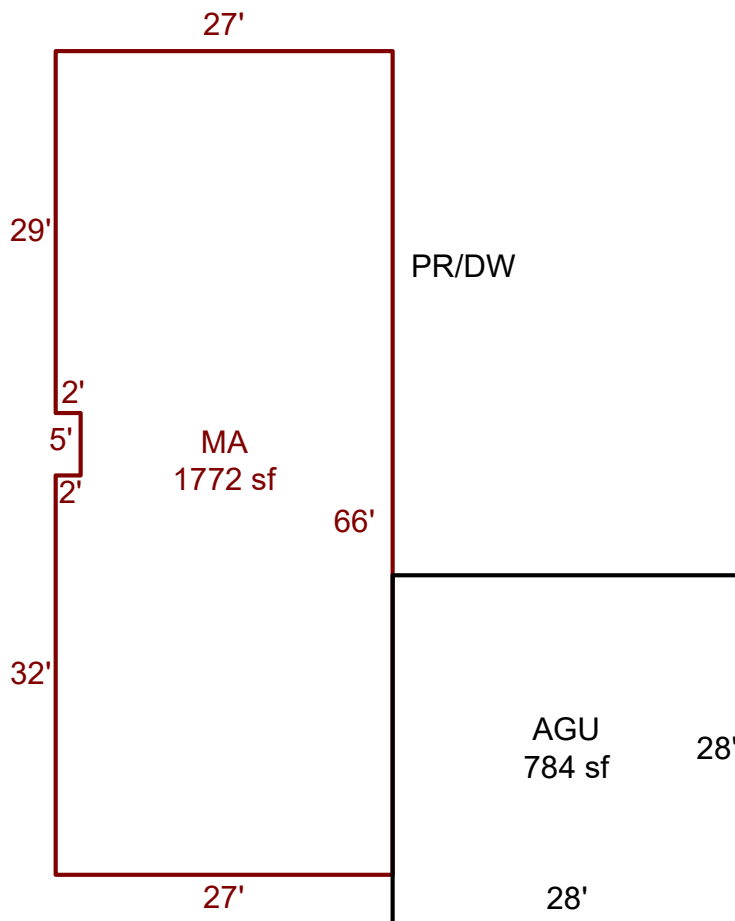

Sketch by ApexSketch

AREA CALCULATIONS SUMMARY

Code	Description	Factor	Net Size	Perimeter	Net Totals
GAR	AGU	1.0	784.0	112.0	784.0
MFH	MA	1.0	1772.0	190.0	1772.0

COMMENT TABLE 1

DRAWN BY LK 8.8.25

COMMENT TABLE 2

10.3.24 CYCLE ZH

COMMENT TABLE 3

Net LIVABLE cnt 1 (rounded) 1,772