

lak 8.29.25

Summary

Lead Appr: _____ Clerk: _____ Lead Clerk: _____ Appr: _____

Print Date: 8/4/2025

Acct ID: 336484

MTL: 082W06AC02600P62

Date: 8/19/25

Appr: 02

Prop Class: 019

RMV Prop Class: 019

Situs: 2200 LANCASTER DR SE # 13-B SALEM, OR 97317

MaSaNh: 17 05 000

Unit: 336484

Year: 2025

Last Date Appraised: 08/17/2016

Appraiser: THERESA SWEARINGEN

Retag: Y N

Tag info:

Owner: MARKS, SHARON

Roll Type: MS

Cycle Tag Sales Verification Other: _____

Inspection level: 1 2 3 4 LCB TTO INSP

AV: 47210

RMV Land: 0

RMV Imp: 123690

RMV Total: 123690

MAV: 47210

MSAV: 0

SAV: 0

Comment: SUNDIAL RANCH, SPACE #13-B, MS SERIAL # ORFL548AB30501BH13, Home ID 304857, PERSONAL MS

Notations

No notation data available.

OSDs

No OSD data available.

Land

No land data available.

Improvements - Residence / Manufactured Structures

Bldg: 1	Code Area: 24010	Stat Class: 457	Year Blt: 2005	Eff Year Blt: 2005	Sq.Ft: 1188	% Complete: 100
Desc: MANUF STRUCT, CLASS 5, 26' THROUGH 28' WIDE DOUBLE			Dimensions: 44x27		RMV: 123690	
Func Obsc: 100	Econ %: 100	Other %: 100	Exception: 0	Adjust:	Adjust RMV: 0	

Floors

Type	Class	Display Group	Floor Size	Beds	Baths	Yr Blt	Eff Yr Blt	Inventory
First Floor	5	Finished	1188	3	FB-2	2005	2005	SKIRT, HVAC+, KIT, BATH - 2, ROOF
Exception: Y N								

Accessories

Description	Class	Size SqFt	Eff Yr Blt	RMV	Quantity
DECK	5	56	2005	986	0
ROOF EXTENSION OR PATIO COVER	5	360	2005	8352	0

Improvements - Accessory Buildings

No improvement data available for all other stat class types.



MLS
New Farm/HP

BUILDING DIAGRAM AND OUTBUILDINGS

ACCT NO: *m336484*

MAP NO: *082W06AC*

TAX LOT: *02500*

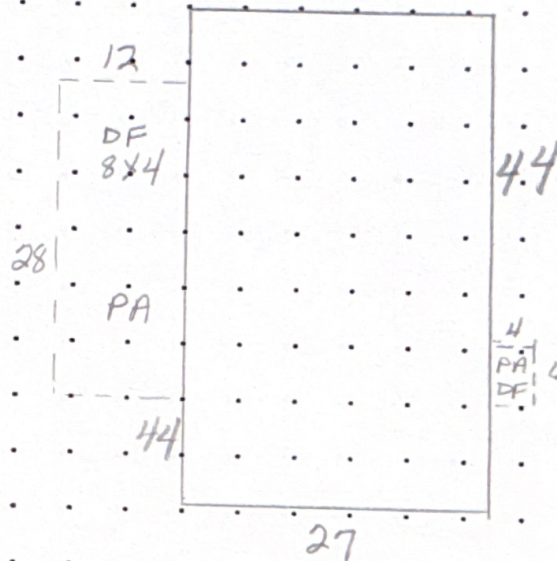

CALCULATIONS: $(44 \times 27) = 1,188$ \square

SCALE: 1" = 20'

MEASUREMENT
VERIFIED

YR BLT: *2005*

ADDRESS: *SUNDIAL RANCH #139*
2200 LANCASTER DR SE

BUILDER: *FLEETWOOD*

REMARKS: *NV*
NV, cycle

DATE
12-7-05
3-30-09
8-17-16

BY
DP32
DT4
DT4
DT4

SALES
Date Amt.



Marion County
OREGON
ASSESSOR'S OFFICE

Appraiser Sales Verification From

Primary Acct: 336484

MTL: 082W06AC02600

MaSaNh/P.Class: 1705000/019

Appraiser: THERESA SWEARINGEN

MS Acct: 336484

Date Printed: 8/4/2025

Situs: 2200 LANCASTER DR SE # 13-B SALEM, OR 97317

Grantor:
TOMPKINS, DIANA M

Grantee:
MARKS, SHARON

Sale ID: 34445

Deed:

Accts In Sale:

Sale Date: 5/21/2025

Sale Price: 107,500

Condition Code: 00 *133*

Tax Statement RMV

Land & OSD: 0 *123,690*

Imp: 131,500

Total: 131,500

Ratio (Cert. Total RMV/Sale Price): 122 *115*

Attempt	Date/Time	Reason
1 st		
2 nd		

Contact: _____ Phone/email: _____

1. Was the property listed on the open market? Days: *31* MLS: *823139* Y N

2. Was property other than real estate included in the sale? Y N
Describe: _____ Est. \$: _____

3. Did the seller pay closing costs or make other concessions? \$ _____ Y N

4. Was the sale between related parties? (business or family) Y N

5. Was this a distressed sale? E.g. foreclosure, short, court order, etc... Y N

6. Condition at time of sale: | Poor | Fair | Avg. | Good | Exc. | Y N
Describe: _____

7. Have any improvements been made since the time of sale? Y N
If yes, describe: _____

_____ *new roof*

Comments:

Appraiser: *02* Date: *8/19/25*