

# SKETCH/AREA TABLE ADDENDUM

## SUBJECT INFO

File No.: 128639 Parcel No.: 091W04C001500  
 Property Address: 9874 GOLF CLUB RD SE #26  
 City: STAYTON County: State: OR ZipCode: 97383  
 Owner:  
 Client: Client Address:  
 Appraiser Name: Inspection Date:

## SKETCH

**128639**  
**091W04C001500**

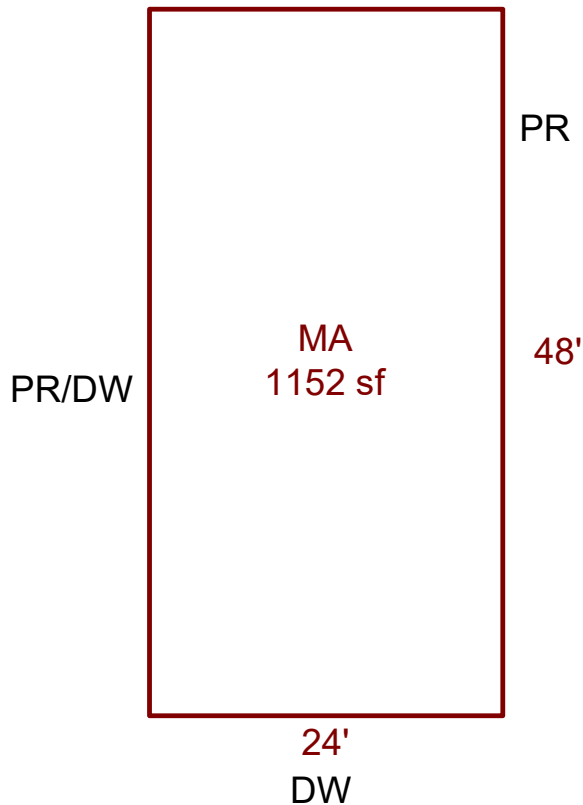

Sketch by ApexSketch

### AREA CALCULATIONS SUMMARY

Code	Description	Factor	Net Size	Perimeter	Net Totals
MFH	MA	1.0	1152.0	144.0	1152.0

### COMMENT TABLE 1

### COMMENT TABLE 2

### COMMENT TABLE 3

Net LIVABLE	cnt	1	(rounded)	1,152
-------------	-----	---	-----------	-------