

Acct ID: 533803 MTL: 084W36DD00500 Date: 8.20.25 Appr: GRH Prop Class: 641 RMV Prop Class: 401
 Situs: 4075 RIVERSIDE RD S SALEM OR 97306 MaSaNh: 06 06 000 Unit: 58201 Year: 2025
 Last Date Appraised: 10/12/2010 Appraiser: GERARDO RAMIREZ Retag: Y N Tag info: HERNANDEZ

Owner: ANDREWS, DANA L & ANDREWS, DEBRA M Roll Type: R
 Cycle Tag Sales Verification Other: _____ Inspection level: 1 2 3 4 LCB TTO INSP AV: 539755
 RMV Land: 355390 RMV Imp: 685380 RMV Total: 1040770 MAV: 538610 MSAV: 1145 SAV: 2220
 Comment:

Notations No changes

RP/MS	Code	Description
RP	DFL	DESIGNATED FORESTLAND

OSDs

Count	Code	Description	RMV	Code Area	Exception
1	MKTA	OSD - AVERAGE	50000	14460	0

Land

Site: 1	Code Area: 14460	Size: 0.99 Acres	Use Code: 004	Zone: NREST	SAV Use:	Exception: 0
Class: 6H	Value Source: Market Homesite	Description: SIX HILL	RMV: 135090	Exception: Y N		
Adjustment(s): VIEWE, FSOIL		Fire Patrol:	Description:			
Comments: 11-12: CYCLE WORK PER #42 ADD TREED & VIEW ADJ// 81400260 /00-01; SEPERATED INCREMENT FROM HOMESITE /01-02; REAPPRAISAL //04-05: LAND ADJUSTMENT FOR RECALCULATION, CHG OF LAND SCHEDULE PER #29 //F06-655 ACREAGE CORRECTION FOR R33806,R33803,R33802						
Site: 2	Code Area: 14460	Size: 2.00 Acres	Use Code: 004	Zone: NREST	SAV Use: 011	Exception: 0
Class: FTLC	Value Source: Designated Forest Land	Description: DFL Class C	RMV: 170300	Exception: Y N		
Adjustment(s): VIEWE, FSOIL		Fire Patrol:	Description:			
Comments: Liability year - 1986 / 81400260: 01-02; REAPPRAISAL						

Improvements - Residence / Manufactured Structures

Bldg: 1	Code Area: 14460	Stat Class: 152 +	Year Blt: 1986	Eff Year Blt: 1993	Sq.Ft: 3092	% Complete: 100
Desc: Multi Story above grade			Dimensions:	RMV: 683170		
Func Obsc: 100	Econ %: 100	Other %: 100	Exception: 0	Adjust:	Adjust RMV: 0	

Floors

Type	Class	Display Group	Floor Size	Beds	Baths	Yr Blt	Eff Yr Blt	Inventory	Exception: Y N
First Floor	5 +	Finished	1791	1	FB-1	1986	1993	KIT-, ROOF, FP - 2, HVAC+, BATH - 1	Exception: Y N
Second Floor	5 +	Finished	1301	2	FB-2	1986	1993	HVAC+, BATH - 2	Exception: Y N
Garage Attached	5	Finished	552	0	0	1986	1986	ROOF	Exception: Y N

Accessories

Description	Class	Size SqFt	Eff Yr Blt	RMV	Quantity	Exception: Y N
ASPHALT DRIVEWAY	5	8190	1986	16585	1	Exception: Y N
ENCLOSED PORCH	5	120	1992	4334	1	Exception: Y N
ENCLOSED PORCH	5	240	1992	8669	1	Exception: Y N
ROOF EXTENSION OR PATIO COVER	5	132	1992	3216	1	Exception: Y N
YARD IMPROVEMENTS AVERAGE	5	1	1993	37910	1	Exception: Y N

Bldg: 3	Code Area: 14460	Stat Class: 108	Year Blt:	Eff Year Blt:	Sq.Ft: 0	% Complete: 100
Desc: Residential Other Improvements			Dimensions:	RMV: 2010		
Func Obsc: 100	Econ %: 100	Other %: 100	Exception: 0	Adjust:	Adjust RMV: 0	

Floors

Type	Class	Display Group	Floor Size	Beds	Baths	Yr Blt	Eff Yr Blt	Inventory
No floor data available								

Accessories

Description	Class	Size SqFt	Eff Yr Blt	RMV	Quantity	Exception: Y N
GARDEN GREENHOUSE	1	168	0	2013	1	Exception: Y N

Improvements - Accessory Buildings

Bldg: 2	Code Area: 14460	Stat Class: 341	Year Blt: 2000	Eff Year Blt: 2000	Sq.Ft: 96	% Complete: 100
Desc: Multi Purpose Shed (MP)			Dimensions: 8x12	RMV: 200		
Func Obsc: 100	Econ %: 100	Other %: 100	Exception: 0	Adjust:	Adjust RMV: 0	

Floors

Type	Class	Display Group	Floor Size	Beds	Baths	Yr Blt	Eff Yr Blt	Inventory	Exception: Y N
Multi-Purpose Bldg	4	Finished	96	0	0	2000	2000	FAIR	

Accessories

Description	Class	Size SqFt	Eff Yr Blt	RMV	Quantity
No accessory data available					



SKETCH/AREA TABLE ADDENDUM

Parcel No **084W36DD00500**

File No **R33803**

Property Address **4075 RIVERSIDE RD S**

City **SALEM**

County **MARION**

State **OR**

Zip **97302**

Owner

Client

Appraiser Name

SUBJECT

IMPROVEMENTS SKETCH

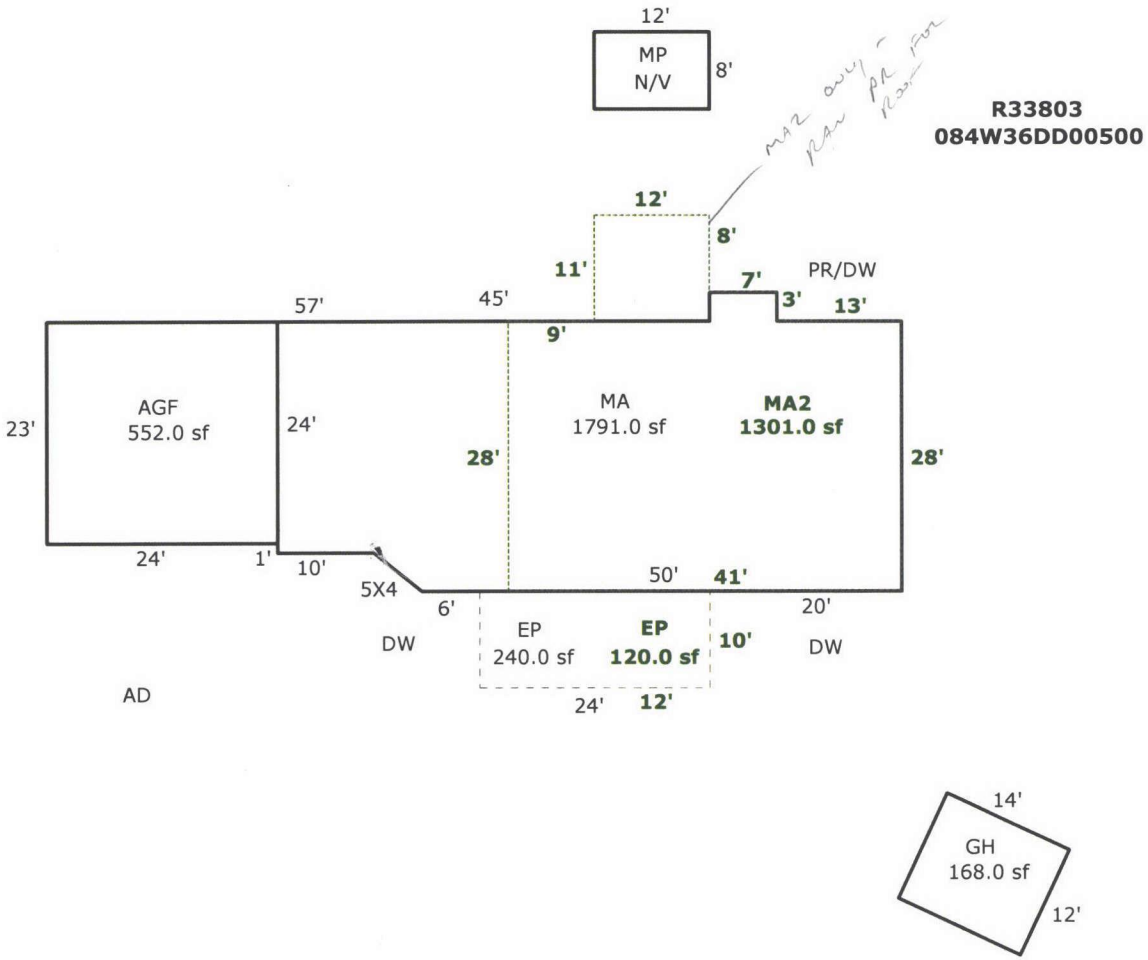

Scale: **1 = 20**

AREA CALCULATIONS

AREA CALCULATIONS SUMMARY

Code	Description	Factor	Net Size	Perimeter	Net Totals
GLA1	MA	1.00	1791.0	189.4	1791.0
GLA2	MA2	1.00	1301.0	160.0	1301.0
GBA1	MP	1.00	96.0	40.0	
	GH	1.00	168.0	52.0	264.0
GARAGE	AGF	1.00	552.0	94.0	552.0
P/P	EP	1.00	240.0	68.0	
	EP	1.00	120.0	44.0	360.0

Net LIVABLE Area (rounded w/ factors) **3092**
 Net BUILDING Area (rounded w/ factors) **264**

Comment Table 1

DRAWN BY SH 10-26-10

Comment Table 2

GRH 8.30.25 Cycle L2

Comment Table 3