

SKETCH/AREA TABLE ADDENDUM

SUBJECT INFO

File No.: 328500 Parcel No.: 082W02C 06200
 Property Address: 7454 HARLEY WY SE
 City: Salem County: Marion State: OR ZipCode: 97317
 Owner:
 Client: Client Address:
 Appraiser Name: Inspection Date:

SKETCH

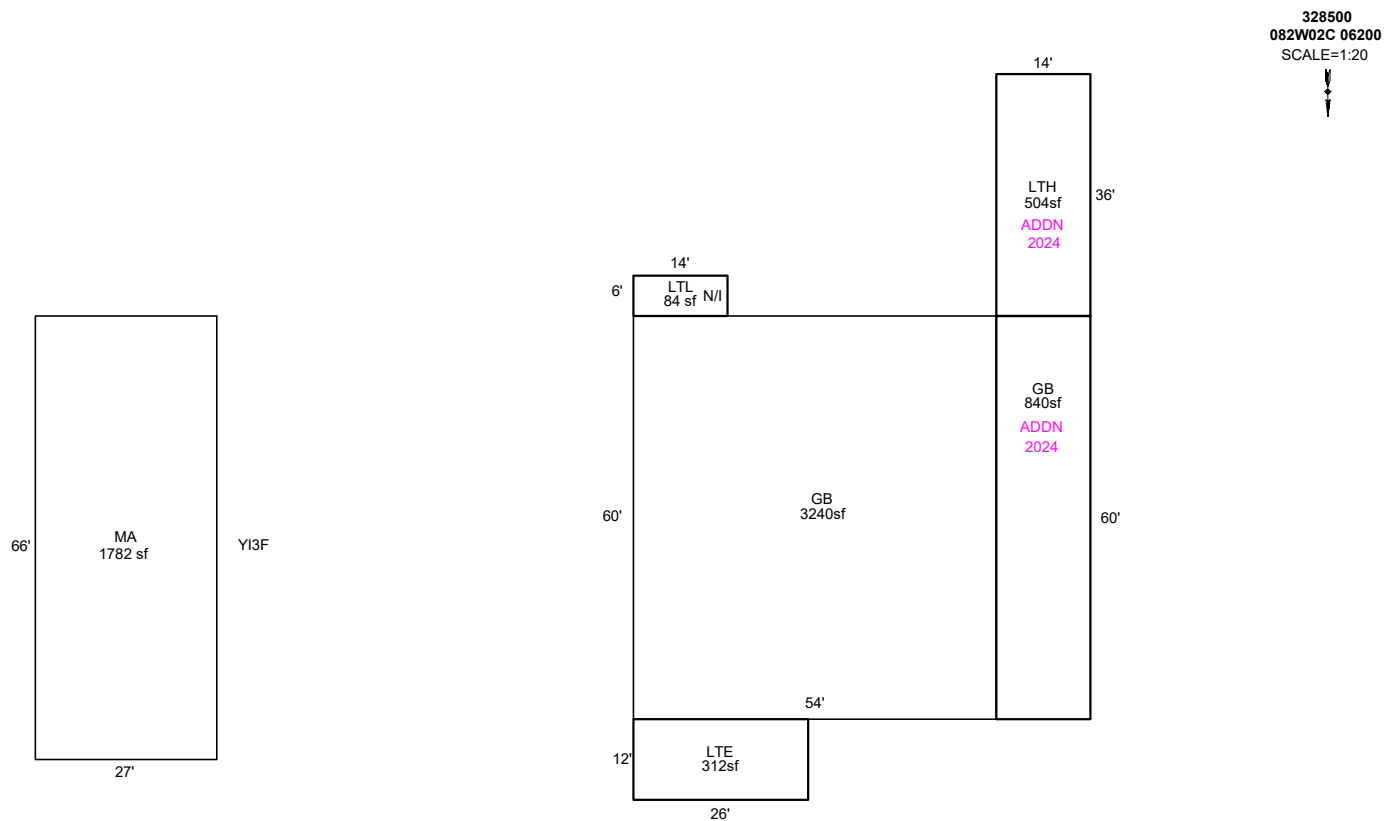

Sketch by ApexSketch

AREA CALCULATIONS SUMMARY						COMMENT TABLE 1					
Code	Description	Factor	Net Size	Perimeter	Net Totals						
GBA1	GB	1.0	3240.0	228.0		DRAWN BY JRONDEMA 2/15/18 UPDATED BY CJURAN 01/25/2021 555-20-007812 UPDATED BY CLOBERG 08/21/24 24-004385 ADDN UPDATED BY CLOBERG 01/14/25 UPDATED BY CLOBERG 10/15/25					
	LTE	1.0	312.0	76.0							
	GB	1.0	840.0	148.0							
	LTH	1.0	504.0	100.0	4896.0						
GLA1	MA	1.0	1782.0	186.0	1782.0						
	Net LIVABLE	cnt	0 (rounded)		1,782	<table border="1" style="width: 100%; border-collapse: collapse;"> <thead> <tr style="background-color: #f2f2f2;"> <th style="text-align: left;">COMMENT TABLE 2</th> <th style="text-align: left;">COMMENT TABLE 3</th> </tr> </thead> <tbody> <tr> <td style="vertical-align: top;"> CLUKE 12/17/24 CLUKE </td> <td style="vertical-align: top;"> TAGS L3 TAGS L4 </td> </tr> </tbody> </table>		COMMENT TABLE 2	COMMENT TABLE 3	CLUKE 12/17/24 CLUKE	TAGS L3 TAGS L4
COMMENT TABLE 2	COMMENT TABLE 3										
CLUKE 12/17/24 CLUKE	TAGS L3 TAGS L4										
	Net BUILDING	cnt	4 (rounded)		4,896						