

SKETCH/AREA TABLE ADDENDUM

SUBJECT INFO

File No.: 149793 Parcel No.: 061E22AB04301
 Property Address: 695 C ST
 City: SCOTTS MILLS County: Marion State: OR ZipCode: 97375
 Owner:
 Client: Client Address:
 Appraiser Name: Inspection Date:

SKETCH

149793
061E22AB04301

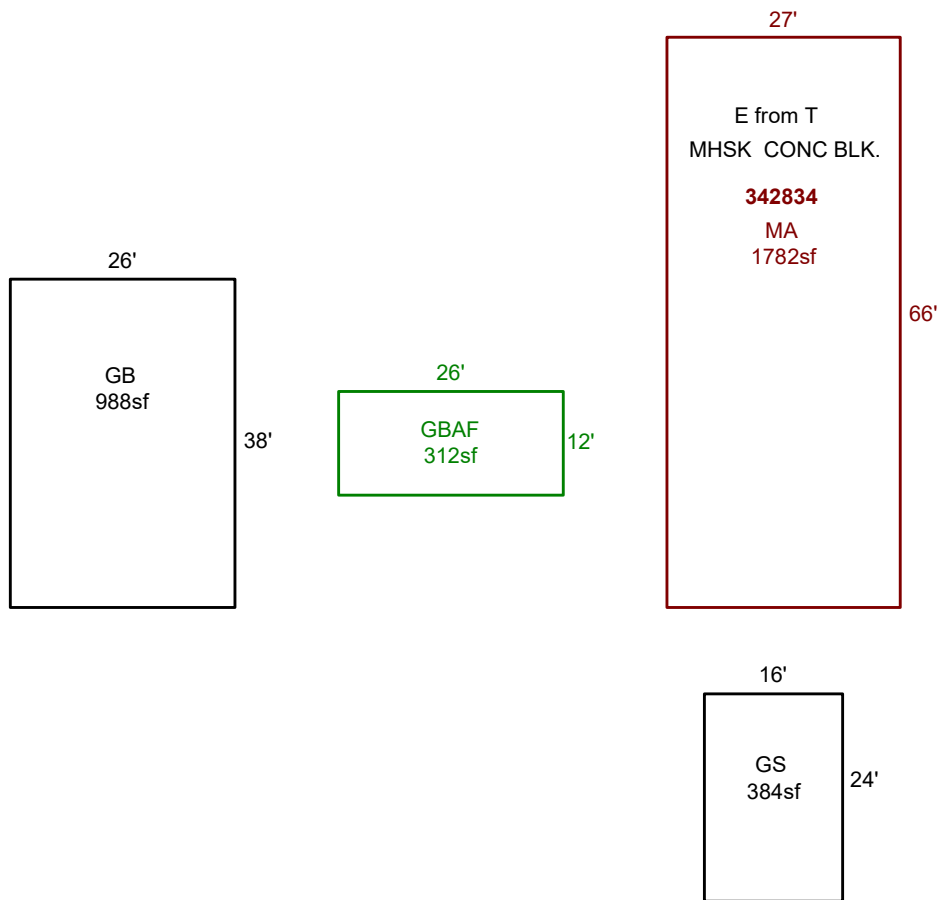

Sketch by ApexSketch

AREA CALCULATIONS SUMMARY

Code	Description	Factor	Net Size	Perimeter	Net Totals
GBA	GBAF	1.0	312.0	76.0	
	GB	1.0	988.0	128.0	
	GS	1.0	384.0	80.0	1684.0
MFH	MA	1.0	1782.0	186.0	1782.0
	Net LIVABLE	cnt	1 (rounded)		1,782
	Net BUILDING	cnt	3 (rounded)		1,684

COMMENT TABLE 1

APEX BY MJB 04-15-10
 Updated by AE 11.12.25

COMMENT TABLE 2

9-7-17 96 Cycle NV

COMMENT TABLE 3