

# SKETCH/AREA TABLE ADDENDUM

## SUBJECT INFO

File No.: 321648 Parcel No.: 093W06 00201  
 Property Address: 3335 RIVERSIDE RD S  
 City: SALEM County: Marion State: OR ZipCode:  
 Owner:  
 Client: Client Address:  
 Appraiser Name: Morrie Efseaff Inspection Date: 2012

## SKETCH

321648  
093W06 00201  
Scale 1:40

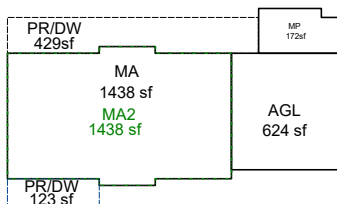
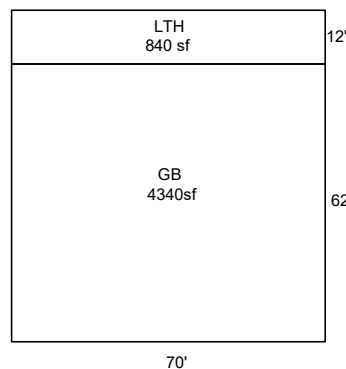
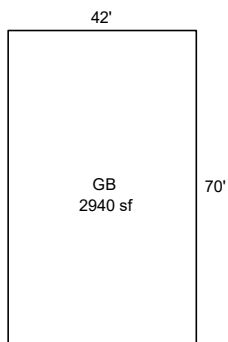

SEE PAGE 2 FOR RES DETAIL



Sketch by ApexSketch

AREA CALCULATIONS SUMMARY						COMMENT TABLE 1			
Code	Description	Factor	Net Size	Perimeter	Net Totals				
GBA1	GB	1.0	2940.0	224.0		APEX by AC 11/20/12 UPD BY PH 02.26.20 ADDN-REMOD/18-003736 UPD BY WW 5.1.24 UPDATED BY CLOBERG 11/24/25			
	GB	1.0	4340.0	264.0					
	LTH	1.0	840.0	164.0	8120.0				
GBA3	MP	1.0	172.0	56.0	172.0				
GLA1	MA	1.0	1437.5	162.0	1437.5				
GLA2	MA2	1.0	1437.5	162.0	1437.5				
YI1	PR/DW	1.0	123.0	53.0					
	PR/DW	1.0	429.3	131.0	552.3				
						COMMENT TABLE 2	COMMENT TABLE 3		
						GRH 10/23/25	TAGS L2		
		Net LIVABLE	cnt	0 (rounded)	2,875				
		Net BUILDING	cnt	4 (rounded)	8,292				

# SKETCH/AREA TABLE ADDENDUM

## SUBJECT INFO

File No.: 321648 Parcel No.: 093W06 00201  
 Property Address: 3335 RIVERSIDE RD S  
 City: SALEM County: Marion State: OR ZipCode:  
 Owner:  
 Client: Client Address:  
 Appraiser Name: Morrie Efseaff Inspection Date: 2012

## SKETCH

**321648**  
**093W06 00201**  
 SCALE=1:20



SEE PAGE 1 FOR ALL BLDGS

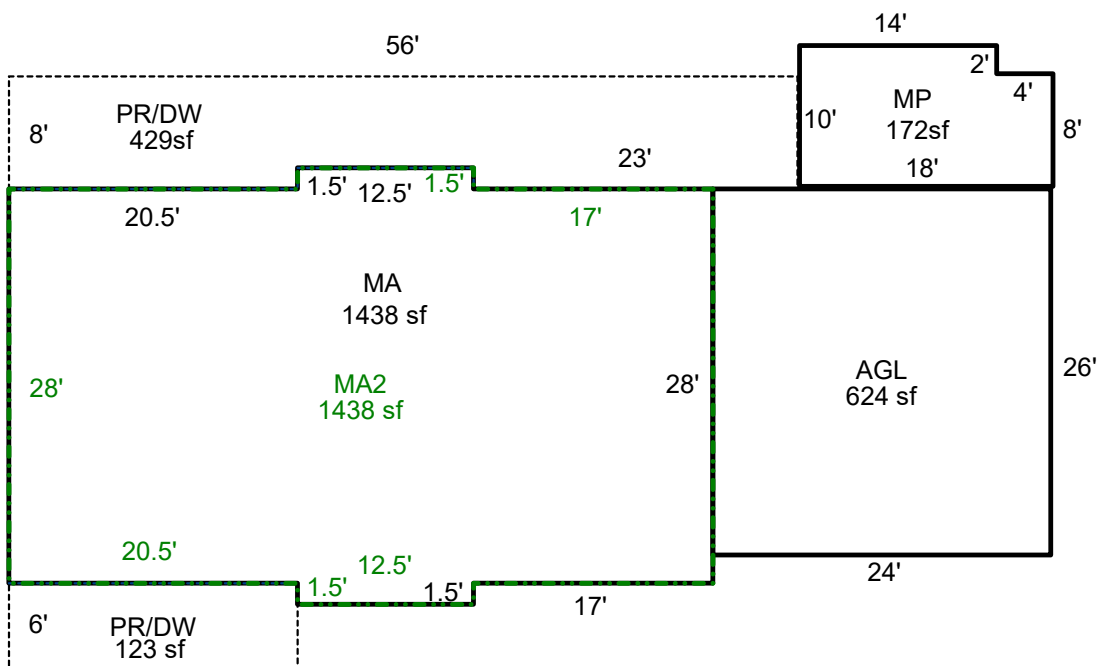

Sketch by ApexSketch

### AREA CALCULATIONS SUMMARY

Code	Description	Factor	Net Size	Perimeter	Net Totals
GBA3	MP	1.0	172.0	56.0	172.0
GLA1	MA	1.0	1437.5	162.0	1437.5
GLA2	MA2	1.0	1437.5	162.0	1437.5
YI1	PR/DW	1.0	123.0	53.0	
	PR/DW	1.0	429.3	131.0	552.3

### COMMENT TABLE 1

APEX by AC 11/20/12  
 UPD BY PH 02.26.20 ADDN-REM0D/18-003736  
 UPD BY WW 5.1.24  
 UPDATED BY CLOBERG 11/24/25

### COMMENT TABLE 2

GRH 10/23/25

### COMMENT TABLE 3

TAGS L2

Net LIVABLE cnt 0 (rounded) 2,875  
 Net BUILDING cnt 1 (rounded) 172