

Summary

Lead Appr: WW 10/20

Clerk:

Lead Clerk:

Appr:

Print Date:

9/26/2025

Acct ID: 529320

MTL: 082W03A000500

Date: 10-8-25

Appr: ENR

Prop Class: 401

RMV Prop Class: 401

Situs: 7135 DARLING ST SE SALEM OR 97317

MaSaNh: 01 06 000

Unit: 53792

Year: 2025

Last Date Appraised: 09/20/2023

Appraiser: CLINT LUKE

Tag: Y

Tag info: 2026 - Tags/Permit (Alt Energy System)

Owner: STEVEN & SANDRA HARRIS TR &

Last Sales Date: 10/01/2019

Roll Type: R

Cycle tag Sales Verification Other:

Inspection level: 1 2 3 0

LCB TTO INSP

AV: 522160

RMV Land: 300290

RMV Imp: 952160

RMV Total: 1252450

MAV: 522160

MSAV: 0

SAV: 0

Comment: 24-25: L2 09.20.23 GRH
23-24: L2 12.13.22 MLH//22-23: GRH L2 01.06.22
LEVEL 3 1.5.21 WV06 & PH-T42
LEVEL 4 C19 4-27-20 06WV

25-00961 SOLAR MAX 20K EXEMPT
FINALEO 4-21-25

OSDs

Count	Code	Description	RMV	Code Area	Exception
1	MKTA	OSD - AVERAGE	50000	92410	0

Land

Site: 1	Code Area: 92410	Size: 2.00 Acres	Use Code: 004	Zone: NREST	SAV Use:	Exception: 0
Class: 4HD	Value Source: Rural at MKT	Description: FOUR HILL DRY	RMV: 250290	Exception: Y	N	
Adjustment(s):	Fire Patrol:	Description:				
Comments: 21-22: PER #06 ADD OSD / 21-22: #06 CYCLE C19, NO CHG //2400210 /00-01; SEPERATE INCREMENT FROM HOMESITE 00-01: 02400210, GI QUESTIONNAIRE STATED NO IRRIG /01-02; CHANGED SOIL CLASS FROM 3 HILL DRY TO 4 HILL DRY /02-03: REAPPRAISAL 07-08: 4.3 ACRES DISQ FARM DEF, FAILURE TO PROVIDE GI QUEST 07-08: DISCONTINUE PART TOTALLING - AR ZONING						

Improvements - Residence / Manufactured Structures

Bldg: 1	Code Area: 92410	Stat Class: 151	Year Blt: 2020	Eff Year Blt: 2020	Sq.Ft: 2557	% Complete: 100.00
Desc: One Story Only	Dimensions:	RMV: 720020				
Func Obsc: 100	Econ %: 100	Other %: 100	Exception: 0	Adjust:	Adjust RMV: 0	

Floors

Type	Class	Display Group	Floor Size	Beds	Baths	Yr Blt	Eff Yr Blt	Inventory	Exception:
First Floor	5	Finished	2557	3	FB-2/ HB-1	2020	2020	ROOF, HVAC, KIT, BTH - 1, BATH - 2, FP - 1	Y N
Garage Attached	5	Finished	1248	0	0	2020	2020	ROOF	Y N

Accessories

Description	Class	Size SqFt	Eff Yr Blt	RMV	Quantity	Exception:
YARD IMPROVEMENTS AVERAGE	5	0	2020	43708	1	Y N

Bldg: 4	Code Area: 92410	Stat Class: 148	Year Blt: 2022	Eff Year Blt: 2022	Sq.Ft: 0	% Complete: 100.00
Desc: Res other improvements	Dimensions:	RMV: 232140				
Func Obsc: 100	Econ %: 100	Other %: 100	Exception: 0	Adjust:	Adjust RMV: 0	

Floors

Type	Class	Display Group	Floor Size	Beds	Baths	Yr Blt	Eff Yr Blt	Inventory	Exception:
Garage Oversized Detached	4	Finished	2660	0	HB-1	2022	2022	BTH - 1, ROOF	Y N
Carport Attached	4	Unfinished	310	0	0	2022	2022		Y N

Accessories

Description	Class	Size SqFt	Eff Yr Blt	RMV	Quantity
No accessory data available					

Permits

Permit Number	Permit ID	Origin	Category	Type	Estimate Value	% Complete	Roll Type	Description
25-000961	83535	MARION COUNTY	TAGS/PERMITS	ALT ENERGY SYSTEM	37855	0	R	Solar Array 19.2kW on RES Roof @ \$37,855

SKETCH/AREA TABLE ADDENDUM

SUBJECT INFO

File No.: 529320 Parcel No.: 082W03A 00500
 Property Address: 7135 DARLING ST SE
 City: SALEM County: MARION State: OR ZipCode: 97306
 Owner:
 Client: Client Address:
 Appraiser Name: Inspection Date:

SKETCH

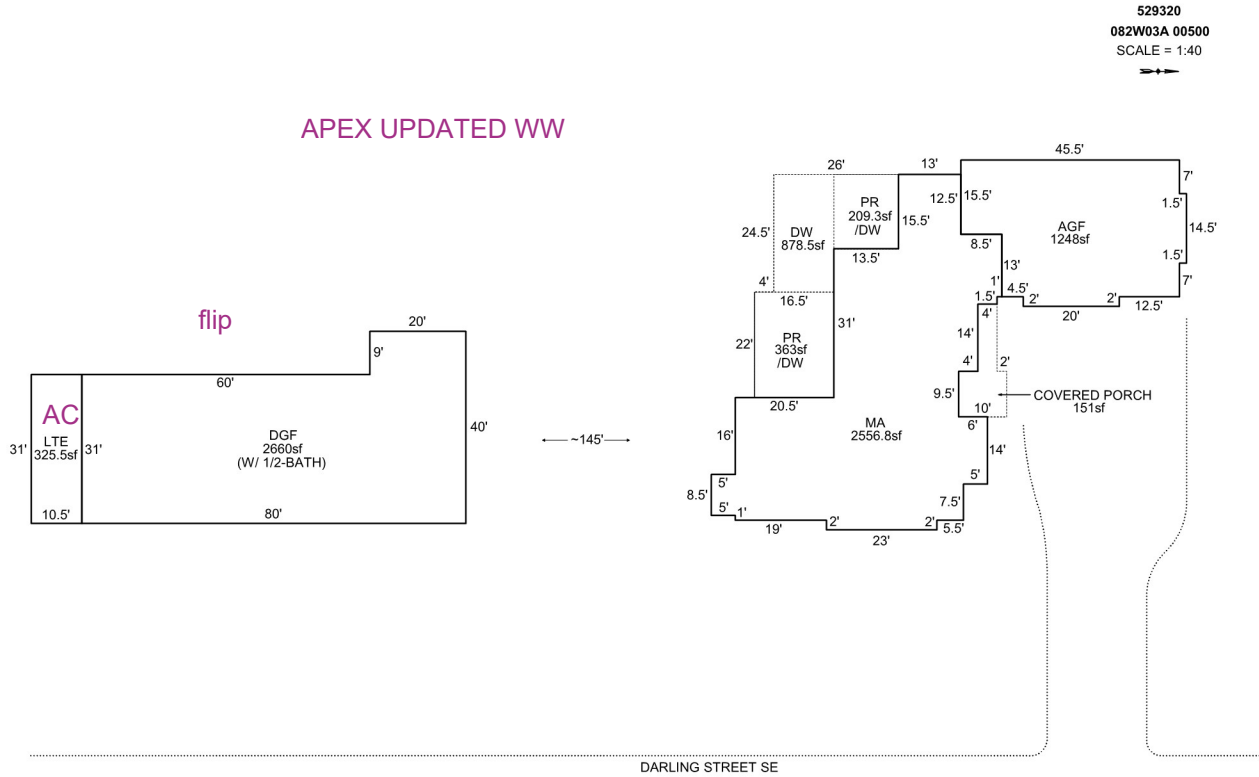

Sketch by Apex Sketch

AREA CALCULATIONS SUMMARY

Code	Description	Factor	Net Size	Perimeter	Net Totals
GBA1	DGF	1.0	2660.0	240.0	
	LTE	1.0	325.5	83.0	2985.5
GLA1	MA	1.0	2556.8	281.0	2556.8
GAR	AGF	1.0	1248.0	155.0	1248.0
P/P	PR	1.0	209.3	58.0	
	COVERED PORCH	1.0	151.0	67.0	
	PR	1.0	363.0	77.0	
	DW	1.0	878.5	153.0	1601.8
	Net LIVABLE	cnt	1	(rounded)	2,557
Net BUILDING	cnt	2	(rounded)	2,986	

COMMENT TABLE 1

SKETCHED BY PHU 07.30.20 / BP # 20-003419
 UPDATED BY CJURAN 10/12/2022 555-22-006987
 UPDATED BY CJURAN 03/13/2023

COMMENT TABLE 2

MLH 12/13/2022

COMMENT TABLE 3

TAGS L2

GRH 9-20-23 TAGS L2
 EVER 10-8-25 TAGS L4