

Acct ID: 533236 MTL: 083W29A000200 Date: **11/18/25** Appr: **GRH** Prop Class: 409 RMV Prop Class: 409  
 Situs: 7134 KATY LN S SALEM OR 97302 MaSaNh: 06 06 002 Unit: 54883 Year: 2025

Last Date Appraised: 01/06/2023 Appraiser: GERARDO RAMIREZ HERNANDEZ Tag: Y **N** Tag info: 2026 - Tags/Permit (Alt Energy System)

Owner: HOPE, ROGER L Last Sales Date: 04/28/2021 Roll Type: R  
 Cycle: **Tag** Sales Verification Other: \_\_\_\_\_ Inspection level: 1 2 3 **4** LCB TTO INSP AV: 222530

RMV Land: 233050 RMV Imp: 230470 RMV Total: 463520 MAV: 222530 MSAV: 0 SAV: 0

Comment: 23-24: L2 01.06.23 GRH  
 22-23: L4 5.20.22 MP

*Several no trespass passing, not comfortable  
 Aerials show solar panels*

*OSDs property is locate in difficult spot Add solar 100%, update inv*

Count	Code	Description	RMV	Code Area	Exception
1	MKTF	OSD - FAIR	40000	92430	0

**Land**

Site: 1 Code Area: 92430 Size: 1.08 Acres Use Code: 004 Zone: NREST SAV Use: Exception: 0  
 Class: Value Source: Rural at MKT Description: RMV: 193050 Exception: Y N  
 Adjustment(s): Fire Patrol: Description:  
 Comments: 01-02; REAPPRAISAL

**Improvements - Residence / Manufactured Structures**

Bldg: 1 Code Area: 92430 Stat Class: 457 + Year Blt: 2001 Eff Year Blt: 2009 Sq.Ft: 2366 % Complete: 100.00  
 Desc: MANUF STRUCT, CLASS 5, 26' THROUGH 28' WIDE DOUBLE Dimensions: RMV: 199970  
 Func Obsc: 100 Econ %: 100 Other %: 100 Exception: 0 Adjust: Adjust RMV: 0 Subtype: E

**Floors**

Type	Class	Display Group	Floor Size	Beds	Baths	Yr Blt	Eff Yr Blt	Inventory	Exception
First Floor	5 +	Finished	2366	3	FB-2	2001	2009	SKRT+, FP - 1, BATH - 2, KIT+	Y N

**Accessories**

Description	Class	Size SqFt	Eff Yr Blt	RMV	Quantity
No accessory data available					

Bldg: 4 Code Area: 92430 Stat Class: 107 Year Blt: Eff Year Blt: 2009 Sq.Ft: 0 % Complete: 100.00  
 Desc: Yard Improvements Dimensions: RMV: 18990  
 Func Obsc: 100 Econ %: 100 Other %: 100 Exception: 0 Adjust: Adjust RMV: 0

**Floors**

Type	Class	Display Group	Floor Size	Beds	Baths	Yr Blt	Eff Yr Blt	Inventory	Exception
No floor data available									

**Accessories**

Description	Class	Size SqFt	Eff Yr Blt	RMV	Quantity
YARD IMPROVEMENTS FAIR	4	0	2009	17912	1
Exception: Y N					

**Improvements - Accessory Buildings**

Bldg: 3 Code Area: 92430 Stat Class: 351 Year Blt: 2002 Eff Year Blt: 2002 Sq.Ft: 720 % Complete: 100.00  
 Desc: General Purpose Building (GB) Dimensions: 24x30 RMV: 11510  
 Func Obsc: 100 Econ %: 100 Other %: 100 Exception: 0 Adjust: Adjust RMV: 0

**Floors**

Type	Class	Display Group	Floor Size	Beds	Baths	Yr Blt	Eff Yr Blt	Inventory	Exception
General Purpose Bldg	6	Finished	720	0	0	2002	2002	FAIR	Y N

**Accessories**

Description	Class	Size SqFt	Eff Yr Blt	RMV	Quantity
No accessory data available					

**Permits**

Permit Number	Permit ID	Origin	Category	Type	Estimate Value	% Complete	Roll Type	Description
25-001907	83511	MARION COUNTY	TAGS/PERMITS	ALT ENERGY SYSTEM	12500	0	R	Solar Array 10 kW on Shop Roof @ \$12,500

ACCOUNT # 533236

DATE: 11/18/25

RMV CLASS \_\_\_\_\_

PROP CLASS \_\_\_\_\_

MTL \_\_\_\_\_

APPR GRT

TAG Y (N)

COMMENTS: \_\_\_\_\_

RESIDENCE / MANUFACTURED STRUCTURES

ACCESSORY IMPROVEMENTS / OUTBUILDINGS

STAT \_\_\_\_\_ QLTY + - FLOOR \_\_\_\_\_  
 AREA \_\_\_\_\_ EFF AREA \_\_\_\_\_ BED \_\_\_\_\_  
 ROOF + HVAC +  
 BATH PKG: \_\_\_\_\_ BATH \_\_\_\_\_ BATH + \_\_\_\_\_ 1/2 BTH  
 FIREPLACE: \_\_\_\_\_  
 KITCHEN - +  
 YR BLT \_\_\_\_\_ EFF YR \_\_\_\_\_ ECON \_\_\_\_\_  
 % COMP \_\_\_\_\_ % GOOD \_\_\_\_\_ FUNC \_\_\_\_\_  
 EXCEPT Y N LUMP SUM: \_\_\_\_\_  
 MISC: \_\_\_\_\_

YI CLASS \_\_\_\_\_ F G A E  
 SKIRT + LIN FT \_\_\_\_\_  
 COMMENT: \_\_\_\_\_

STAT \_\_\_\_\_ QLTY + - FLOOR \_\_\_\_\_  
 AREA \_\_\_\_\_ EFF AREA \_\_\_\_\_ BED \_\_\_\_\_  
 ROOF + HVAC +  
 BATH PKG: \_\_\_\_\_ BATH \_\_\_\_\_ BATH + \_\_\_\_\_ 1/2 BTH  
 FIREPLACE: \_\_\_\_\_  
 KITCHEN - +  
 YR BLT \_\_\_\_\_ EFF YR \_\_\_\_\_ ECON \_\_\_\_\_  
 % COMP \_\_\_\_\_ % GOOD \_\_\_\_\_ FUNC \_\_\_\_\_  
 EXCEPT Y N LUMP SUM: \_\_\_\_\_  
 MISC: \_\_\_\_\_

YI CLASS \_\_\_\_\_ F G A E  
 SKIRT + LIN FT \_\_\_\_\_  
 COMMENT: \_\_\_\_\_

STAT \_\_\_\_\_ QLTY + - FLOOR \_\_\_\_\_  
 AREA \_\_\_\_\_ EFF AREA \_\_\_\_\_ BED \_\_\_\_\_  
 ROOF + HVAC +  
 BATH PKG: \_\_\_\_\_ BATH \_\_\_\_\_ BATH + \_\_\_\_\_ 1/2 BTH  
 FIREPLACE: \_\_\_\_\_  
 KITCHEN - +  
 YR BLT \_\_\_\_\_ EFF YR \_\_\_\_\_ ECON \_\_\_\_\_  
 % COMP \_\_\_\_\_ % GOOD \_\_\_\_\_ FUNC \_\_\_\_\_  
 EXCEPT Y N LUMP SUM: \_\_\_\_\_  
 MISC: \_\_\_\_\_

YI CLASS \_\_\_\_\_ F G A E  
 SKIRT + LIN FT \_\_\_\_\_  
 COMMENT: \_\_\_\_\_

TYPE Solar  
 STAT / CLASS 905  
 SIZE \_\_\_\_\_  
 FAIR \$12000  
 AVERAGE \_\_\_\_\_  
 GOOD \_\_\_\_\_  
 EXCELLENT \_\_\_\_\_  
 BATH \_\_\_\_\_

YR BLT 2025  
 EFF YR 2025  
 % COMP 100  
 EXCEPT Y (N)  
 MISC: \_\_\_\_\_

COMMENT: Exempt solar

TYPE \_\_\_\_\_  
 STAT / CLASS \_\_\_\_\_  
 SIZE \_\_\_\_\_  
 FAIR \_\_\_\_\_  
 AVERAGE \_\_\_\_\_  
 GOOD \_\_\_\_\_  
 EXCELLENT \_\_\_\_\_  
 BATH \_\_\_\_\_

YR BLT \_\_\_\_\_  
 EFF YR \_\_\_\_\_  
 % COMP \_\_\_\_\_  
 EXCEPT Y N  
 MISC: \_\_\_\_\_

COMMENT: \_\_\_\_\_

TYPE Hc  
 STAT / CLASS \_\_\_\_\_  
 SIZE \_\_\_\_\_  
 FAIR (N)  
 AVERAGE 12x20  
 GOOD \_\_\_\_\_  
 EXCELLENT \_\_\_\_\_  
 BATH \_\_\_\_\_

YR BLT \_\_\_\_\_  
 EFF YR 2007  
 % COMP 100  
 EXCEPT Y N  
 MISC: \_\_\_\_\_

COMMENT: on property since 2007 aerial

TYPE \_\_\_\_\_  
 STAT / CLASS \_\_\_\_\_  
 SIZE \_\_\_\_\_  
 FAIR \_\_\_\_\_  
 AVERAGE \_\_\_\_\_  
 GOOD \_\_\_\_\_  
 EXCELLENT \_\_\_\_\_  
 BATH \_\_\_\_\_

YR BLT \_\_\_\_\_  
 EFF YR \_\_\_\_\_  
 % COMP \_\_\_\_\_  
 EXCEPT Y N  
 MISC: \_\_\_\_\_

COMMENT: \_\_\_\_\_

# SKETCH/AREA TABLE ADDENDUM

## SUBJECT INFO

File No.: 533236 Parcel No.: 083W29A 00200  
 Property Address: 7134 KATY LN S  
 City: SALEM County: MARION State: OR ZipCode: 97302  
 Owner:  
 Client: Client Address:  
 Appraiser Name: Inspection Date:

## SKETCH

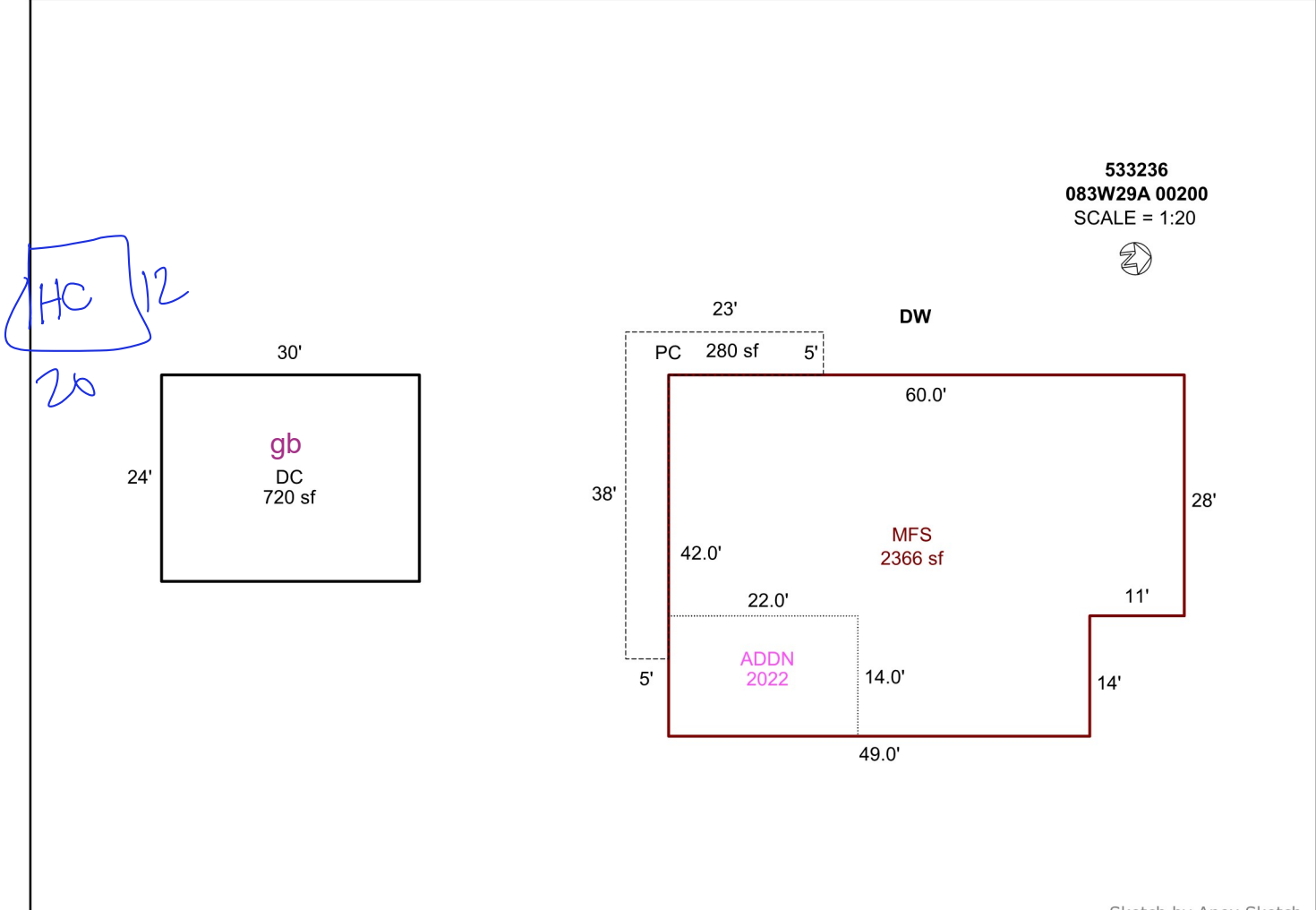

**533236**  
**083W29A 00200**  
 SCALE = 1:20



Sketch by Apex Sketch

### AREA CALCULATIONS SUMMARY

Code	Description	Factor	Net Size	Perimeter	Net Totals
GLA1	MFS	1.0	2366.0	204.0	2366.0
GAR	DC	1.0	720.0	108.0	720.0
P/P	PC	1.0	280.0	122.0	280.0

### COMMENT TABLE 1

APEXED BY NRC 04/09/2009  
 UPDATED BY CJURAN 01/20/2022 555-21-010518  
 UPDATED BY CJURAN 02/08/2023

### COMMENT TABLE 2

GRH 01/06/2022  
 GRH 11/19/25

### COMMENT TABLE 3

TAGS L2  
 TAGS L4

Net LIVABLE                      cnt                      1                      (rounded)                      2,366



533236 FRONT DC 30X 24 NORTH  
2023-01-06 L2



533236 MFS SOUTH  
2023-01-06 L2



533236 DC 30X24 WEST  
2023-01-06 L2



533236 MA ADDITION 12X14 NORTH  
2023-01-06 L2



533236 REAR MFS NORTH  
2023-01-06 L2



533236 FRONT MFS EAST  
2023-01-06 L2



533236 MFS WEST  
2023-01-06 L2

# Assessor Monthly Issued Permit Report

For 3/1/2025 to 3/31/2025

PERMIT#: 555-25-001907-STR STATUS: Permit Issued  
 PERMIT TYPE: Residential APPLIED: 3/17/2025  
 SUB-TYPE: Structural ISSUED: 3/27/2025  
 CATEGORY: Comprehensive EXPIRES: 9/23/2025

OFFICE: MC

PARCEL#: 083W29A000200 R33236

ACRES: 1.08

SUBDIV:

LOT/BLOCK: /

ADDRESS: 7134 KATY LN S SALEM, OR 97302

RELATIONSHIP	NAME	ADDRESS	PHONE
(C) ELECTRICAL CONTRACTOR	PURE ENERGY GROUP INC	139 ANKENY HILL RD SE JEFFERSON, OR 97352	5413274090
APPLICANT	BENJAMIN STEFFEN	139 ANKENY HILL RD SE JEFFERSON, OR 97352	5039799524
CCB	PURE ENERGY GROUP INC	139 ANKENY HILL RD SE JEFFERSON, OR 97352	5419360980
OWNER	HOPE, ROGER L	4742 LIBERTY RD S # 225 SALEM, OR 97302	
SITE CONTACT	BENJAMIN STEFFEN	139 ANKENY HILL RD SE JEFFERSON, OR 97352	5039799524

CONST CAT: Single Family Dwelling

WORK TYPE: Alteration

WORK DESC: NON-PRESCRIPTIVE Add 10kW Roof-mounted PV Solar Array

VALUATION: \$12,500.00

STORIES: 0

BATHS:

KITCHENS:

SQUARE FEET

HABITABLE:

EXISTING: 0

NEW: 0

**TOTAL SQ. FT.:**