

Acct ID: 529793 MTL: 082W12000400 Date: **9.29.25** Appr: **CW** Prop Class: 551 RMV Prop Class: 551
 Situs: 4290 HOWELL PRAIRIE RD SE SALEM OR 97317 MaSaNh: 01 06 000 Unit: 30695 Year: 2025

Last Date Appraised: 07/25/2017 Appraiser: CLINT LUKE Retag: Y Tag info: _____

Owner: SANDAU FARMS INC Roll Type: R

Cycle Tag Sales Verification Other: _____ Inspection level: 1 2 3 **4** LCB TTO INSP AV: 257132

RMV Land: 958050 RMV Imp: 197500 RMV Total: 1155550 MAV: 127850 MSAV: 151242 SAV: 466553

Comment: **CWO 12/11/25**

INPUT 11-25-25 CW

Notations

RP/MS	Code	Description
RP	ZONED	FARM EFU ZONED

OSDs

Count	Code	Description	RMV	Code Area	Exception
4	SAA	SA OSD - AVERAGE	50000	92410	0

Land

Grass 5051

Site: 2 Code Area: 92410 Size: 1.00 Acres Use Code: 005 Zone: REST SAV Use: 011 Exception: 0
 Class: Value Source: Farm Homesite Description: RMV: 5000 Exception: Y N

Adjustment(s): GSOIL, IRR, GSOIL, GSOIL, GSOIL, WASTE, IRR, IRR, IRR Fire Patrol: Description:

Comments: Liability year - 2009 / //09-10: GW39 changed land type per Excel analysis// 2400210

Site: 3 Code Area: 92410 Size: 2.00 Acres Use Code: 005 Zone: REST SAV Use: 011 Exception: 0
 Class: 2HI Value Source: Farm Use - EFU Description: TWO HILL IRR RMV: 11500 Exception: Y N

Adjustment(s): GSOIL, IRR, GSOIL, GSOIL, GSOIL, WASTE, IRR, IRR, IRR Fire Patrol: Description:

Comments: Liability year - 1980 / 2400210

Site: 4 Code Area: 05418 Size: 2.00 Acres Use Code: 005 Zone: REST SAV Use: 011 Exception: 0
 Class: 2HI Value Source: Farm Use - EFU Description: TWO HILL IRR RMV: 11500 Exception: Y N

Adjustment(s): GSOIL, IRR, GSOIL, GSOIL, GSOIL, WASTE, IRR, IRR, IRR Fire Patrol: Description:

Comments: Liability year - 1980 / 17-18: #94 CYCLE WORK, NO CHG / 560210: 02-03: REAPPRAISAL

Site: 4 Code Area: 05558 Size: 46.00 Acres Use Code: 005 Zone: REST SAV Use: 011 Exception: 0
 Class: 2HI Value Source: Farm Use - EFU Description: TWO HILL IRR RMV: 264500 Exception: Y N

Adjustment(s): GSOIL, IRR, GSOIL, GSOIL, GSOIL, WASTE, IRR, IRR, IRR Fire Patrol: Description:

Comments: Liability year - 1980

Site: 4 Code Area: 92550 Size: 106.00 Acres Use Code: 005 Zone: REST SAV Use: 011 Exception: 0
 Class: 2HI Value Source: Farm Use - EFU Description: TWO HILL IRR RMV: 609500 Exception: Y N

Adjustment(s): GSOIL, IRR, GSOIL, GSOIL, GSOIL, WASTE, IRR, IRR, IRR Fire Patrol: Description:

Comments: Liability year - 1980 / 17-18: #94 CYCLE WORK, CHG SOIL CLASSES / 2400050: 02-03; CHANGED LAND TABLE FROM 00G TO 00HA AS NO LONG PART TOTALED DUE TO LLC

Site: 5 Code Area: 92550 Size: 1.00 Acres Use Code: 005 Zone: REST SAV Use: 011 Exception: 0
 Class: 4HI Value Source: Farm Use - EFU Description: FOUR HILL IRR RMV: 5250 Exception: Y N

Adjustment(s): GSOIL, IRR, GSOIL, GSOIL, GSOIL, WASTE, IRR, IRR, IRR Fire Patrol: Description:

Comments: Liability year - 1980 / 2400050: 01-02; CHANGED SOIL CLASS FROM 3 HILL DRY TO 4 HILL DRY /2400050: 02-03; CHANGED LAND TABLE FROM 00G TO 00HA AS NO LONG PART TOTALED DUE TO LLC

Site: 6 Code Area: 92550 Size: 2.00 Acres Use Code: 005 Zone: REST SAV Use: 011 Exception: 0
 Class: WST Value Source: Farm Use - EFU Description: Rural WASTELAND RMV: 800 Exception: Y N

Adjustment(s): GSOIL, IRR, GSOIL, GSOIL, GSOIL, WASTE, IRR, IRR, IRR Fire Patrol: Description:

Comments: Liability year - 1980 / 2400050

Improvements - Residence / Manufactured Structures

Bldg: 1 Code Area: 92410 Stat Class: 134 + Year Blt: 1928 Eff Year Blt: 1928 Sq.Ft: 1624 % Complete: 100
 Desc: Multi Story above grade with basement Dimensions: RMV: 187760
 Func Obsc: 100 Econ %: 100 Other %: 100 Exception: 0 Adjust: Adjust RMV: 0

Floors

Type	Class	Display Group	Floor Size	Beds	Baths	Yr Blt	Eff Yr Blt	Inventory	Exception
First Floor	3 +	Finished	952	1	FB-1	1928	1928	KIT-, HVAC, FLOOR BATH - 1	Y N
Attic	3 +	Finished	672	0	0	1928	1928	HVAC	Y N
Basement	3 +	Unfinished	952	0	0	1928	1928		Y N

AW AVB

Accessories

Description	Class	Size SqFt	Eff Yr Blt	RMV	Quantity	Exception
ENCLOSED PORCH	3	168	1928	2873	1	Y N
YARD IMPROVEMENTS AVERAGE	3	1	1928	10978	1	Y N

NC

Improvements - Accessory Buildings

Bldg: 2 Code Area: 05558 Stat Class: 312 Year Blt: 1967 Eff Year Blt: 1967 Sq.Ft: 2520 % Complete: 100
 Desc: Loft Barn (LB) Dimensions: 70x36 RMV: 7850
 Func Obsc: 50 Econ %: 100 Other %: 100 Exception: 0 Adjust: Adjust RMV: 0

Floors

Type	Class	Display Group	Floor Size	Beds	Baths	Yr Blt	Eff Yr Blt	Inventory	Exception: Y N
Loft Barn	5	Finished	2520	0	0	1967	1967	FAIR	

NC

Accessories

Description	Class	Size SqFt	Eff Yr Blt	RMV	Quantity
No accessory data available					

Bldg: 3 Code Area: 05558 Stat Class: 355 Year Blt: 1967 Eff Year Blt: 1967 Sq.Ft: 1400 % Complete: 100
 Desc: Lean-to Heavy (LTH) Dimensions: 70x20 RMV: 1890
 Func Obsc: 100 Econ %: 100 Other %: 100 Exception: 0 Adjust: Adjust RMV: 0

Floors

Type	Class	Display Group	Floor Size	Beds	Baths	Yr Blt	Eff Yr Blt	Inventory	Exception: Y N
Lean-to Heavy Duty	4	Finished	1400	0	0	1967	1967		

NC

Accessories

Description	Class	Size SqFt	Eff Yr Blt	RMV	Quantity
No accessory data available					

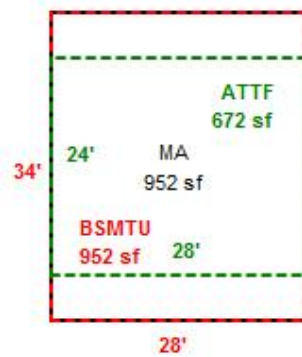
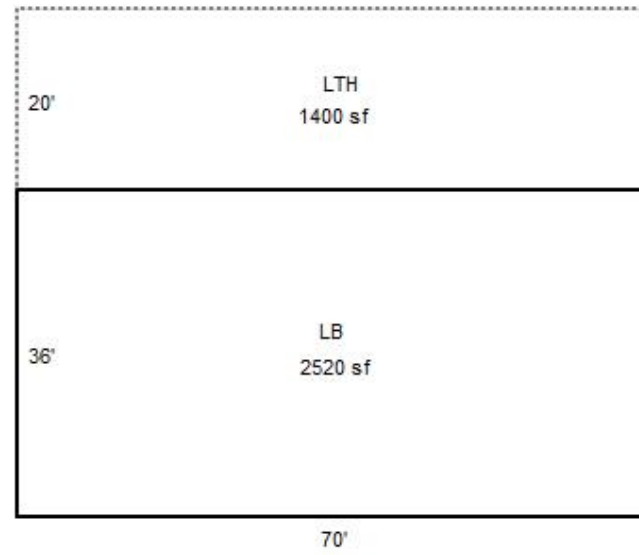

*Close 9-29-25
cycles 24*