

SKETCH/AREA TABLE ADDENDUM

SUBJECT INFO

File No.: 606739 Parcel No.: 083W11AA00200
 Property Address: 2327 STRONG HEIGHTS LN SE & UNIT A
 City: SALEM County: Marion State: OR ZipCode: 97302
 Owner:
 Client: Client Address:
 Appraiser Name: Inspection Date:

SKETCH

606739
083W11AA00200

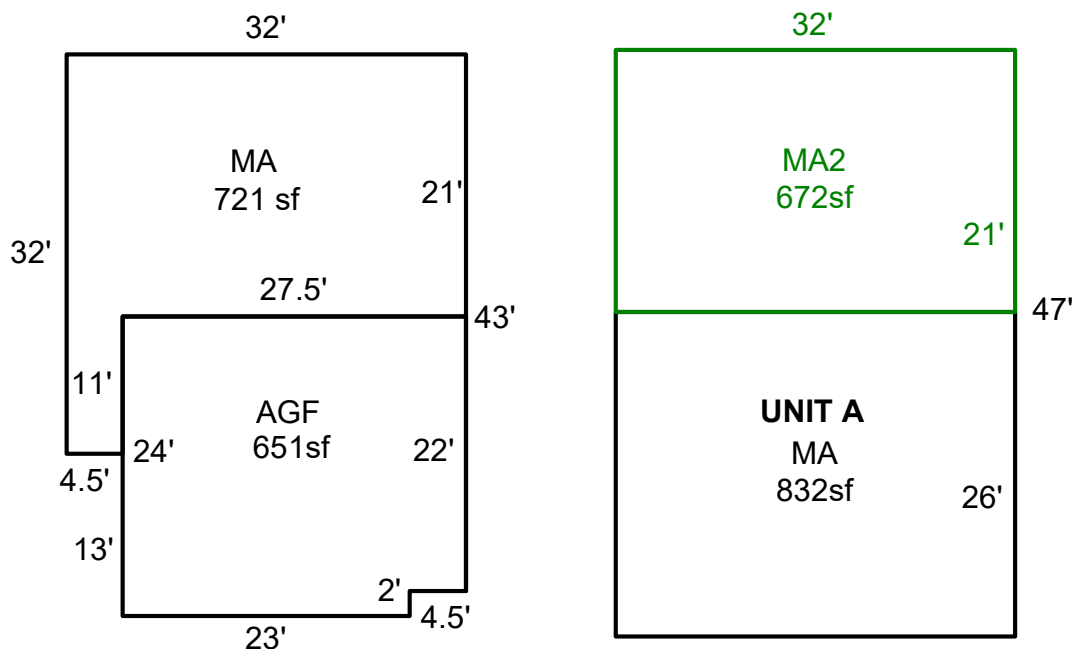

Sketch by ApexSketch

AREA CALCULATIONS SUMMARY						COMMENT TABLE 1	
Code	Description	Factor	Net Size	Perimeter	Net Totals		
GLA	MA	1.0	832.0	116.0		DRAWN BY CEHRLIN 1/13/23 UPDATED BY LK 9.19.23 UPDATED BY JT 11/14/23 UPDATED BY JT 12/8/23	
	MA	1.0	721.5	128.0	1553.5		
GLA2	MA2	1.0	672.0	106.0	672.0		
GAR	AGF	1.0	651.0	103.0	651.0		
						COMMENT TABLE 2	COMMENT TABLE 3
						8-1-23 TAG GM	
Net LIVABLE		cnt	3 (rounded)		2,226		