

SKETCH/AREA TABLE ADDENDUM

SUBJECT INFO

File No.: 611806 Parcel No.: 072W29CA14600
 Property Address: 4932 Dilling Ave NE
 City: Salem County: Marion State: OR ZipCode: 97301
 Owner:
 Client: Client Address:
 Appraiser Name: Inspection Date:

SKETCH

611806
072W29CA14600

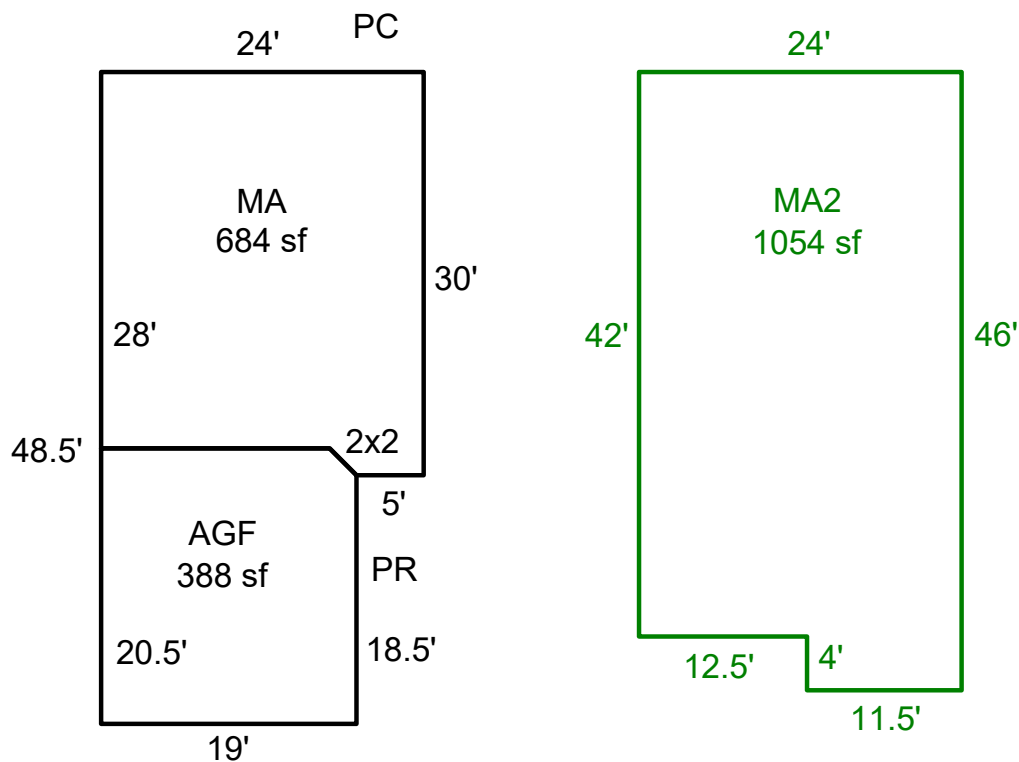

Sketch by ApexSketch

AREA CALCULATIONS SUMMARY						COMMENT TABLE 1	
Code	Description	Factor	Net Size	Perimeter	Net Totals		
GLA	MA	1.0	684.0	106.8	684.0	Drawn by AE 12.5.25	
GLA2	MA2	1.0	1054.0	140.0	1054.0		
GAR	AGF	1.0	387.5	77.8	387.5		
						COMMENT TABLE 2	COMMENT TABLE 3
Net LIVABLE		cnt	2	(rounded)	1,738		