

Summary

Lead Appr: _____ Clerk: **lak 12.16.25** Lead Clerk: _____ Appr: _____

Print Date: 11/6/2025

Acct ID: 127568 MTL: 072W29C000900P1 Date: **11/19/25** Appr: **02** Prop Class: 019 RMV Prop Class: 019

Situs: 148 47TH AVE NE SALEM, OR 97301 MaSaNh: 14 05 000 Unit: 141092 Year: 2026

Last Date Appraised: 01/30/2020 Appraiser: THERESA SWEARINGEN Tag: Y N Tag info: Last Sales Date: 07/30/2025 Roll Type: MS

Cycle Tag **Sales Verification** Other: _____ Inspection level: 1 2 **3** 4 LCB TTO INSP AV: 4330

RMV Land: 0 RMV Imp: 45620 RMV Total: 45620 MAV: 4330 MSAV: 0 SAV: 0

Comment: ROYAL MOBILE ESTATES, MS SERIAL # 26JVC5024C3S1065, X # X00136914, Home ID 207438, PERSONAL MS

Improvements - Residence / Manufactured Structures

90 to N/V 5/10

Bldg: 1	Code Area: 24620	Stat Class: 456	Year Blt: 1969	Eff Year Blt: 1986	Sq.Ft: 1128	% Complete: 100.00
Desc: MANUF STRUCT, CLASS 5, 24' WIDE DOUBLE			Dimensions: 47x24		RMV: 45620	
Func Obsc: 100	Econ %: 100	Other %: 100	Exception: 0	Adjust:	Adjust RMV: 0	Subtype: P

Floors

Type	Class	Display Group	Floor Size	Beds	Baths	Yr Blt	Eff Yr Blt	Inventory
First Floor	5	Finished	1128	3	FB-2	1969	1986	FP - 1, HVAC+, SKIRT, KIT-, BATH - 2, ROOF+ Exception: Y N

Accessories

Description	Class	Size SqFt	Eff Yr Blt	RMV	Quantity
DECK	5	90	1986	693	0 Exception: Y N
GARDEN SHED	5	80	1986	448	0 Exception: Y N
ROOF EXTENSION OR PATIO COVER	5	369	1986	3745	0 Exception: Y N



MLS
Fully Furnished
Motivated seller

W.M.
Viewing
original interior

BUILDING DIAGRAM [REDACTED] OUTBUILDINGS

ACCT NO: *M127568*

MAP NO:

TAX LOT:

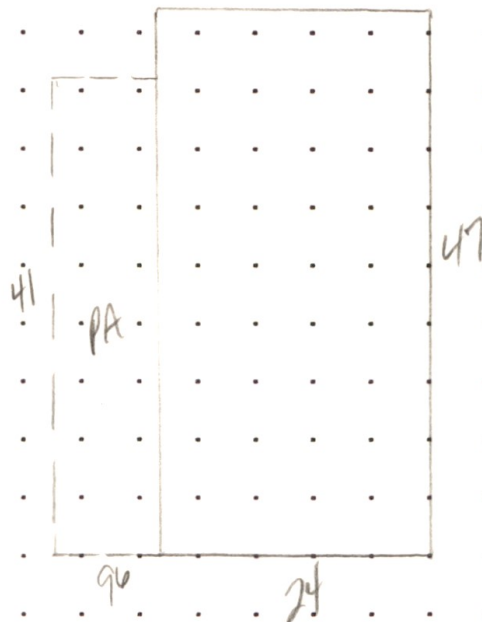

CALCULATIONS: $24 \times 47 = 1128 \text{ SF}$

SCALE: 1" = 20'

Royal Mobile Estates

MEASUREMENT VERIFIED		YR BLT: <i>69</i>	ADDRESS: <i>1480 47th Ave NE</i>	SALES	
DATE	BY	REMARKS:	BUILDER:	Date	Amt.
<i>8-2-85</i>	<i>65</i>		<i>Van Dyke</i>	<i>1-10-18</i>	<i>02 N.O.</i>
<i>6-16-94</i>	<i>DT/4</i>		<i>by Gurdan</i>		
<i>2-25-14</i>	<i>01/4</i>	<i>Adjnd. over</i>			



Marion County
OREGON
ASSESSOR'S OFFICE

Appraiser Sales Verification From

Primary Acct: 127568

MTL: 072W29C000900

MaSaNh/P.Class: 1405000/019

Appraiser: THERESA SWEARINGEN

MS Acct: 127568

Date Printed: 11/6/2025

Situs: 148 47TH AVE NE SALEM, OR 97301

Grantor:

MCDANIEL, MITZI

Grantee:

REPASKY, DIANNA

Sale ID:

Deed:

Accts In Sale:

Sale Date: 7/30/2025

Sale Price: 77000

Condition Code: 33

Tax Statement RMV

Land & OSD:

Imp:

Total: 55390

Ratio (Cert. Total RMV/Sale Price): 72

Attempt	Date/Time	Reason
1 st		
2 nd		

Contact: _____ Phone/email: _____

1. Was the property listed on the open market? Days: 85 MLS: 828665 Y N

2. Was property other than real estate included in the sale? Y N

Describe: _____ Est. \$: _____

3. Did the seller pay closing costs or make other concessions? \$ _____ Y N

4. Was the sale between related parties? (business or family) Y N

5. Was this a distressed sale? E.g. foreclosure, short, court order, etc... Y N

6. Condition at time of sale: | Poor | Fair | Avg. | Good | Exc. | Y N

Describe: _____

7. Have any improvements been made since the time of sale? Y N

If yes, describe: _____

Comments:

Appraiser: _____ Date: _____