

Summary

Lead Appr: \_\_\_\_\_ Clerk: \_\_\_\_\_ Lead Clerk: \_\_\_\_\_ Appr: \_\_\_\_\_

Print Date: 11/6/2025

Acct ID: 129852

MTL: 081W34AC00100P1

Date: 11/19/25

Appr: 02

Prop Class: 019

RMV Prop Class: 019

Situs: 340 NE CREST ST # 32 SUBLIMITY, OR 97385

MaSaNh: 17 05 000

Unit: 142010

Year: 2026

Last Date Appraised: 07/08/2015

Appraiser: THERESA SWEARINGEN

Tag: Y N

Tag info:

Owner: HELD, GREGORY ALLEN

Last Sales Date: 09/19/2025

Roll Type: MS

Cycle Tag Sales Verification

Other: \_\_\_\_\_

Inspection level: 1 2 3 4

LCB TTO INSP

AV: 19940

RMV Land: 0

RMV Imp: 30950

RMV Total: 30950

MAV: 19940

MSAV: 0

SAV: 0

Comment: SUBLIMITY MOBILE VILLAGE, SPACE #32, MS SERIAL # SF7579763, X # X00179447, PERSONAL MS

Improvements - Residence / Manufactured Structures

up date 64B - 5/0

Bldg: 1

Code Area: 29180

Stat Class: 456

Year Blt: 1981

Eff Year Blt: 1981

Sq.Ft: 768

% Complete: 100.00

Desc: MANUF STRUCT, CLASS 5, 24' WIDE DOUBLE

Dimensions: 32x24

RMV: 30950

Func Obsc: 100

Econ %: 100

Other %: 100

Exception: 0

Adjust:

Adjust RMV: 0

Subtype: P

Floors

Type	Class	Display Group	Floor Size	Beds	Baths	Yr Blt	Eff Yr Blt	Inventory
First Floor	5	Finished	768	2	FB-1	1981	1981	BATH - 1, HVAC+, ROOF+, SKIRT, KIT- Exception: Y N

Accessories

Description	Class	Size SqFt	Eff Yr Blt	RMV	Quantity	
DECK	5	108	1981	760	0	Exception: Y N
ENCLOSED PORCH	3	176	1981	1690	0	Exception: Y N
ROOF EXTENSION OR PATIO COVER	5	176	1981	1633	0	Exception: Y N



View: W.M.

# BUILDING DIAGRAM AND OUTBUILDINGS

ACCT NO: X179447

MAP NO:

TAX LOT:

M-129.852

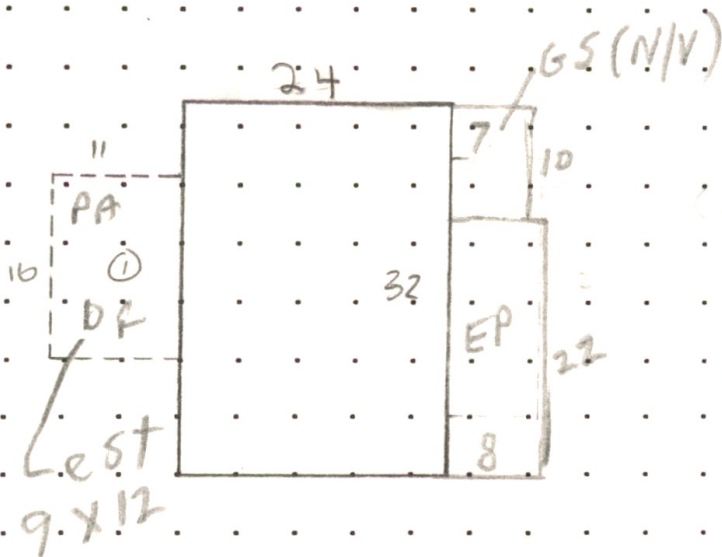

CALCULATIONS:  $24 \times 32 = 768 \text{ SF}$

SCALE: 1" = 20'

MEASUREMENT  
VERIFIED

YR BLT: 81

ADDRESS: SUBLIMITY VILL #32

SALES  
Date Amt.

DATE  
12/16/85  
3-18-93

BY #  
KK865  
KK865

REMARKS:  
NV

BUILDER: EMBASSY (Guerdon)

7-8-15 DT4 NV-cycle



**Marion County**  
OREGON  
ASSESSOR'S OFFICE

**Appraiser Sales Verification From**

Primary Acct: 129852

MTL: 081W34AC00100

MaSaNh/P.Class: 1705000/019

Appraiser: THERESA SWEARINGEN

MS Acct: 129852

Date Printed: 11/6/2025

Situs: 340 NE CREST ST # 32 SUBLIMITY, OR 97385

**Grantor:**

PARSONS, CLARENCE & PARSONS, JEAN

**Grantee:**

HELD, GREGORY ALLEN

**Sale ID:**

Tax Statement RMV

**Deed:**

Land & OSD:

**Accts In Sale:**

Imp:

Sale Date: 9/19/2025

Total: 38740

Sale Price: 25000

Ratio (Cert. Total RMV/Sale Price): 155

Condition Code: 00

Attempt	Date/Time	Reason
1 <sup>st</sup>		
2 <sup>nd</sup>		

Contact: Gregory Phone/email: \_\_\_\_\_

1. Was the property listed on the open market? Days: \_\_\_\_\_ MLS: \_\_\_\_\_ 4 sale by owner Y N

2. Was property other than real estate included in the sale? Y N

Describe: \_\_\_\_\_ Est. \$: \_\_\_\_\_

3. Did the seller pay closing costs or make other concessions? \$ \_\_\_\_\_ Y N

4. Was the sale between related parties? (business or family) Estate Y N

5. Was this a distressed sale? E.g. foreclosure, short, court order, etc... Y N

6. Condition at time of sale: | Poor | Fair | Avg. | Good | Exc. | Y N

Describe: \_\_\_\_\_

7. Have any improvements been made since the time of sale? Y N

If yes, describe: \_\_\_\_\_

\_\_\_\_\_

\_\_\_\_\_ Paint, Floors,

\_\_\_\_\_ Bath/Land

\_\_\_\_\_ Clanned

Comments:

\_\_\_\_\_

\_\_\_\_\_ over paid - Repairs costly

\_\_\_\_\_

Appraiser: 02 Date: 11/19/25