

Summary

Lead Appr: Clerk: **lak 12.16.25** Lead Clerk: Appr: **ts 12-22-25** Print Date: 11/6/2025

Acct ID: 331968 MTL: 041W34B001100P1 Date: **11/18/25** Appr: **07** Prop Class: 019 RMV Prop Class: 019

Situs: 3132 BASILIO DR HUBBARD, OR 97032 MaSaNh: 12 05 000 Unit: 331968 Year: 2026

Last Date Appraised: 09/18/2023 Appraiser: THERESA SWEARINGEN Tag: Y N Tag info: Last Sales Date: 08/20/2025 Roll Type: MS

Owner: RAMIREZ TELLO, MINERVA Cycle Tag **Sales Verification** Other: Inspection level: **2** 1 2 3 4 LCB TTO INSP AV: 8330

RMV Land: 0 RMV Imp: 28650 RMV Total: 28650 MAV: 8330 MSAV: 0 SAV: 0

Comment: 24-25: Cycle; L2 09.18.23 TS

Improvements - Residence / Manufactured Structures

Bldg: 1 Code Area: 15119 Stat Class: 454 Year Blt: 1972 Eff Year Blt: 1972 Sq.Ft: 854 % Complete: 100.00

Desc: MANUF STRUCT, CLASS 5, 14' WIDE SINGLE Dimensions: 61x14 RMV: 28650

Func Obsc: 100 Econ %: 100 Other %: 100 Exception: 0 Adjust: Adjust RMV: 0 Subtype: P

Floors

Type	Class	Display Group	Floor Size	Beds	Baths	Yr Blt	Eff Yr Blt	Inventory	Exception: Y N
First Floor	5	Finished	854	2	FB-1	1972	1972	BATH - 1, HVAC, SKIRT, ROOF+, KIT-, FP - 1	Y N

Accessories

Description	Class	Size SqFt	Eff Yr Blt	RMV	Quantity	Exception: Y N
ENCLOSED PORCH	3	114	1972	2183	0	Y N



Segment	PR	DW
Class	AGF	
Dimensions/Size	108	108
Foundation		
Exterior Wall		
Interior Finish		
Roof Cover		
Roof Style		
Flooring		
Plumbing		
Heat		
Electric		
Misc.		
Year Built		
Eff. Year	1972	1972
Condition		
% Complete		
Lump Sum		
Exception Code	5/0	5/0

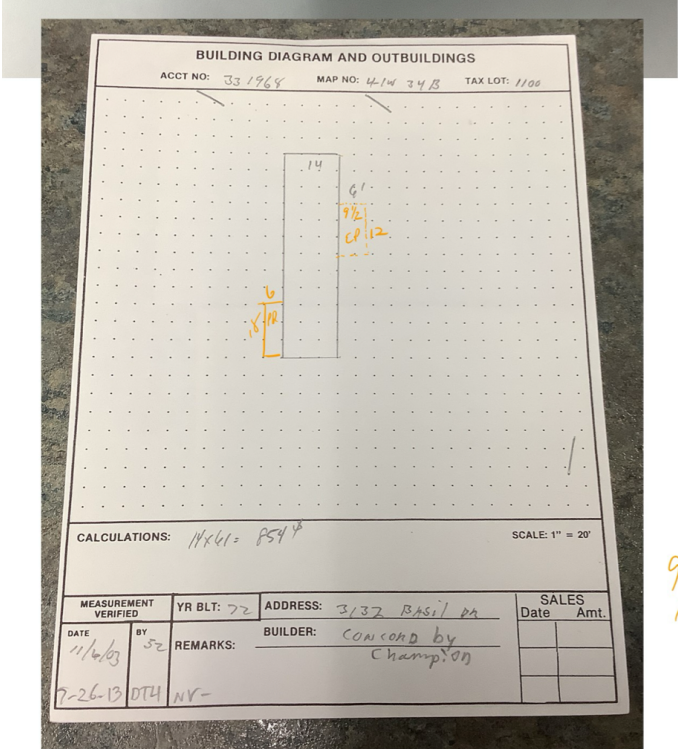

2-8-23
w/cycle
#2

only F. wind, only
V. wind.
HP.



Marion County
OREGON
ASSESSOR'S OFFICE

Appraiser Sales Verification From

Primary Acct: 331968

MTL: 041W34B001100

MaSaNh/P.Class: 1205000/019

Appraiser: THERESA SWEARINGEN

MS Acct: 331968

Date Printed: 11/6/2025

Situs: 3132 BASILIO DR HUBBARD, OR 97032

Grantor:
CORDERO ROMERO, ABRAHAM &

Grantee:
RAMIREZ TELLO, MINERVA

Sale ID: Tax Statement RMV
Deed: Land & OSD:
Accts In Sale: Imp:
Sale Date: 8/20/2025 **Total:** 36070
Sale Price: 10000 **Ratio** (Cert. Total RMV/Sale Price): 361
Condition Code: 00 *620*

Attempt	Date/Time	Reason
1 st	<i>11/18/25 9:50</i>	<i>LCB</i>
2 nd		

Contact: _____ Phone/email: _____

1. Was the property listed on the open market? Days: _____ MLS: _____ Y N
2. Was property other than real estate included in the sale? Y N
Describe: _____ Est. \$: _____
3. Did the seller pay closing costs or make other concessions? \$ _____ Y N
4. Was the sale between related parties? (business or family) Y N
5. Was this a distressed sale? E.g. foreclosure, short, court order, etc... Y N
6. Condition at time of sale: | Poor | Fair | Avg. | Good | Exc. | Y N
Describe: _____

7. Have any improvements been made since the time of sale? Y N
If yes, describe: _____

Comments:

Appraiser: _____ Date: _____