

SKETCH/AREA TABLE ADDENDUM

SUBJECT INFO

File No.: 611779 Parcel No.: 072W29CA11900
 Property Address: 4950 Marr Ave NE
 City: Salem County: Marion State: OR ZipCode: 97301
 Owner:
 Client: Client Address:
 Appraiser Name: Inspection Date:

SKETCH

611779
072W29CA11900

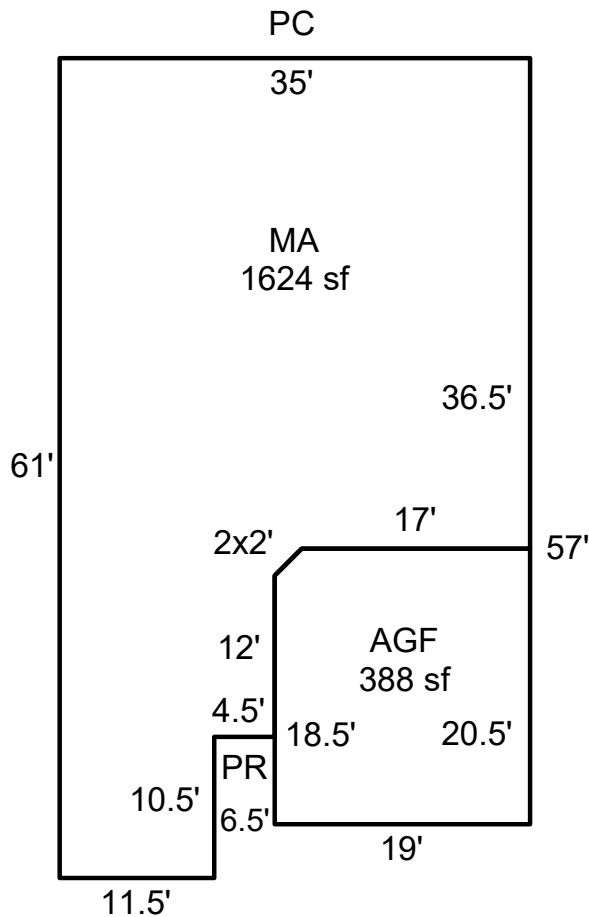

Sketch by ApexSketch

AREA CALCULATIONS SUMMARY

Code	Description	Factor	Net Size	Perimeter	Net Totals
GLA	MA	1.0	1624.3	190.8	1624.3
GAR	AGF	1.0	387.5	77.8	387.5

COMMENT TABLE 1

Drawn by AE 5.16.25
Updated by AE 12.19.25

COMMENT TABLE 2

12/16/25 Tags ZH

COMMENT TABLE 3

Net LIVABLE cnt 1 (rounded) 1,624