

SKETCH/AREA TABLE ADDENDUM

SUBJECT INFO

File No.: 611781	Parcel No.: 072W29CA12100
Property Address: 4972 Marr Ave NE	
City: Salem	County: Marion
State: OR	ZipCode: 97301
Owner:	
Client:	
Appraiser Name:	Client Address:
Inspection Date:	

SKETCH

611781
072W29CA12100

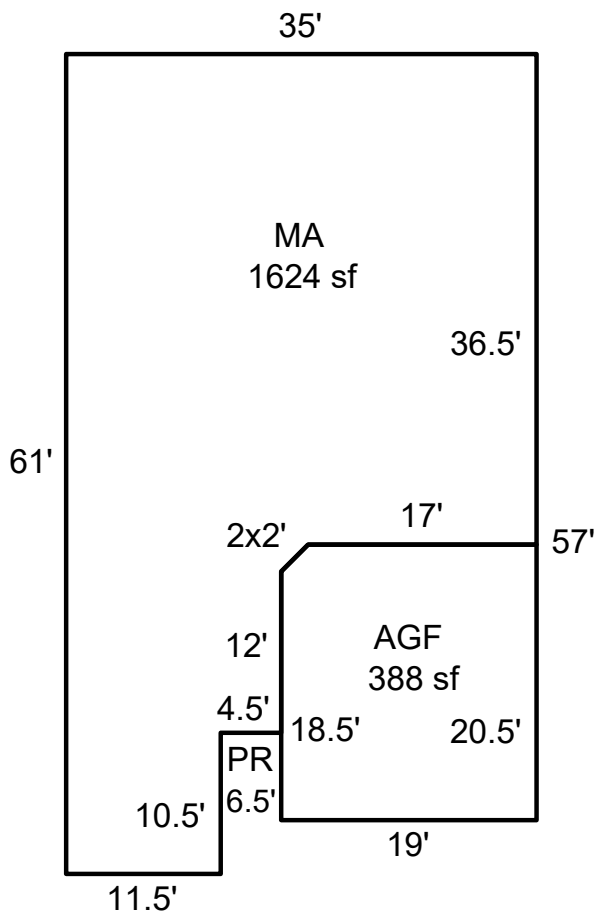

Sketch by ApexSketch

AREA CALCULATIONS SUMMARY

Code	Description	Factor	Net Size	Perimeter	Net Totals
GLA	MA	1.0	1624.3	190.8	1624.3
GAR	AGF	1.0	387.5	77.8	387.5

COMMENT TABLE 1

Drawn by AE 5.16.25
Updated by AE 12.19.25

COMMENT TABLE 2

12/16/25 Tags ZH

COMMENT TABLE 3

Net LIVABLE	cnt	1	(rounded)	1,624
-------------	-----	---	-----------	-------