

# SKETCH/AREA TABLE ADDENDUM

## SUBJECT INFO

File No.: 611783		Parcel No.: 072W29CA12300	
Property Address: 4984 Marr Ave NE			
City: Salem	County: Marion	State: OR	ZipCode: 97301
Owner:			
Client:		Client Address:	
Appraiser Name:		Inspection Date:	

## SKETCH

**611783**  
**072W29CA12300**

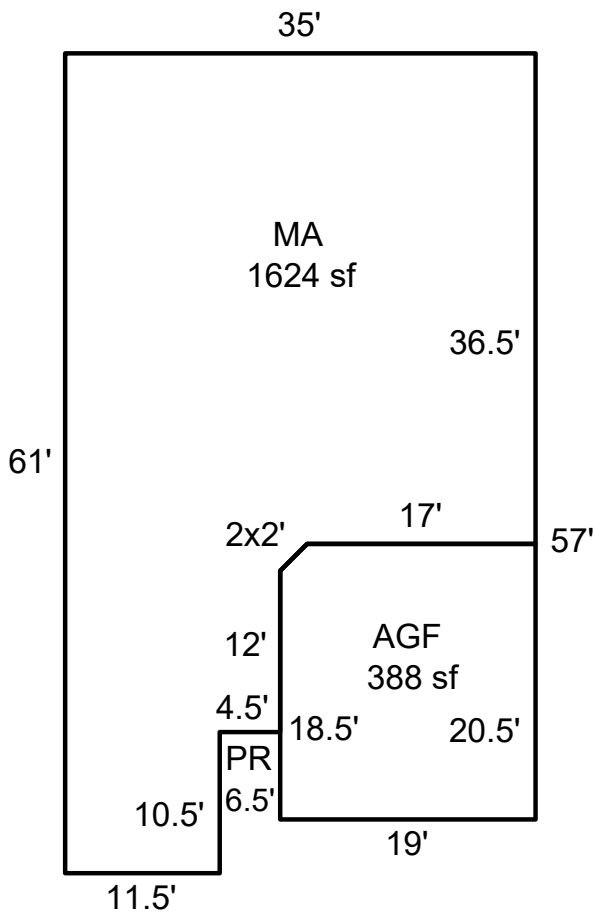

Sketch by ApexSketch

### AREA CALCULATIONS SUMMARY

Code	Description	Factor	Net Size	Perimeter	Net Totals
GLA	MA	1.0	1624.3	190.8	1624.3
GAR	AGF	1.0	387.5	77.8	387.5

### COMMENT TABLE 1

Drawn by AE 5.16.25  
Updated by AE 12.19.25

### COMMENT TABLE 2

12/16/25 Tags ZH

### COMMENT TABLE 3

Net LIVABLE                      cnt                      1                      (rounded)                      1,624