

Summary Lead Appr: WW 11/25 Clerk: \_\_\_\_\_ Lead Clerk: \_\_\_\_\_ Appr: MDL Inpct Print Date: 9/26/2025

Acct ID: 530700 MTL: 082W220000900 Date: 11/5/25 Appr: MDL Prop Class: 551 RMV Prop Class: 501  
 Situs: 6883 70TH AVE SE SALEM OR 97317 MaSaNh: 07 06 000 Unit: 69484 Year: 2025

Last Date Appraised: 12/16/2024 Appraiser: MATT LORD Tag: Y N Tag info: 2026 - Tags/Permit (Completion)  
 Owner: GOIN, ROBERT DAVID & PETERSON, KRISTIN L Last Sales Date: 10/31/2017 Roll Type: R  
 Cycle Tag Sales Verification Other: \_\_\_\_\_ Inspection level: 1 2 3 4 LCB TTO INSP AV: 352780  
 RMV Land: 505110 RMV Imp: 591920 RMV Total: 1097030 MAV: 316700 MSAV: 36080 SAV: 71195  
 Comment: 25-26: L3 MDL 12.03.24 TAG 23-006842 DOB5  
 24-25: L2 MDL 02.06.23 TAG

CWO 12/5/25

Notations

26-27: GB 100%

RP/MS	Code	Description
RP	ZONED	FARM EFU ZONED

OSDs

Count	Code	Description	RMV	Code Area	Exception
1	SAA	SA OSD - AVERAGE	50000	05598	0

Land

Site: 2 Code Area: 05598 Size: 1.00 Acres Use Code: 005 Zone: REST SAV Use: 011 Exception: 0  
 Class: 2BDSS Value Source: Farm Homesite Description: TWO BENCH DRY SOUTH SPECIAL RMV: 20440 Exception: Y N  
 Adjustment(s): GSOIL Fire Patrol: Description:  
 Comments: Liability year - 2009

09-10: GW39 changed land type per Excel analysis

Site: 3 Code Area: 05598 Size: 21.26 Acres Use Code: 005 Zone: REST SAV Use: 011 Exception: 0  
 Class: 2BDSS Value Source: Farm Use - EFU Description: TWO BENCH DRY SOUTH SPECIAL RMV: 434670 Exception: Y N  
 Adjustment(s): GSOIL Fire Patrol: Description:  
 Comments: Liability year - 1976

Improvements - Residence / Manufactured Structures

Bldg: 1 Code Area: 05598 Stat Class: 141 Year Blt: 1967 Eff Year Blt: 1986 Sq.Ft: 1772 % Complete: 100.00  
 Desc: One Story Only Dimensions: RMV: 373130  
 Func Obsc: 100 Econ %: 100 Other %: 100 Exception: 0 Adjust: Adjust RMV: 0

Floors

Type	Class	Display Group	Floor Size	Beds	Baths	Yr Blt	Eff Yr Blt	Inventory	Exception
First Floor	4	Finished	1772	3	FB-1	1967	1986	HVAC, FP - 1, ROOF, KIT-, BATH - 1	Y N
Garage Detached	4	Finished	960	0	FB-1	2006	2006	ROOF, BATH - 1	Y N

Accessories

Description	Class	Size SqFt	Eff Yr Blt	RMV	Quantity	Exception
YARD IMPROVEMENTS GOOD	4	1	1986	34668	1	Y N

Improvements - Accessory Buildings

Bldg: 2 Code Area: 05598 Stat Class: 316 Year Blt: 2005 Eff Year Blt: 2005 Sq.Ft: 11520 % Complete: 100.00  
 Desc: Arenas (HA) Dimensions: 96x120 RMV: 114450  
 Func Obsc: 100 Econ %: 100 Other %: 100 Exception: 0 Adjust: Adjust RMV: 0

Floors

Type	Class	Display Group	Floor Size	Beds	Baths	Yr Blt	Eff Yr Blt	Inventory	Exception
Horse Arena	5	Finished	11520	0	0	2005	2005	FAIR	Y N

Accessories

No accessory data available

Bldg: 3 Code Area: 05598 Stat Class: 353 Year Blt: 2005 Eff Year Blt: 2010 Sq.Ft: 864 % Complete: 100.00  
 Desc: Machine Shed (MS) Dimensions: 24x36 RMV: 12010  
 Func Obsc: 100 Econ %: 100 Other %: 100 Exception: 0 Adjust: Adjust RMV: 0

Floors

Type	Class	Display Group	Floor Size	Beds	Baths	Yr Blt	Eff Yr Blt	Inventory	Exception
Machine Shed	5	Finished	864	0	0	2005	2010	AVG	Y N

Accessories

Description	Class	Size SqFt	Eff Yr Blt	RMV	Quantity
No accessory data available					

Bldg: 5 Code Area: 05598 Stat Class: 353 Year Blt: 2012 Eff Year Blt: 2012 Sq.Ft: 2304 % Complete: 100.00  
 Desc: Machine Shed (MS) Dimensions: 32x72 RMV: 25250  
 Func Obsc: 100 Econ %: 100 Other %: 100 Exception: 0 Adjust: Adjust RMV: 0

**Floors**

Type	Class	Display Group	Floor Size	Beds	Baths	Yr Blt	Eff Yr Blt	Inventory
Machine Shed	5	Finished	2304	0	0	2012	2012	FAIR Exception: Y N

**Accessories**

Description	Class	Size SqFt	Eff Yr Blt	RMV	Quantity
No accessory data available					

Bldg: 6 Code Area: 05598 Stat Class: 353 Year Blt: 2012 Eff Year Blt: 2012 Sq.Ft: 1920 % Complete: 100.00  
 Desc: Machine Shed (MS) Dimensions: 32x60 RMV: 21550  
 Func Obsc: 100 Econ %: 100 Other %: 100 Exception: 0 Adjust: Adjust RMV: 0

**Floors**

Type	Class	Display Group	Floor Size	Beds	Baths	Yr Blt	Eff Yr Blt	Inventory
Machine Shed	5	Finished	1920	0	0	2012	2012	FAIR Exception: Y N

**Accessories**

Description	Class	Size SqFt	Eff Yr Blt	RMV	Quantity
No accessory data available					

Bldg: 7 Code Area: 05598 Stat Class: 355 Year Blt: 2014 Eff Year Blt: 2014 Sq.Ft: 432 % Complete: 100.00  
 Desc: Lean-to Heavy (LTH) Dimensions: 18x24 RMV: 2330  
 Func Obsc: 100 Econ %: 100 Other %: 100 Exception: 0 Adjust: Adjust RMV: 0

**Floors**

Type	Class	Display Group	Floor Size	Beds	Baths	Yr Blt	Eff Yr Blt	Inventory
Lean-to Heavy Duty	4	Finished	432	0	0	2014	2014	Exception: Y N

**Accessories**

Description	Class	Size SqFt	Eff Yr Blt	RMV	Quantity
No accessory data available					

Bldg: 8 Code Area: 05598 Stat Class: 355 Year Blt: 2014 Eff Year Blt: 2014 Sq.Ft: 432 % Complete: 100.00  
 Desc: Lean-to Heavy (LTH) Dimensions: 18x24 RMV: 2330  
 Func Obsc: 100 Econ %: 100 Other %: 100 Exception: 0 Adjust: Adjust RMV: 0

**Floors**

Type	Class	Display Group	Floor Size	Beds	Baths	Yr Blt	Eff Yr Blt	Inventory
Lean-to Heavy Duty	4	Finished	432	0	0	2014	2014	Exception: Y N

**Accessories**

Description	Class	Size SqFt	Eff Yr Blt	RMV	Quantity
No accessory data available					

Bldg: 9 Code Area: 05598 Stat Class: 321 Year Blt: 2014 Eff Year Blt: 2014 Sq.Ft: 240 % Complete: 100.00  
 Desc: Hay Cover (HC) Dimensions: 12x20 RMV: 1710  
 Func Obsc: 100 Econ %: 100 Other %: 100 Exception: 0 Adjust: Adjust RMV: 0

**Floors**

Type	Class	Display Group	Floor Size	Beds	Baths	Yr Blt	Eff Yr Blt	Inventory
Hay Cover	5	Finished	240	0	0	2014	2014	FAIR Exception: Y N

**Accessories**

Description	Class	Size SqFt	Eff Yr Blt	RMV	Quantity
No accessory data available					

Bldg: 10 Code Area: 05598 Stat Class: 355 Year Blt: 2010 Eff Year Blt: 2010 Sq.Ft: 432 % Complete: 100.00  
 Desc: Lean-to Heavy (LTH) Dimensions: 12x36 RMV: 2100  
 Func Obsc: 100 Econ %: 100 Other %: 100 Exception: 0 Adjust: Adjust RMV: 0

**Floors**

Type	Class	Display Group	Floor Size	Beds	Baths	Yr Blt	Eff Yr Blt	Inventory
Lean-to Heavy Duty	4	Finished	432	0	0	2010	2010	Exception: Y N

**Accessories**

Description	Class	Size SqFt	Eff Yr Blt	RMV	Quantity
No accessory data available					

Bldg: 11 Code Area: 05598 Stat Class: 353 Year Blt: 2005 Eff Year Blt: 2005 Sq.Ft: 864 % Complete: 100.00

Desc: Machine Shed (MS)

Dimensions: RMV: 12010

Func Obsc: 100

Econ %: 100

Other %: 100

Exception: 0

Adjust:

Adjust RMV: 0

**Floors**

**Type Class Display Group Floor Size Beds Baths Yr Blt Eff Yr Blt Inventory**

Machine Shed 5 Finished 864 0 0 2005 2010 AVG Exception: Y N

**Accessories**

**Description Class Size SqFt Eff Yr Blt RMV Quantity**

No accessory data available

Bldg: 12 Code Area: 05598 Stat Class: 321 Year Blt: Eff Year Blt: 2020 Sq.Ft: 336 % Complete: 100.00

Desc: Hay Cover (HC)

Dimensions: 24x14 RMV: 2760

Func Obsc: 100

Econ %: 100

Other %: 100

Exception: 0

Adjust:

Adjust RMV: 0

**Floors**

**Type Class Display Group Floor Size Beds Baths Yr Blt Eff Yr Blt Inventory**

Hay Cover 5 Finished 336 0 0 0 2020 FAIR Exception: Y N

**Accessories**

**Description Class Size SqFt Eff Yr Blt RMV Quantity**

No accessory data available

Bldg: 13 Code Area: 05598 Stat Class: 321 Year Blt: Eff Year Blt: 2020 Sq.Ft: 504 % Complete: 100.00

Desc: Hay Cover (HC)

Dimensions: 36x14 RMV: 4130

Func Obsc: 100

Econ %: 100

Other %: 100

Exception: 0

Adjust:

Adjust RMV: 0

**Floors**

**Type Class Display Group Floor Size Beds Baths Yr Blt Eff Yr Blt Inventory**

Hay Cover 5 Finished 504 0 0 0 2020 FAIR Exception: Y N

**Accessories**

**Description Class Size SqFt Eff Yr Blt RMV Quantity**

No accessory data available

Bldg: 14 Code Area: 05598 Stat Class: 351 Year Blt: 2024 Eff Year Blt: 2024 Sq.Ft: 1296 % Complete: 65.00

Desc: General Purpose Building (GB)

Dimensions: 36x36 RMV: 18160

Func Obsc: 100

Econ %: 100

Other %: 100

Exception: 0

Adjust:

Adjust RMV: 0

100

**Floors**

**Type Class Display Group Floor Size Beds Baths Yr Blt Eff Yr Blt Inventory**

General Purpose Bldg 5 Finished 1296 0 0 2024 2024 FAIR Exception: Y N

**Accessories**

**Description Class Size SqFt Eff Yr Blt RMV Quantity**

No accessory data available

**Farm Notes**

2025FARM

1/8/25: Inspected by CWO L4 during tags farm use ok - Equine facility

# SKETCH/AREA TABLE ADDENDUM

## SUBJECT INFO

File No.: 530700 Parcel No.: 082W22 00900  
 Property Address: 6883 70TH AV SE  
 City: SALEM County: MARION State: OR ZipCode: 97317  
 Owner:  
 Client: Client Address:  
 Appraiser Name: Inspection Date:

## SKETCH

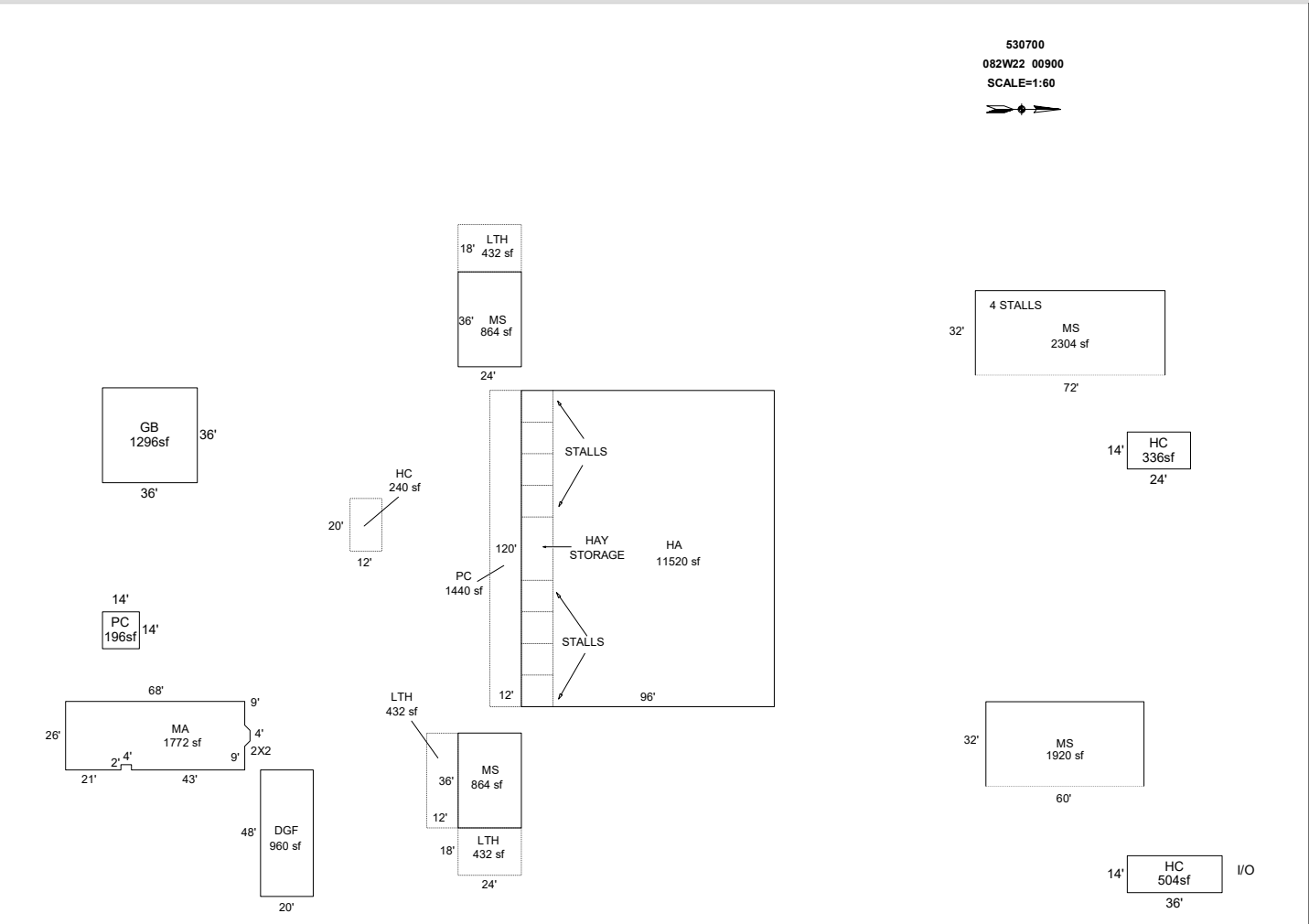

Sketch by ApexSketch

### AREA CALCULATIONS SUMMARY

Code	Description	Factor	Net Size	Perimeter	Net Totals
GBA1	HA	1.0	11520.0	432.0	
	LTH	1.0	432.0	84.0	
	LTH	1.0	432.0	84.0	
	LTH	1.0	432.0	96.0	
	HC	1.0	240.0	64.0	
	MS	1.0	2304.0	208.0	
	MS	1.0	1920.0	184.0	
	HC	1.0	336.0	76.0	
	HC	1.0	504.0	100.0	
	GB	1.0	1296.0	144.0	
	PC	1.0	196.0	56.0	19612.0
GLA1	MA	1.0	1772.0	193.7	
	MS	1.0	864.0	120.0	
GAR	MS	1.0	864.0	120.0	3500.0
	DGF	1.0	960.0	136.0	960.0
P/P	PC	1.0	1440.0	264.0	1440.0
	Net LIVABLE	cnt	0	(rounded)	3,500
	Net BUILDING	cnt	11	(rounded)	19,612

### COMMENT TABLE 1

DRAWN BY JRONDEMA 11/12/15  
 UPDATED BY JRONDEMA 2/1/18  
 UPDATED BY CLOBERG 12/23/24

### COMMENT TABLE 2

MDL 12/03/24

### COMMENT TABLE 3

TAGS L2

Summary Lead Appr: **WW 12.30.24** Clerk: \_\_\_\_\_ Lead Clerk: \_\_\_\_\_ Appr: **MDL Inpt** Print Date: 9/26/2024

Acct ID: 530700 MTL: 082W220000900 Date: **12/3/24** Appr: **MDL** Prop Class: 551 RMV Prop Class: 501  
Situs: 6883 70TH AVE SE SALEM OR 97317 MaSaNh: 07 06 000 Unit: 69484 Year: **2024**  
**2025**

Last Date Appraised: 02/06/2023 Appraiser: MATT LORD Retag: **(Y)** N Tag info: 2025 - NEW CONSTRUCTION (Outbuilding)

Owner: GOIN, ROBERT DAVID & PETERSON, KRISTIN L Roll Type: R

Cycle **(Tag)** Sales Verification Other: \_\_\_\_\_ Inspection level: 1 **(2)** 3 4 LCB TTO INSP AV: 339121

RMV Land: 408780 RMV Imp: 586070 RMV Total: 994850 MAV: 307480 MSAV: 31641 SAV: 63524

Comment: 24-25: L2 MDL 2.6.23 TAG **23-006842 LB 36436**

Notations **25-26 LB 65% complete**

RP/MS	Code	Description
RP	ZONED	FARM EFU ZONED

OSDs

Count	Code	Description	RMV	Code Area	Exception
1	SAA	SA OSD - AVERAGE	45000	05598	0

Land **✓** **1/8/25 CWO farm use ok - Equines**

Site: 2 Code Area: 05598 Size: 1.00 Acres Use Code: 005 Zone: REST SAV Use: 011 Exception: 0  
Class: 2BDS Value Source: Farm Homesite Description: TWO BENCH DRY SOUTH SPECIAL RMV: 16350 Exception: Y N  
S

Adjustment(s): GSOIL Fire Patrol: Description:  
Comments: Liability year - 2009 / //09-10: GW39 changed land type per Excel analysis// 560190

Site: 3 Code Area: 05598 Size: 11.70 Acres Use Code: 005 Zone: REST SAV Use: 011 Exception: 0  
Class: 2BDS Value Source: Farm Use - EFU Description: TWO BENCH DRY SOUTH SPECIAL RMV: 191200 Exception: Y N  
S

Adjustment(s): GSOIL Fire Patrol: Description:  
Comments: Liability year - 1976 / 00560190 06-07: F05-0557 COMBINES R30256 INTO R30700; R30257 INTO R337120 (WHICH CREATES THIS ACCT). R30697 ALSO AFFECTED.

Site: 4 Code Area: 05598 Size: 9.56 Acres Use Code: 005 Zone: REST SAV Use: 011 Exception: 0  
Class: 2HD Value Source: Farm Use - EFU Description: TWO HILL DRY RMV: 156230 Exception: Y N

Adjustment(s): GSOIL Fire Patrol: Description:  
Comments: Liability year - 1976 / 00560190 06-07: F05-0557 COMBINES R30256 INTO R30700; R30257 INTO R337120 (WHICH CREATES THIS ACCT). R30697 ALSO AFFECTED.

Improvements - Residence / Manufactured Structures

Bldg: 1 Code Area: 05598 Stat Class: 141 Year Blt: 1967 Eff Year Blt: 1986 Sq.Ft: 1772 % Complete: 100  
Desc: One Story Only Dimensions: RMV: 377730  
Func Obsc: 100 Econ %: 100 Other %: 100 Exception: 0 Adjust: Adjust RMV: 0

Floors

Type	Class	Display Group	Floor Size	Beds	Baths	Yr Blt	Eff Yr Blt	Inventory	Exception
First Floor	4	Finished	1772	3	FB-1	1967	1986	BATH - 1, KIT-, HVAC, FP - 1, ROOF	Y N
Garage Detached	4	Finished	960	0	FB-1	2006	2006	BATH - 1, ROOF	Y N

Accessories

Description	Class	Size SqFt	Eff Yr Blt	RMV	Quantity	Exception
YARD IMPROVEMENTS GOOD	4	1	1986	30504	1	Y N

Bldg: 4 Code Area: 05598 Stat Class: 108 Year Blt: 2005 Eff Year Blt: 2005 Sq.Ft: 0 % Complete: 100  
Desc: Residential Other Improvements Dimensions: RMV: 8790  
Func Obsc: 100 Econ %: 100 Other %: 100 Exception: 0 Adjust: Adjust RMV: 0

Floors

Type	Class	Display Group	Floor Size	Beds	Baths	Yr Blt	Eff Yr Blt	Inventory
No floor data available								

Accessories

Description	Class	Size SqFt	Eff Yr Blt	RMV	Quantity	Exception
<b>PATIO</b> <b>YI</b>	1	1440	2005	7207	1	Y N

Improvements - Accessory Buildings

Bldg: 2 Code Area: 05598 Stat Class: 316 Year Blt: 2005 Eff Year Blt: 2005 Sq.Ft: 11520 % Complete: 100  
Desc: Arenas (HA) Dimensions: 96x120 RMV: 118150  
Func Obsc: 100 Econ %: 100 Other %: 100 Exception: 0 Adjust: Adjust RMV: 0

Floors

Type	Class	Display Group	Floor Size	Beds	Baths	Yr Blt	Eff Yr Blt	Inventory	
Horse Arena	5	Finished	11520	0	0	2005	2005	FAIR	Exception: Y N

**Accessories**

Description	Class	Size SqFt	Eff Yr Blt	RMV	Quantity
No accessory data available					

Bldg: 3 Code Area: 05598 Stat Class: 353 Year Blt: 2005 Eff Year Blt: 2010 Sq.Ft: 864 % Complete: 100  
 Desc: Machine Shed (MS) Dimensions: 24x36 RMV: 12340  
 Func Obsc: 100 Econ %: 100 Other %: 100 Exception: 0 Adjust: Adjust RMV: 0

**Floors**

Type	Class	Display Group	Floor Size	Beds	Baths	Yr Blt	Eff Yr Blt	Inventory	
Machine Shed	5	Finished	864	0	0	2005	2010	AVG	Exception: Y N

**Accessories**

Description	Class	Size SqFt	Eff Yr Blt	RMV	Quantity
No accessory data available					

Bldg: 5 Code Area: 05598 Stat Class: 353 Year Blt: 2012 Eff Year Blt: 2012 Sq.Ft: 2304 % Complete: 100  
 Desc: Machine Shed (MS) Dimensions: 32x72 RMV: 25910  
 Func Obsc: 100 Econ %: 100 Other %: 100 Exception: 0 Adjust: Adjust RMV: 0

**Floors**

Type	Class	Display Group	Floor Size	Beds	Baths	Yr Blt	Eff Yr Blt	Inventory	
Machine Shed	5	Finished	2304	0	0	2012	2012	FAIR	Exception: Y N

**Accessories**

Description	Class	Size SqFt	Eff Yr Blt	RMV	Quantity
No accessory data available					

Bldg: 6 Code Area: 05598 Stat Class: 353 Year Blt: 2012 Eff Year Blt: 2012 Sq.Ft: 1920 % Complete: 100  
 Desc: Machine Shed (MS) Dimensions: 32x60 RMV: 22120  
 Func Obsc: 100 Econ %: 100 Other %: 100 Exception: 0 Adjust: Adjust RMV: 0

**Floors**

Type	Class	Display Group	Floor Size	Beds	Baths	Yr Blt	Eff Yr Blt	Inventory	
Machine Shed	5	Finished	1920	0	0	2012	2012	FAIR	Exception: Y N

**Accessories**

Description	Class	Size SqFt	Eff Yr Blt	RMV	Quantity
No accessory data available					

Bldg: 7 Code Area: 05598 Stat Class: 355 Year Blt: 2014 Eff Year Blt: 2014 Sq.Ft: 432 % Complete: 100  
 Desc: Lean-to Heavy (LTH) Dimensions: 18x24 RMV: 2390  
 Func Obsc: 100 Econ %: 100 Other %: 100 Exception: 0 Adjust: Adjust RMV: 0

**Floors**

Type	Class	Display Group	Floor Size	Beds	Baths	Yr Blt	Eff Yr Blt	Inventory	
Lean-to Heavy Duty	4	Finished	432	0	0	2014	2014		Exception: Y N

**Accessories**

Description	Class	Size SqFt	Eff Yr Blt	RMV	Quantity
No accessory data available					

Bldg: 8 Code Area: 05598 Stat Class: 355 Year Blt: 2014 Eff Year Blt: 2014 Sq.Ft: 432 % Complete: 100  
 Desc: Lean-to Heavy (LTH) Dimensions: 18x24 RMV: 2390  
 Func Obsc: 100 Econ %: 100 Other %: 100 Exception: 0 Adjust: Adjust RMV: 0

**Floors**

Type	Class	Display Group	Floor Size	Beds	Baths	Yr Blt	Eff Yr Blt	Inventory	
Lean-to Heavy Duty	4	Finished	432	0	0	2014	2014		Exception: Y N

**Accessories**

Description	Class	Size SqFt	Eff Yr Blt	RMV	Quantity
No accessory data available					

Bldg: 9 Code Area: 05598 Stat Class: 321 Year Blt: 2014 Eff Year Blt: 2014 Sq.Ft: 240 % Complete: 100  
 Desc: Hay Cover (HC) Dimensions: 12x20 RMV: 1750  
 Func Obsc: 100 Econ %: 100 Other %: 100 Exception: 0 Adjust: Adjust RMV: 0

**Floors**

Type	Class	Display Group	Floor Size	Beds	Baths	Yr Blt	Eff Yr Blt	Inventory	
Hay Cover	5	Finished	240	0	0	2014	2014	FAIR	Exception: Y N

**Accessories**

Description	Class	Size SqFt	Eff Yr Blt	RMV	Quantity
No accessory data available					

Bldg: 10 Code Area: 05598 Stat Class: 355 Year Blt: 2010 Eff Year Blt: 2010 Sq.Ft: 432 % Complete: 100  
 Desc: Lean-to Heavy (LTH) Dimensions: 12x36 RMV: 2160  
 Func Obsc: 100 Econ %: 100 Other %: 100 Exception: 0 Adjust: Adjust RMV: 0

**Floors**

Type	Class	Display Group	Floor Size	Beds	Baths	Yr Blt	Eff Yr Blt	Inventory	
Lean-to Heavy Duty	4	Finished	432	0	0	2010	2010		Exception: Y N

**Accessories**

Description	Class	Size SqFt	Eff Yr Blt	RMV	Quantity
No accessory data available					

Bldg: 11 Code Area: 05598 Stat Class: 353 Year Blt: 2005 Eff Year Blt: 2005 Sq.Ft: 864 % Complete: 100  
 Desc: Machine Shed (MS) Dimensions: RMV: 12340  
 Func Obsc: 100 Econ %: 100 Other %: 100 Exception: 0 Adjust: Adjust RMV: 0

**Floors**

Type	Class	Display Group	Floor Size	Beds	Baths	Yr Blt	Eff Yr Blt	Inventory	
Machine Shed	5	Finished	864	0	0	2005	2010	AVG	Exception: Y N

**Accessories**

Description	Class	Size SqFt	Eff Yr Blt	RMV	Quantity
No accessory data available					

L-B  
36x36  
 65% Complete  
 2024  
 FASE AKB  
 Exception

Hc      Hc  
14x24      14x36  
 2020      2020  
 NO Exception

Percent Complete Form

Account # 530700

Additions

New Homes

Additions		New Homes				
% Item	% Sum	No Basement		Basement		
		% Item	% Sum	% Item	% Sum	
3%	0%	Plans/Survey	3%	0%	3%	
2%		Excavation	2%		4%	
3%		Foundation	3%		10%	
35%	45%	Framing	14%	20%	16%	35%
8%	50%	Trusses	7%	30%	7%	40%
7%	60%	Roofing	7%	35%	7%	45%
7%	65%	Windows/Ext Doors	7%	45%	6%	55%
5%	70%	Siding	5%	50%	5%	60%
4%	75%	Plumbing Rough-In	4%		3%	
3%		Electrical Rough-In	3%	55%	2%	
2%	80%	Heating Rough-In	2%		1%	
		Heating Unit	1%	1%		
3%		Insulation	3%	2%		
5%	85%	Drywall (Finished)	5%	65%	4%	70%
2%	90%	Paint Interior	2%	70%	2%	75%
2%		Paint Exterior	2%		2%	
		Cabinets	6%	75%	5%	80%
2%	95%	Electrical Fixtures	3%	80%	2%	
2%		Plumbing Fixtures	4%	85%	3%	85%
3%	100%	Floor Coverings & Countertops	7%	90%	6%	90%
2%		Interior Trim Carpentry	7%		95%	
		Porch/Entry/Stoop	2%		100%	
	Finish Grade	1%	1%	100%		

APPR \_\_\_\_\_ Date \_\_\_\_\_ YR For \_\_\_\_\_ % COMP \_\_\_\_\_  
 APPR \_\_\_\_\_ Date \_\_\_\_\_ YR For \_\_\_\_\_ % COMP \_\_\_\_\_  
 APPR \_\_\_\_\_ Date \_\_\_\_\_ YR For \_\_\_\_\_ % COMP \_\_\_\_\_  
 APPR \_\_\_\_\_ Date \_\_\_\_\_ YR For \_\_\_\_\_ % COMP \_\_\_\_\_

Percent Complete Form

Account # \_\_\_\_\_

Gut & Remodels

Interior Trim Carpentry	7%	90%
Floor Coverings & Countertops	7%	85%
Plumbing Fixtures	4%	80%
Electrical Fixtures	3%	80%
Cabinets	6%	75%
Drywall (Finished)	5%	70%
Insulation	3%	65%

APPR \_\_\_\_\_ Date \_\_\_\_\_ YR For \_\_\_\_\_ % COMP \_\_\_\_\_  
 APPR \_\_\_\_\_ Date \_\_\_\_\_ YR For \_\_\_\_\_ % COMP \_\_\_\_\_  
 APPR \_\_\_\_\_ Date \_\_\_\_\_ YR For \_\_\_\_\_ % COMP \_\_\_\_\_  
 APPR \_\_\_\_\_ Date \_\_\_\_\_ YR For \_\_\_\_\_ % COMP \_\_\_\_\_

Outbuilding Type: LB

	% Item	% Sum
Excavation/Foundation	10%	40%
Floor - Concrete/Wood	30%	
Walls - Framing	10%	65%
Walls - Covering/Siding	15%	
Roof - Framing/Trusses	15%	95%
Roof - Sheathing	5%	
Roof - Cover	10%	
Doors & Windows	5%	100%

APPR MSL Date 12/3/24 YR For 25-26 % COMP 65  
 APPR MSL Date 11/15/25 YR For 26-27 % COMP 100%  
 APPR \_\_\_\_\_ Date \_\_\_\_\_ YR For \_\_\_\_\_ % COMP \_\_\_\_\_  
 APPR \_\_\_\_\_ Date \_\_\_\_\_ YR For \_\_\_\_\_ % COMP \_\_\_\_\_

# SKETCH/AREA TABLE ADDENDUM

## SUBJECT INFO

File No.: 530700 Parcel No.: 082W22 00900  
 Property Address: 6883 70TH AV SE  
 City: SALEM County: MARION State: OR ZipCode: 97317  
 Owner:  
 Client: Client Address:  
 Appraiser Name: Inspection Date:

## SKETCH

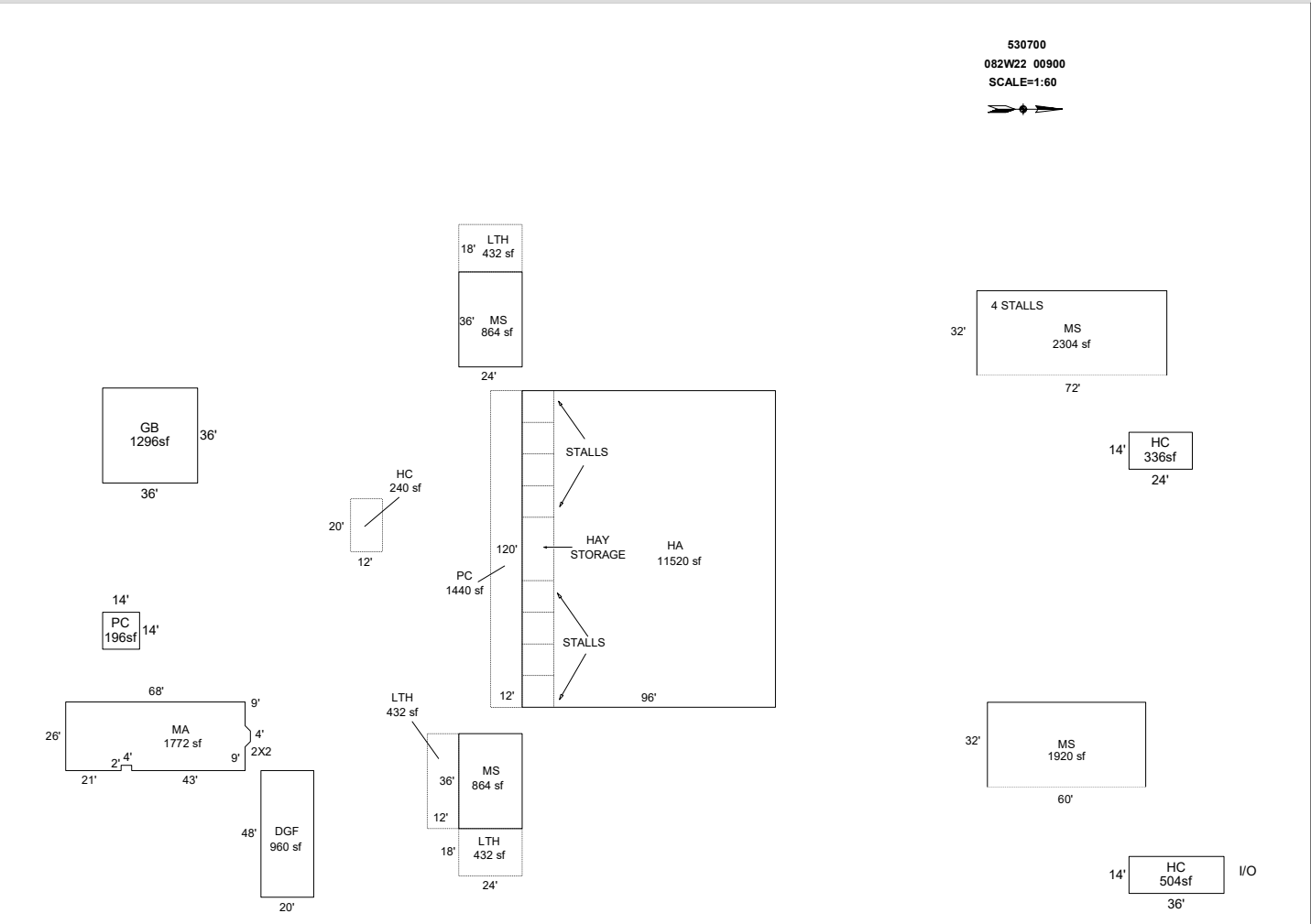

Sketch by ApexSketch

### AREA CALCULATIONS SUMMARY

Code	Description	Factor	Net Size	Perimeter	Net Totals
GBA1	HA	1.0	11520.0	432.0	
	LTH	1.0	432.0	84.0	
	LTH	1.0	432.0	84.0	
	LTH	1.0	432.0	96.0	
	HC	1.0	240.0	64.0	
	MS	1.0	2304.0	208.0	
	MS	1.0	1920.0	184.0	
	HC	1.0	336.0	76.0	
	HC	1.0	504.0	100.0	
	GB	1.0	1296.0	144.0	
	PC	1.0	196.0	56.0	19612.0
GLA1	MA	1.0	1772.0	193.7	
	MS	1.0	864.0	120.0	
GAR	MS	1.0	864.0	120.0	3500.0
	DGF	1.0	960.0	136.0	960.0
P/P	PC	1.0	1440.0	264.0	1440.0
	Net LIVABLE	cnt	0	(rounded)	3,500
	Net BUILDING	cnt	11	(rounded)	19,612

### COMMENT TABLE 1

DRAWN BY JRONDEMA 11/12/15  
 UPDATED BY JRONDEMA 2/1/18  
 UPDATED BY CLOBERG 12/23/24

### COMMENT TABLE 2

MDL 12/03/24

### COMMENT TABLE 3

TAGS L2



12/3/24



**1-29-18**  
**R30700 DGF-Rear**



1/22/2018

**1-29-18**  
**R30700 DGF**



1/22/2018

**1-29-18**

**R30700 HA**



1/22/2018

**1-29-18**

**R30700 MA-North End**



1/22/2018

**1-29-18**  
**R30700 MA-Rear**



1/22/2018

**1-29-18**  
**R30700 MA**



1/22/2018

**1-29-18**

**R30700 MS5 24x36 & LTH 18x24**



1/22/2018

**1-29-18**

**R30700 MS5 24x36 LTH 18x24**



1/22/2018

**1-29-18**

**R30700 MS5 32x60**



1/22/2018

**1-29-18**

**R30700 MS5 32x72**



1/22/2018

# Assessor Monthly Issued Permit Report

For 9/1/2023 to 9/30/2023

PERMIT#: 555-23-006842-AGE STATUS: Approved  
 PERMIT TYPE: Commercial APPLIED: 8/11/2023  
 SUB-TYPE: Agricultural Equine APPROVED: 9/7/2023  
 CATEGORY: Exemption Info EXPIRES:

OFFICE: MC  
 PARCEL#: 082W22 00900 R30700  
 ACRES: 22.26  
 SUBDIV: PP 2005-066  
 LOT/BLOCK: 2 /  
 ADDRESS: 6883 70TH AVE SE SALEM, OR 97317

RELATIONSHIP	NAME	ADDRESS	PHONE
APPLICANT	GOIN, ROBERT DAVID & PETERSON, KRISTIN L	6883 70TH AVE SE SALEM, OR 97317	541.926.4229
OWNER	GOIN, ROBERT DAVID & PETERSON, KRISTIN L	6883 70TH AVE SE SALEM, OR 97317	

CONST CAT:

WORK TYPE:

WORK DESC: AGEX 36 X 36 STORAGE OF FARM EQUIPMENT AND TOOLS

VALUATION: \$0.00

STORIES:

BATHS:

KITCHENS:

SQUARE FEET

HABITABLE:

EXISTING:

NEW:

**TOTAL SQ. FT.:**