

SKETCH/AREA TABLE ADDENDUM

SUBJECT INFO

File No.: 602561	Parcel No.: 062W17AA08400		
Property Address: 9324 GLORY CT NE			
City: SALEM	County: Marion	State: OR	ZipCode: 97305
Owner:			
Client:		Client Address:	
Appraiser Name:		Inspection Date:	

SKETCH

602561
062W17AA08400

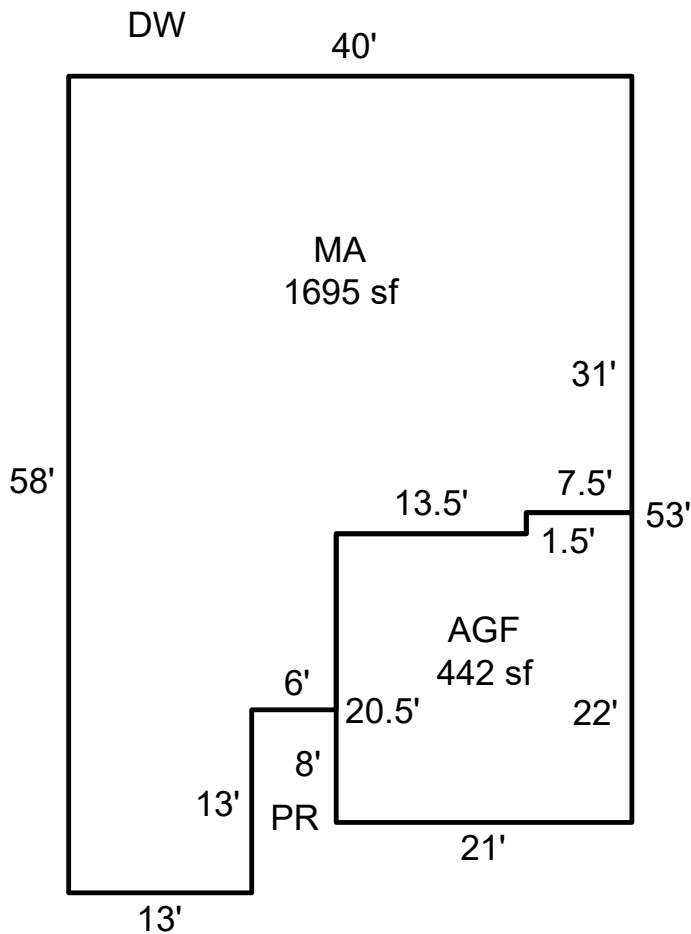

Sketch by ApexSketch

AREA CALCULATIONS SUMMARY

Code	Description	Factor	Net Size	Perimeter	Net Totals
GLA	MA	1.0	1695.3	196.0	1695.3
GAR	AGF	1.0	441.8	86.0	441.8

COMMENT TABLE 1

DRAWN BY CBAILEY 6/16/22
Updated by AE 4.29.25
Updated by AE 12.24.25

COMMENT TABLE 2

12/22/25 Tags ZH

COMMENT TABLE 3

Net LIVABLE	cnt	1	(rounded)	1,695
-------------	-----	---	-----------	-------