

SKETCH/AREA TABLE ADDENDUM

SUBJECT INFO

File No.: 600937 Parcel No.: 041W05B000801
 Property Address: 23325 HOPVINE LN NE
 City: AURORA County: Marion State: OR ZipCode: 97002
 Owner:
 Client: Client Address:
 Appraiser Name: Inspection Date:

SKETCH

600937
041W05B000801
SCALE 1:30

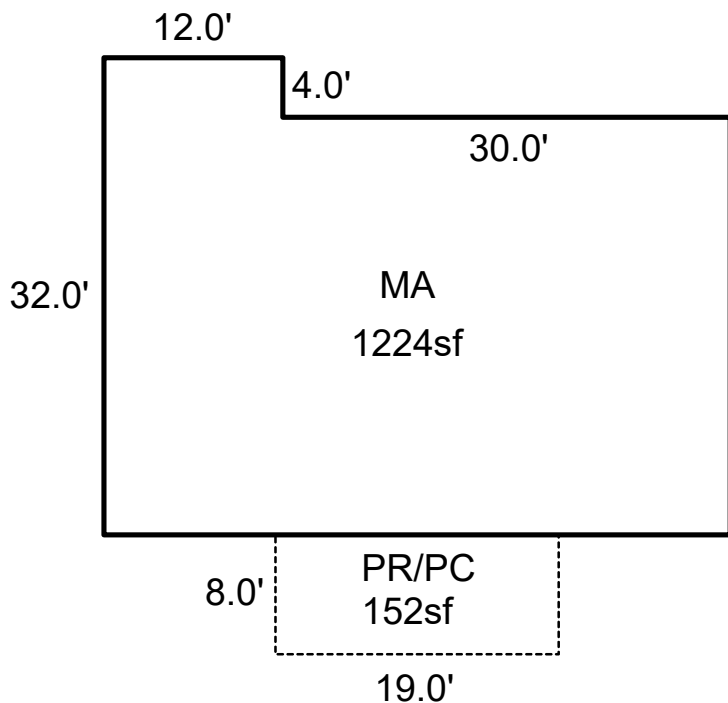

Sketch by ApexSketch

AREA CALCULATIONS SUMMARY						COMMENT TABLE 1	
Code	Description	Factor	Net Size	Perimeter	Net Totals		
MA	MA	1.0	1224.0	148.0	1224.0	APEX BY CLOBERG 01/29/26 25-007792 MA	
PR/PC	PR/PC	1.0	152.0	54.0	152.0		
						COMMENT TABLE 2	COMMENT TABLE 3
Net LIVABLE		cnt	1	(rounded)	1,224		