

SKETCH/AREA TABLE ADDENDUM

SUBJECT INFO

File No.: 611810 Parcel No.: 072W29CA15000
 Property Address: 4962 Dilling Ave NE
 City: Salem County: Marion State: OR ZipCode: 97301
 Owner:
 Client: Client Address:
 Appraiser Name: Inspection Date:

SKETCH

611810
072W29CA15000

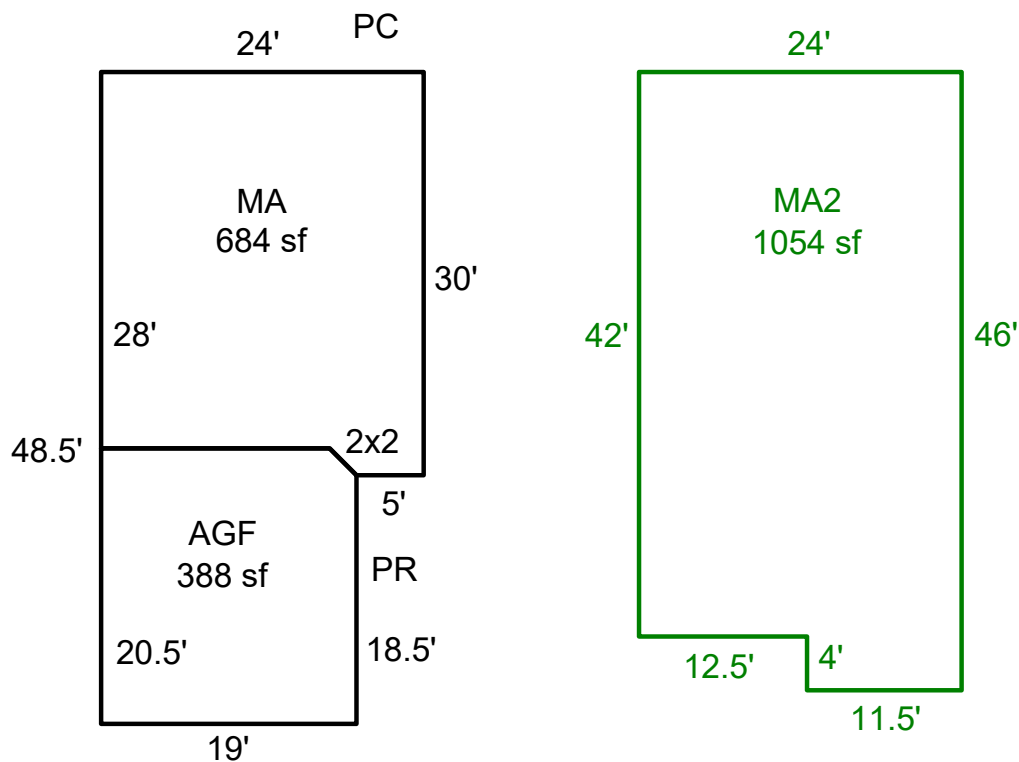

Sketch by ApexSketch

AREA CALCULATIONS SUMMARY						COMMENT TABLE 1		
Code	Description	Factor	Net Size	Perimeter	Net Totals			
GLA	MA	1.0	684.0	106.8	684.0	Drawn by AE 1.28.26		
GLA2	MA2	1.0	1054.0	140.0	1054.0			
GAR	AGF	1.0	387.5	77.8	387.5			
Net LIVABLE						cnt	2 (rounded)	1,738
						COMMENT TABLE 2	COMMENT TABLE 3	