

Acct ID: 524643 MTL: 072W340000200 Date: **1.20.26** Appr: **JJS** Prop Class: 551 RMV Prop Class: 451
 Situs: 7230 STATE ST SALEM OR 97317 MaSaNh: 01 06 000 Unit: 78511 Year: 2026

Last Date Appraised: 02/11/2011 Appraiser: CLINT LUKE Tag: **Y N** Tag info:
 Owner: GEHRING, NATHAN J & GEHRING, JANET E Last Sales Date: 08/01/2002 Roll Type: R
 Cycle **Tag** Sales Verification Other: _____ Inspection level: 1 2 **3** 4 LCB TTO INSP AV: 369638
 RMV Land: 458020 RMV Imp: 522920 RMV Total: 980940 MAV: 335040 MSAV: 34598 SAV: 68742
 Comment:

Add solar / updt IN

Notations

RP/MS	Code	Description
RP	ZONED	FARM EFU ZONED

OSDs

Count	Code	Description	RMV	Code Area	Exception
1	SAA	SA OSD - AVERAGE	55000	92410	0

Land

Site: 1 Code Area: 92410 Size: 1.00 Acres Use Code: 005 Zone: REST SAV Use: 011 Exception: 0
 Class: Value Source: Farm Homesite Description: RMV: 43200 Exception: Y N

Adjustment(s): GSOIL Fire Patrol: Description:

Comments: Liability year - 2009 / //09-10: GW39 changed land type per Excel analysis// 02400210//00-01; SEPERATED INCREMENT FROM HOMESITE 03-04: PART TOTALS UPDATED //05-06: RECALC SETUP; 17, 6/02/04.

Site: 2 Code Area: 92410 Size: 4.00 Acres Use Code: 005 Zone: REST SAV Use: 011 Exception: 0
 Class: 2BD Value Source: Farm Use - EFU Description: TWO BENCH DRY RMV: 190060 Exception: Y N

Adjustment(s): GSOIL Fire Patrol: Description:

Comments: Liability year - 1976 / 02400210

Site: 3 Code Area: 92410 Size: 3.93 Acres Use Code: 005 Zone: REST SAV Use: 011 Exception: 0
 Class: 4BD Value Source: Farm Use - EFU Description: FOUR BENCH DRY RMV: 169760 Exception: Y N

Adjustment(s): GSOIL Fire Patrol: Description:

Comments: Liability year - 1976 / 02400210 //01-02: COMBINED LAND SEGS - SAME SOIL CLASS, SAME LIAB YR, 3.93 TTL ACRES

Improvements - Residence / Manufactured Structures

Bldg: 1 Code Area: 92410 Stat Class: 142 Year Blt: 2003 Eff Year Blt: 2003 Sq.Ft: 3146 % Complete: 100.00
 Desc: Multi Story above grade Dimensions: RMV: 434060
 Func Obsc: 100 Econ %: 100 Other %: 100 Exception: 0 Adjust: Adjust RMV: 0

Floors

Type	Class	Display Group	Floor Size	Beds	Baths	Yr Blt	Eff Yr Blt	Inventory	Exception
First Floor	4	Finished	1777	1	FB-1/ HB-1	2003	2003	ROOF, FP - 2, HVAC+, BATH+, KIT+, BTH - 1, BATH - 1	Y N
Second Floor	4	Finished	1069	3	FB-1	2003	2003	HVAC+, ROOF, BATH - 1	Y N
Attic	4	Finished	300	0	0	2003	2003		Y N
Garage Attached	4	Finished	637	0	0	2003	2003	ROOF	Y N

Accessories

Description	Class	Size SqFt	Eff Yr Blt	RMV	Quantity	Exception
ROOF EXTENSION OR PATIO COVER	4	290	2003	7485	1	Y N
YARD IMPROVEMENTS AVERAGE	4	1	2003	24164	1	Y N

Improvements - Accessory Buildings

Bldg: 2 Code Area: 92410 Stat Class: 341 Year Blt: 2003 Eff Year Blt: 2003 Sq.Ft: 100 % Complete: 100.00
 Desc: Multi Purpose Shed (MP) Dimensions: 10x10 RMV: 250
 Func Obsc: 100 Econ %: 100 Other %: 100 Exception: 0 Adjust: Adjust RMV: 0

Floors

Type	Class	Display Group	Floor Size	Beds	Baths	Yr Blt	Eff Yr Blt	Inventory	Exception
Multi-Purpose Bldg	5	Finished	100	0	0	2003	2003	FAIR	Y N

Accessories

No accessory data available

Bldg: 3 Code Area: 92410 Stat Class: 351 Year Blt: 2010 Eff Year Blt: 2010 Sq.Ft: 2640 % Complete: 100.00
 Desc: ~~General Purpose Building (GB)~~ **LB** Dimensions: 44x60 RMV: 88610
 Func Obsc: 100 Econ %: 100 Other %: 100 Exception: 0 Adjust: Adjust RMV: 0

Floors

Type	Class	Display Group	Floor Size	Beds	Baths	Yr Blt	Eff Yr Blt	Inventory	Exception: Y N
General Purpose Bldg	5	Finished	2640	0	0	2010	2010	FAIR	Y N
GP Building Atti	5	Finished	1200	0	0	2010	2010		Y N

Accessories

Description	Class	Size SqFt	Eff Yr Blt	RMV	Quantity
No accessory data available					

Permits

Permit Number	Permit ID	Origin	Category	Type	Estimate Value	% Complete	Roll Type	Description
25-009116	85513	MARION COUNTY	TAGS/PERMITS	ALT ENERGY SYSTEM	0	0	R	SOLAR ARRAY



SKETCH/AREA TABLE ADDENDUM

Parcel No 072W34 00200

File No R7230 R246 43

Property Address 7230 STATE ST

City SALEM

State OR

Zip 97317

Owner

Client

Appraiser Name

Apex updated to FB

R2464
072W34 00200

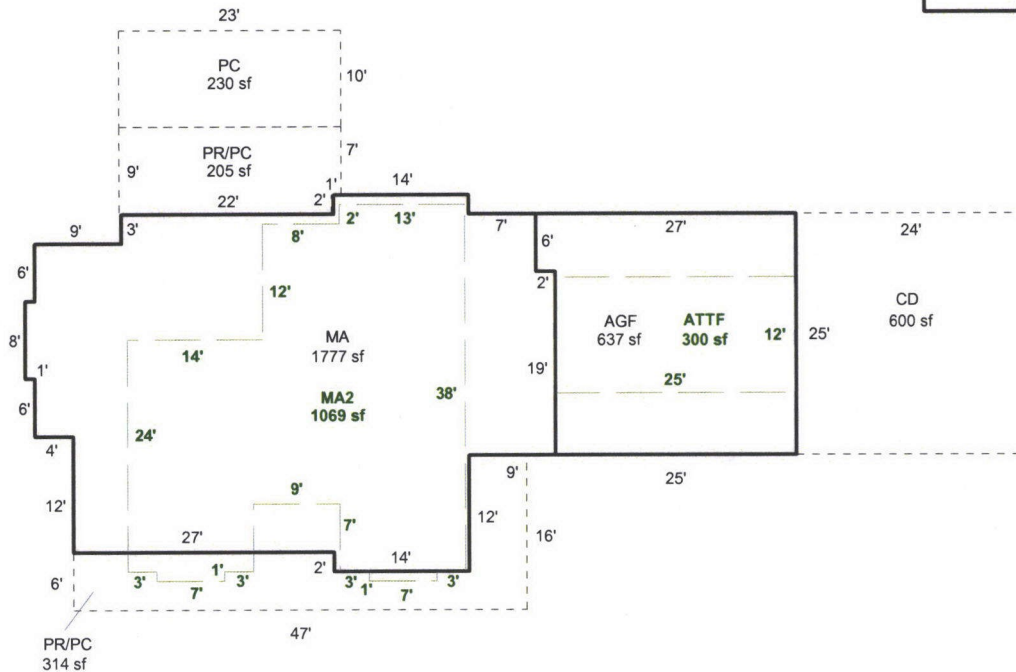
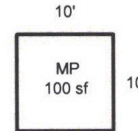

Scale: 1 = 20

AREA CALCULATIONS SUMMARY

Code	Description	Factor	Net Size	Perimeter	Net Totals
GLA1	MA	1.00	1777	188	1777
GLA2	MA2	1.00	1069	164	
	ATTF	1.00	300	74	1369
GBA1	MP	1.00	100	40	100
AGF	AGF	1.00	637	104	637
P/P	CD	1.00	600	98	
	PR/PC	1.00	205	64	
	PC	1.00	230	66	
	PR/PC	1.00	314	130	1349
Net LIVABLE Area		(rounded w/ factors)			3146
Net BUILDING Area		(rounded w/ factors)			100

Comment Table 1

APEX BY CE 2/18/11

Comment Table 2

Comment Table 3

AREA CALCULATIONS

IMPROVEMENTS SKETCH

SUBJECT