

Acct ID: 536615 MTL: 093W330000600 Date: 4/25/24 Appr: MDL Prop Class: 961 RMV Prop Class: 501  
 Situs: 14515 INTERSTATE 5 JEFFERSON OR 97352 MaSaNh: 07 06 000 Unit: 40234 Year: 2024

Last Date Appraised: 07/27/2018 Appraiser: MATT LORD Retag: Y N Tag info: \_\_\_\_\_  
 Owner: STATE OF OREGON Roll Type: R  
 Cycle Tag Sales Verification Other: \_\_\_\_\_ Inspection level: 1 2 3 4 LCB TTO INSP AV: 0  
 RMV Land: 100860 RMV Imp: 114570 RMV Total: 215430 MAV: 0 MSAV: 0 SAV: 0  
 Comment: Land: 1; Imp: RESTROOM BUILDING AND PARKING LOT. EXEMPT.

**Notations**

No notation data available.

N/c Removed MP 13x28

**OSDs**

Count	Code	Description	RMV	Code Area	Exception
1	MKTA	OSD - AVERAGE	40000	14530	0

**Land** OK WW

Site: 1	Code Area: 14530	Size: 54.19 Acres	Use Code: 005	Zone: REST	SAV Use:	Exception: 0
Class: WST	Value Source: Rural Restrictive	Description: Rural WASTELAND	RMV: 11890	Exception: Y N		
Adjustment(s):	GSOIL, WASTE	Fire Patrol:	Description:			
Comments:	03-04: REAPPRAISAL					
Site: 2	Code Area: 14530	Size: 5.33 Acres	Use Code: 005	Zone: REST	SAV Use:	Exception: 0
Class: 4BDS S	Value Source: Rural Restrictive	Description: FOUR BENCH DRY SPECIAL SOUTH	RMV: 38990	Exception: Y N		
Adjustment(s):	GSOIL, WASTE	Fire Patrol:	Description:			
Comments:	03-04: REAPPRAISAL					
Site: 3	Code Area: 14530	Size: 1.24 Acres	Use Code: 005	Zone: REST	SAV Use:	Exception: 0
Class: 2BDS S	Value Source: Rural Restrictive	Description: TWO BENCH DRY SOUTH SPECIAL	RMV: 9980	Exception: Y N		
Adjustment(s):	GSOIL, WASTE	Fire Patrol:	Description:			
Comments:	03-04: REAPPRAISAL					

**Improvements - Residence / Manufactured Structures**

Bldg: 2	Code Area: 14530	Stat Class: 108	Year Blt: 1980	Eff Year Blt: 1980	Sq.Ft: 0	% Complete: 100
Desc:	Residential Other Improvements	Dimensions:	RMV: 27720			
Func Obsc: 100	Econ %: 100	Other %: 100	Exception: 0	Adjust:	Adjust RMV: 0	

**Floors**

Type	Class	Display Group	Floor Size	Beds	Baths	Yr Blt	Eff Yr Blt	Inventory
------	-------	---------------	------------	------	-------	--------	------------	-----------

No floor data available

**Accessories**

Description	Class	Size SqFt	Eff Yr Blt	RMV	Quantity
ASPHALT DRIVEWAY	1	66000	1980	27720	1

Bldg: 7	Code Area: 14530	Stat Class: 108	Year Blt: 1980	Eff Year Blt: 1980	Sq.Ft: 0	% Complete: 100
Desc:	Residential Other Improvements	Dimensions:	RMV: 25410			
Func Obsc: 100	Econ %: 100	Other %: 100	Exception: 0	Adjust:	Adjust RMV: 0	

**Floors**

Type	Class	Display Group	Floor Size	Beds	Baths	Yr Blt	Eff Yr Blt	Inventory
------	-------	---------------	------------	------	-------	--------	------------	-----------

No floor data available

**Accessories**

Description	Class	Size SqFt	Eff Yr Blt	RMV	Quantity
PATIO	1	5500	1980	25410	1

**Improvements - Accessory Buildings**

Bldg: 1	Code Area: 14530	Stat Class: 351	Year Blt: 2007	Eff Year Blt: 2007	Sq.Ft: 900	% Complete: 100
Desc:	General Purpose Building (GB)	Dimensions: 30x30	RMV: 20110			
Func Obsc: 100	Econ %: 100	Other %: 100	Exception: 0	Adjust:	Adjust RMV: 0	

**Floors**

Type	Class	Display Group	Floor Size	Beds	Baths	Yr Blt	Eff Yr Blt	Inventory
------	-------	---------------	------------	------	-------	--------	------------	-----------

General Purpose Bldg	6	Finished	900	0	FB-2	2007	2007	BATH - 2, FAIR
----------------------	---	----------	-----	---	------	------	------	----------------

Exception: Y N

**Accessories**

Description	Class	Size SqFt	Eff Yr Blt	RMV	Quantity
-------------	-------	-----------	------------	-----	----------

No accessory data available

Bldg: 3 Code Area: 14530 Stat Class: 351 Year Blt: 2005 Eff Year Blt: 2007 Sq.Ft: 1334 % Complete: 100  
 Desc: General Purpose Building (GB) Dimensions: 29x46 RMV: 26580  
 Func Obsc: 100 Econ %: 100 Other %: 100 Exception: 0 Adjust: Adjust RMV: 0

**Floors**

Type	Class	Display Group	Floor Size	Beds	Baths	Yr Blt	Eff Yr Blt	Inventory
General Purpose Bldg	6	Finished	1334	0	FB-2	2005	2007	FAIR, BATH - 2 Exception: Y N

**Accessories**

Description	Class	Size SqFt	Eff Yr Blt	RMV	Quantity
-------------	-------	-----------	------------	-----	----------

No accessory data available

~~Bldg: 4 Code Area: 14530 Stat Class: 341 Year Blt: 1990 Eff Year Blt: 2005 Sq.Ft: 364 % Complete: 100~~  
~~Desc: Multi Purpose Shed (MP) Dimensions: 13x28 RMV: 8930~~  
~~Func Obsc: 100 Econ %: 100 Other %: 100 Exception: 0 Adjust: Adjust RMV: 0~~

**Not on this tax lot**

**Floors**

Type	Class	Display Group	Floor Size	Beds	Baths	Yr Blt	Eff Yr Blt	Inventory
Multi-Purpose Bldg	6	Finished	364	0	0	1990	2005	FAIR Exception: Y N

**Accessories**

Description	Class	Size SqFt	Eff Yr Blt	RMV	Quantity
-------------	-------	-----------	------------	-----	----------

No accessory data available

Bldg: 5 Code Area: 14530 Stat Class: 355 Year Blt: 1990 Eff Year Blt: 2002 Sq.Ft: 256 % Complete: 100  
 Desc: Lean-to Heavy (LTH) Dimensions: 16x16 RMV: 1200  
 Func Obsc: 100 Econ %: 100 Other %: 100 Exception: 0 Adjust: Adjust RMV: 0

**Floors**

Type	Class	Display Group	Floor Size	Beds	Baths	Yr Blt	Eff Yr Blt	Inventory
Lean-to Heavy Duty	4	Finished	256	0	0	1990	2002	FAIR Exception: Y N

**Accessories**

Description	Class	Size SqFt	Eff Yr Blt	RMV	Quantity
-------------	-------	-----------	------------	-----	----------

No accessory data available

Bldg: 6 Code Area: 14530 Stat Class: 341 Year Blt: 2014 Eff Year Blt: 2014 Sq.Ft: 112 % Complete: 100  
 Desc: Multi Purpose Shed (MP) Dimensions: 8x14 RMV: 4620  
 Func Obsc: 100 Econ %: 100 Other %: 100 Exception: 0 Adjust: Adjust RMV: 0

**Floors**

Type	Class	Display Group	Floor Size	Beds	Baths	Yr Blt	Eff Yr Blt	Inventory
Multi-Purpose Bldg	6	Finished	112	0	0	2014	2014	FAIR Exception: Y N

**Accessories**

Description	Class	Size SqFt	Eff Yr Blt	RMV	Quantity
-------------	-------	-----------	------------	-----	----------

No accessory data available

apex updated

AD

R36615  
093W33 00600  
SCALE=1:30

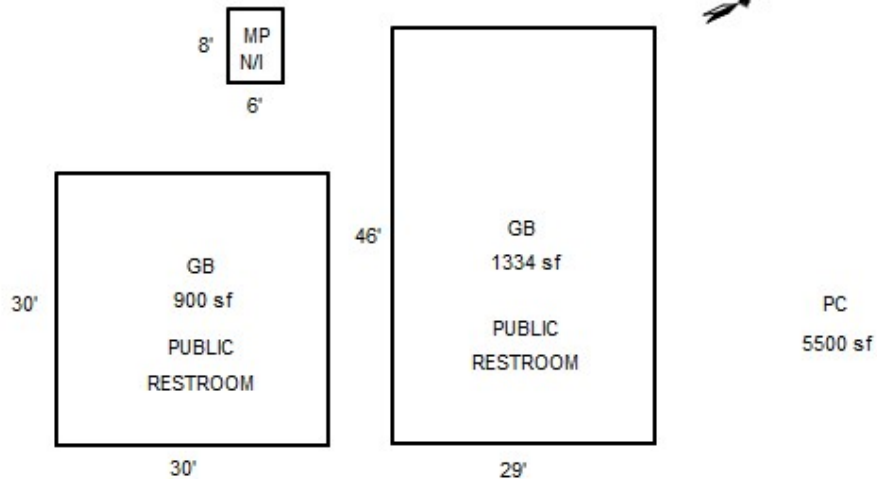
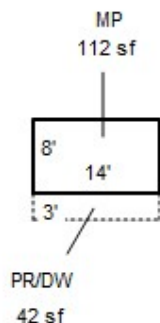

AD  
66000 sf

located on adjacent tax lot preferred to as floodplan

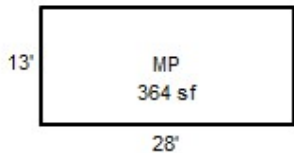



R36615

GB 29X46

7/27/18



R36615

GB 30X30

7/27/18



R36615

LTH

7/27/18



R36615

MP 13X28

7/27/18



R36615

MP 8X14

7/27/18



NO SMOKING

NO ALCOHOL

WOMEN

MEN

TOILETS



