

SKETCH/AREA TABLE ADDENDUM

SUBJECT INFO

File No.: 128760 Parcel No.: 062W31D000500
 Property Address: 5422 PORTLAND RD NE #3
 City: SALEM County: State: OR ZipCode: 97305
 Owner:
 Client: Client Address:
 Appraiser Name: Inspection Date:

SKETCH

128760
062W31D000500

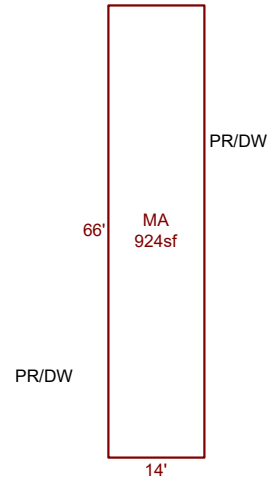

Sketch by ApexSketch

AREA CALCULATIONS SUMMARY

Code	Description	Factor	Net Size	Perimeter	Net Totals
MFH	MA	1.0	924.0	160.0	924.0
	Net LIVABLE	cnt	1	(rounded)	924

COMMENT TABLE 1

DRAWN BY LK 2.20.26

COMMENT TABLE 2

6.12.25 CYCLE TS

COMMENT TABLE 3