

SKETCH/AREA TABLE ADDENDUM

SUBJECT INFO

File No.: 128896 Parcel No.: 062W31D000500
 Property Address: 5422 PORTLAND RD NE #122
 City: SALEM County: State: OR ZipCode: 97305
 Owner:
 Client: Client Address:
 Appraiser Name: Inspection Date:

SKETCH

128896

062W31D000500

GS N/V

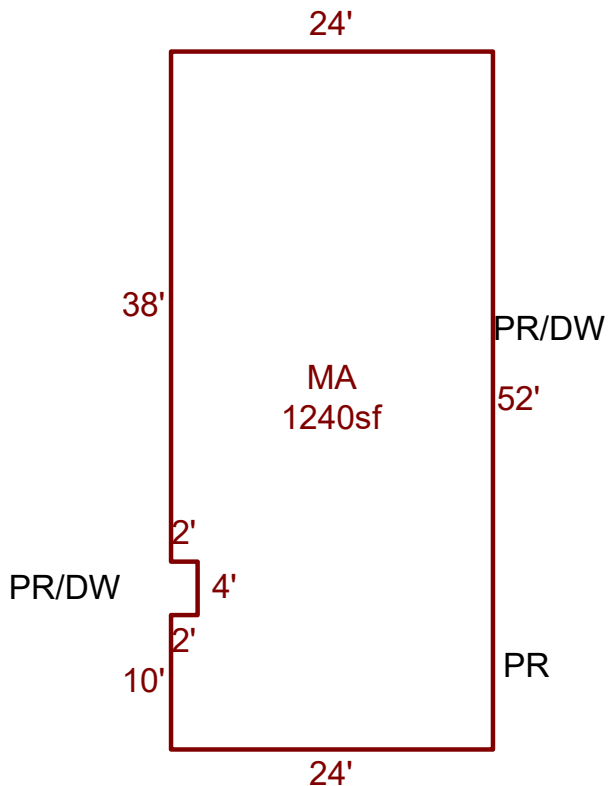

Sketch by ApexSketch

AREA CALCULATIONS SUMMARY

Code	Description	Factor	Net Size	Perimeter	Net Totals
MFH	MA	1.0	1240.0	156.0	1240.0

COMMENT TABLE 1

DRAWN BY LK 2.20.26

COMMENT TABLE 2

6.12.25 CYCLE TS

COMMENT TABLE 3

Net LIVABLE cnt 1 (rounded) 1,240