

SKETCH/AREA TABLE ADDENDUM

SUBJECT INFO

File No.: 129532 Parcel No.: 062W31D000500
 Property Address: 5422 PORTLAND RD NE #103
 City: SALEM County: State: OR ZipCode: 97305
 Owner:
 Client: Client Address:
 Appraiser Name: Inspection Date:

SKETCH

129532
062W31D000500

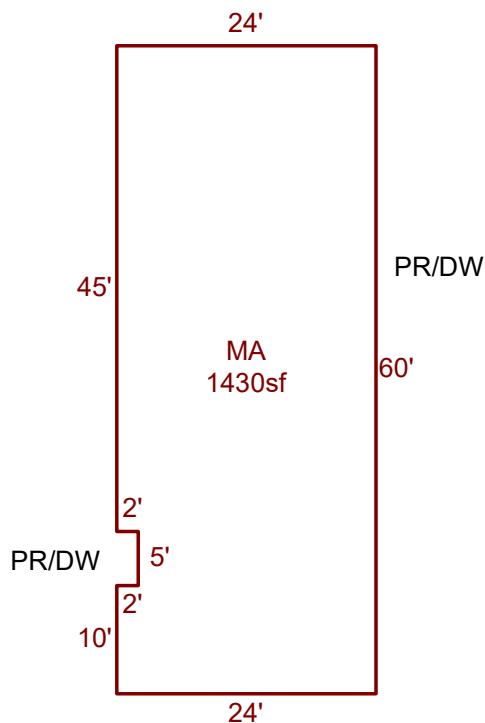

Sketch by ApexSketch

AREA CALCULATIONS SUMMARY						COMMENT TABLE 1	
Code	Description	Factor	Net Size	Perimeter	Net Totals		
MFH	MA	1.0	1430.0	172.0	1430.0	DRAWN BY LK 3.13.26	
						COMMENT TABLE 2	COMMENT TABLE 3
						6.12.25 CYCLE TS	
	Net LIVABLE	cnt	1	(rounded)	1,430		