

SKETCH/AREA TABLE ADDENDUM

SUBJECT INFO

File No.: 611814 Parcel No.: 072W29CA15400
 Property Address: 4984 Dilling Ave NE
 City: Salem County: Marion State: OR ZipCode: 97301
 Owner:
 Client: Client Address:
 Appraiser Name: Inspection Date:

SKETCH

611814
072W29CA15400

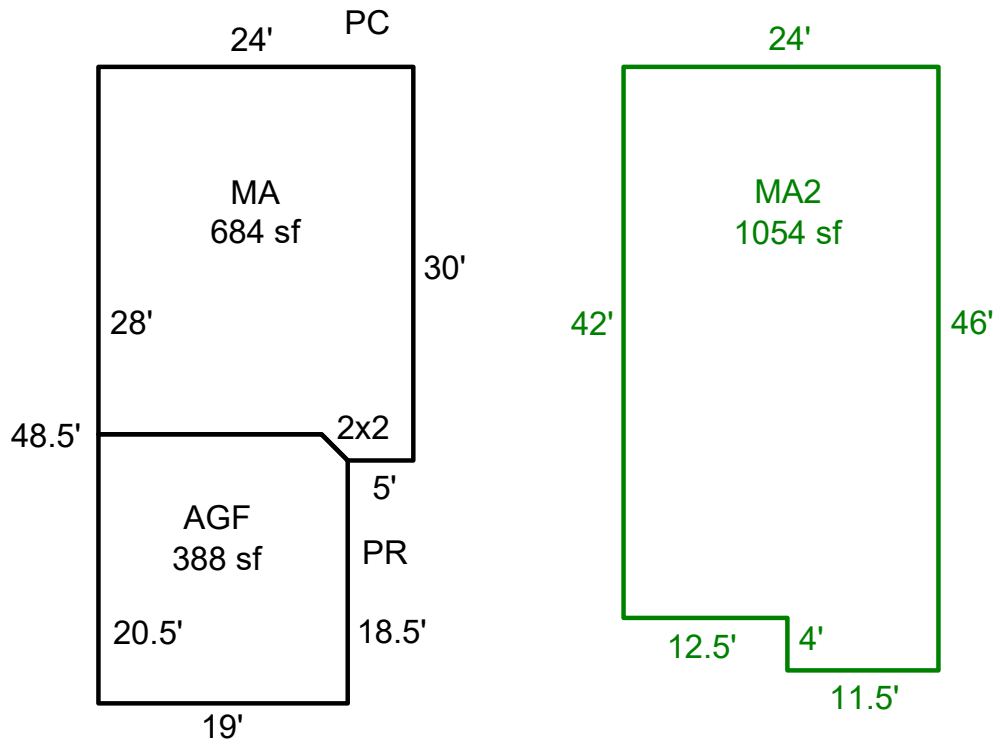

Sketch by ApexSketch

AREA CALCULATIONS SUMMARY						COMMENT TABLE 1	
Code	Description	Factor	Net Size	Perimeter	Net Totals		
GLA	MA	1.0	684.0	106.8	684.0	Drawn by AE 3.12.26	
GLA2	MA2	1.0	1054.0	140.0	1054.0		
GAR	AGF	1.0	387.5	77.8	387.5		
						COMMENT TABLE 2	COMMENT TABLE 3
Net LIVABLE		cnt	2	(rounded)	1,738		