

SKETCH/AREA TABLE ADDENDUM

SUBJECT INFO			
File No.: 134097	Parcel No.: 062W31D000500		
Property Address: 5422 PORTLAND RD NE #11			
City: SALEM	County:	State: OR	ZipCode: 97305
Owner:			
Client:		Client Address:	
Appraiser Name:		Inspection Date:	

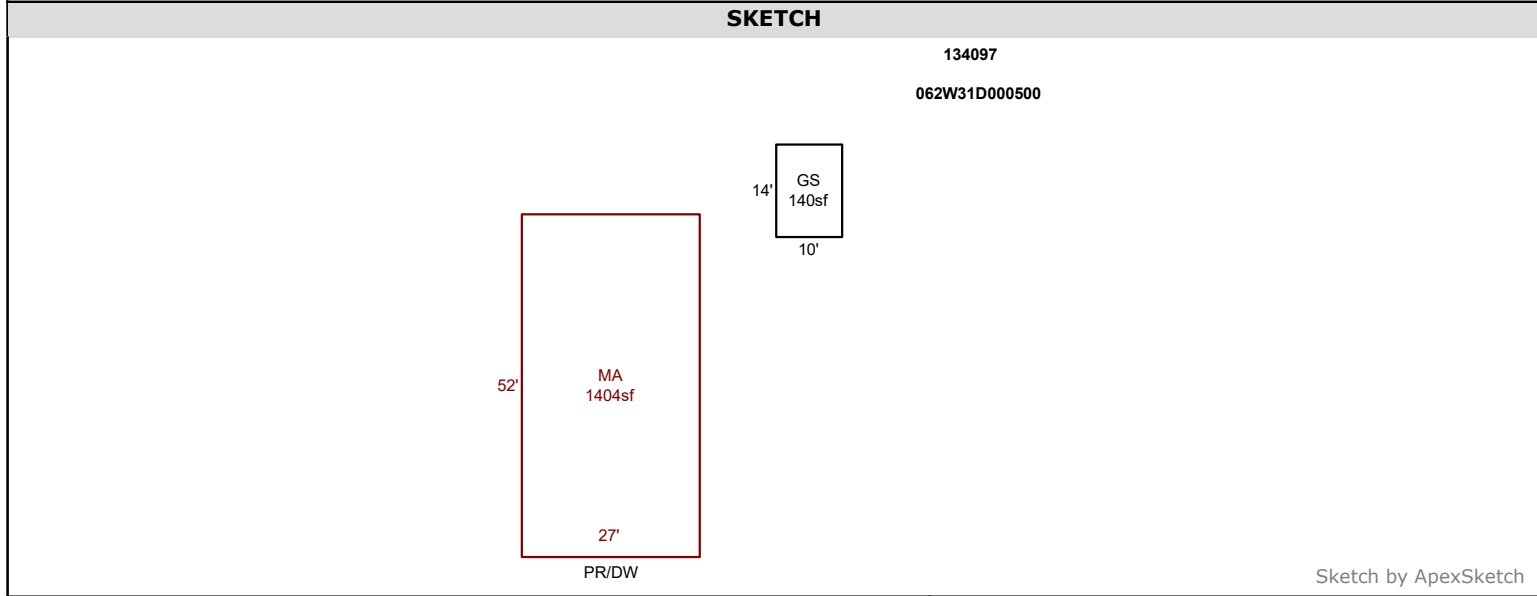

AREA CALCULATIONS SUMMARY						COMMENT TABLE 1	
Code	Description	Factor	Net Size	Perimeter	Net Totals		
GBA	GS	1.0	140.0	48.0	140.0	DRAWN BY LK 3.16.26	
MFH	MA	1.0	1404.0	158.0	1404.0		
Net LIVABLE cnt 1 (rounded) 1,404 Net BUILDING cnt 1 (rounded) 140						COMMENT TABLE 2 6.12.25 CYCLE TS	COMMENT TABLE 3