

# SKETCH/AREA TABLE ADDENDUM

SUBJECT INFO			
File No.: 333185	Parcel No.: 062W31D000500		
Property Address: 5422 PORTLAND RD NE #44			
City: SALEM	County:	State: OR	ZipCode: 97305
Owner:			
Client:		Client Address:	
Appraiser Name:		Inspection Date:	

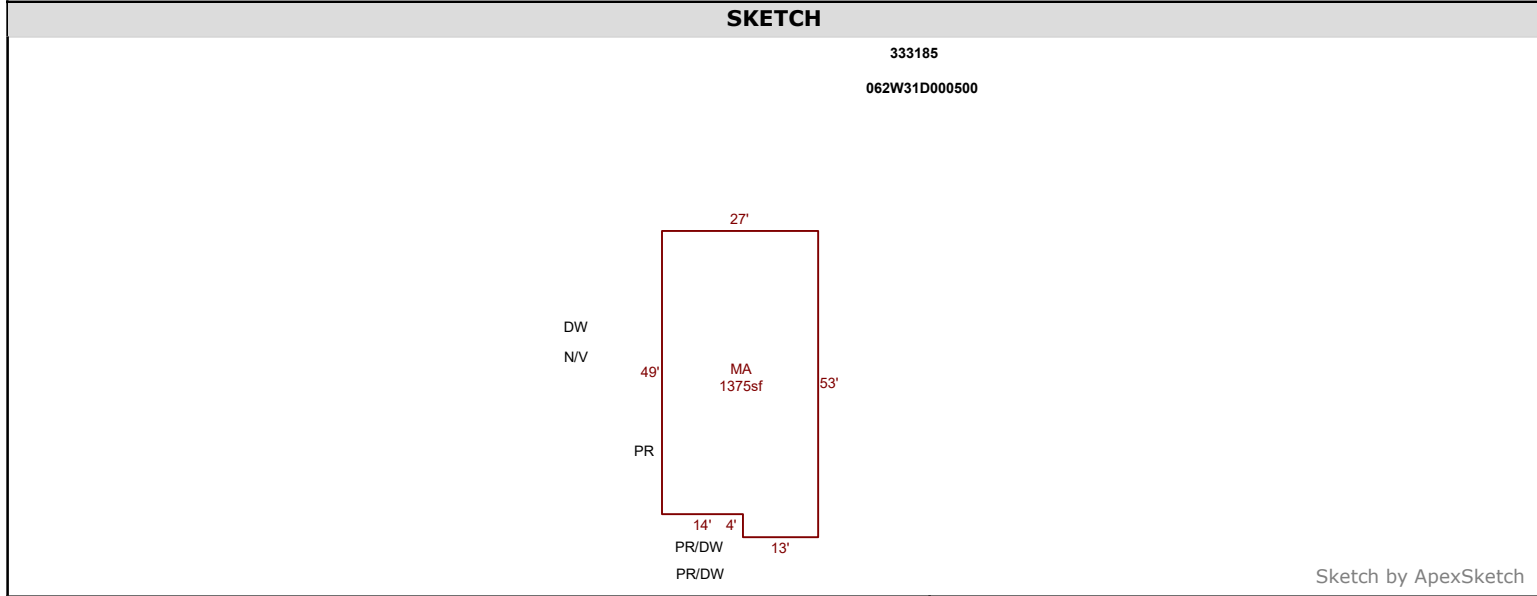

AREA CALCULATIONS SUMMARY						COMMENT TABLE 1	
Code	Description	Factor	Net Size	Perimeter	Net Totals		
MFH	MA	1.0	1375.0	160.0	1375.0	DRAWN BY LK 3.16.26	
						COMMENT TABLE 2	COMMENT TABLE 3
						6.12.25 CYCLE TS	
Net LIVABLE		cnt	1	(rounded)	1,375		