

Acct ID: 511187 MTL: 041W23A000100 Date: **1.20.25** Appr: **JJS** Prop Class: 451 RMV Prop Class: 451
 Situs: 20457 HIGHWAY 99E NE AURORA OR 97002 MaSaNh: 02 06 000 Unit: 87878 Year: 2025

Last Date Appraised: 01/08/2025 Appraiser: JORDAN SCHULTZ Tag: Y **N** Tag info: 2026 - Tags/Permit (Alt Energy System)
 Owner: HERMOSILLO, TIMOTEO BARAJAS Last Sales Date: 08/08/2005 Roll Type: R
 Cycle **Tag** Sales Verification Other: _____ Inspection level: 1 **2** 4 LCB TTO INSP AV: 349210
 RMV Land: 294620 RMV Imp: 463560 RMV Total: 758180 MAV: 319180 MSAV: 0 SAV: 0
 Comment: 25-26: 1/8/25 JJS
 24-25: L4 08.17.23 JJS

Solar @ 100%.

OSDs

Count	Code	Description	RMV	Code Area	Exception
1	MKTA	OSD - AVERAGE	50000	15569	0

Land

Site: 1 Code Area: 15569 Size: 1.50 Acres Use Code: 005 Zone: REST SAV Use: Exception: 0
 Class: 2BD Value Source: Rural Restrictive Description: TWO BENCH DRY RMV: 244620 Exception: Y N
 Adjustment(s): GSOIL Fire Patrol: Description:
 Comments: 07-08:RECALC SETUP; #36 8-29-06

Improvements - Residence / Manufactured Structures

Bldg: 1 Code Area: 15569 Stat Class: 142 Year Blt: 1947 Eff Year Blt: 1985 Sq.Ft: 2795 % Complete: 100.00
 Desc: Multi Story above grade Dimensions: RMV: 370470
 Func Obsc: 100 Econ %: 100 Other %: 100 Exception: 0 Adjust: Adjust RMV: 0

Floors

Type	Class	Display Group	Floor Size	Beds	Baths	Yr Blt	Eff Yr Blt	Inventory	Exception
First Floor	4	Finished	2071	3	FB-2	1947	1985	ROOF, FP - 1, HVAC, KIT-, BATH - 2	Y N
Second Floor	4	Finished	724	2	FB-1	2018	1985	HVAC, BATH - 1	Y N

Accessories

Description	Class	Size SqFt	Eff Yr Blt	RMV	Quantity	Exception
YARD IMPROVEMENTS FAIR	4	0	1985	15601	1	Y N

Improvements - Accessory Buildings

Bldg: 2 Code Area: 15569 Stat Class: 351 Year Blt: 1990 Eff Year Blt: 1990 Sq.Ft: 864 % Complete: 100.00
 Desc: General Purpose Building (GB) Dimensions: 36x24 RMV: 6360
 Func Obsc: 100 Econ %: 100 Other %: 100 Exception: 0 Adjust: Adjust RMV: 0

Floors

Type	Class	Display Group	Floor Size	Beds	Baths	Yr Blt	Eff Yr Blt	Inventory	Exception
General Purpose Bldg	5	Finished	864	0	0	1990	1990	FAIR	Y N

Accessories

Description	Class	Size SqFt	Eff Yr Blt	RMV	Quantity	Exception
No accessory data available						

Bldg: 3 Code Area: 15569 Stat Class: 351 Year Blt: 1992 Eff Year Blt: 1992 Sq.Ft: **2216** % Complete: 100.00
 Desc: General Purpose Building (GB) Dimensions: RMV: 12250
 Func Obsc: 100 Econ %: 100 Other %: 100 Exception: 0 Adjust: Adjust RMV: 0

Floors

Type	Class	Display Group	Floor Size	Beds	Baths	Yr Blt	Eff Yr Blt	Inventory	Exception
General Purpose Bldg	5	Finished	2216	0	0	1992	1992	FAIR	Y N

Accessories

Description	Class	Size SqFt	Eff Yr Blt	RMV	Quantity	Exception
No accessory data available						

Bldg: 4 Code Area: 15569 Stat Class: 355 Year Blt: 2012 Eff Year Blt: 2012 Sq.Ft: 504 % Complete: 100.00
 Desc: Lean-to Heavy (LTH) Dimensions: 36x14 RMV: 2590
 Func Obsc: 100 Econ %: 100 Other %: 100 Exception: 0 Adjust: Adjust RMV: 0

Floors

Type	Class	Display Group	Floor Size	Beds	Baths	Yr Blt	Eff Yr Blt	Inventory	Exception
Lean-to Heavy Duty	4	Finished	504	0	0	2012	2012		Y N

Accessories

Description	Class	Size SqFt	Eff Yr Blt	RMV	Quantity
No accessory data available					
Bldg: 5 Code Area: 15569 Stat Class: 355 Year Blt: 2011 Eff Year Blt: 2011 Sq.Ft: 336 % Complete: 100.00					
Desc: Lean-to Heavy (LTH) Dimensions: 24x14 RMV: 1680					
Func Obsc: 100 Econ %: 100 Other %: 100 Exception: 0 Adjust: Adjust RMV: 0					

Floors

Type	Class	Display Group	Floor Size	Beds	Baths	Yr Blt	Eff Yr Blt	Inventory
Lean-to Heavy Duty	4	Finished	336	0	0	2011	2011	Exception: Y N

Accessories

Description	Class	Size SqFt	Eff Yr Blt	RMV	Quantity
No accessory data available					
Bldg: 8 Code Area: 15569 Stat Class: 905 Year Blt: 2023 Eff Year Blt: 2023 Sq.Ft: 0 % Complete: 100.00					
Desc: Rural Solar Panel/Array Dimensions: RMV: 7280					
Func Obsc: 100 Econ %: 100 Other %: 100 Exception: 0 Adjust: Adjust RMV: 0					

Floors

Type	Class	Display Group	Floor Size	Beds	Baths	Yr Blt	Eff Yr Blt	Inventory
No floor data available								

Accessories

Description	Class	Size SqFt	Eff Yr Blt	RMV	Quantity
No accessory data available					
Bldg: 9 Code Area: 15569 Stat Class: 321 Year Blt: 2024 Eff Year Blt: 2024 Sq.Ft: 4320 % Complete: 100.00					
Desc: Hay Cover (HC) Dimensions: 120x36 RMV: 62930					
Func Obsc: 100 Econ %: 100 Other %: 100 Exception: 30030 Adjust: Adjust RMV: 0					

Floors

Type	Class	Display Group	Floor Size	Beds	Baths	Yr Blt	Eff Yr Blt	Inventory
Hay Cover	6	Finished	4320	0	0	2024	2024	FAIR Exception: Y N

Accessories

Description	Class	Size SqFt	Eff Yr Blt	RMV	Quantity
No accessory data available					

Permits

Permit Number	Permit ID	Origin	Category	Type	Estimate Value	% Complete	Roll Type	Description
25-001071	83523	MARION COUNTY	TAGS/PERMITS	ALT ENERGY SYSTEM	36900	0	R	Solar Array 14.76 kW on Pole Bldg Roof @ \$36,900

905 Solar \$20,000 New 2025 100%
 351 GB S 26x37 Fair 2017 Existing





SKETCH/AREA TABLE ADDENDUM

SUBJECT INFO

File No.: 511187 Parcel No.: 041W23A 00100
 Property Address: 20457 HIGHWAY 99E NE
 City: AURORA County: MARION State: OR ZipCode: 97002
 Owner:
 Client: Client Address:
 Appraiser Name: Inspection Date:

SKETCH

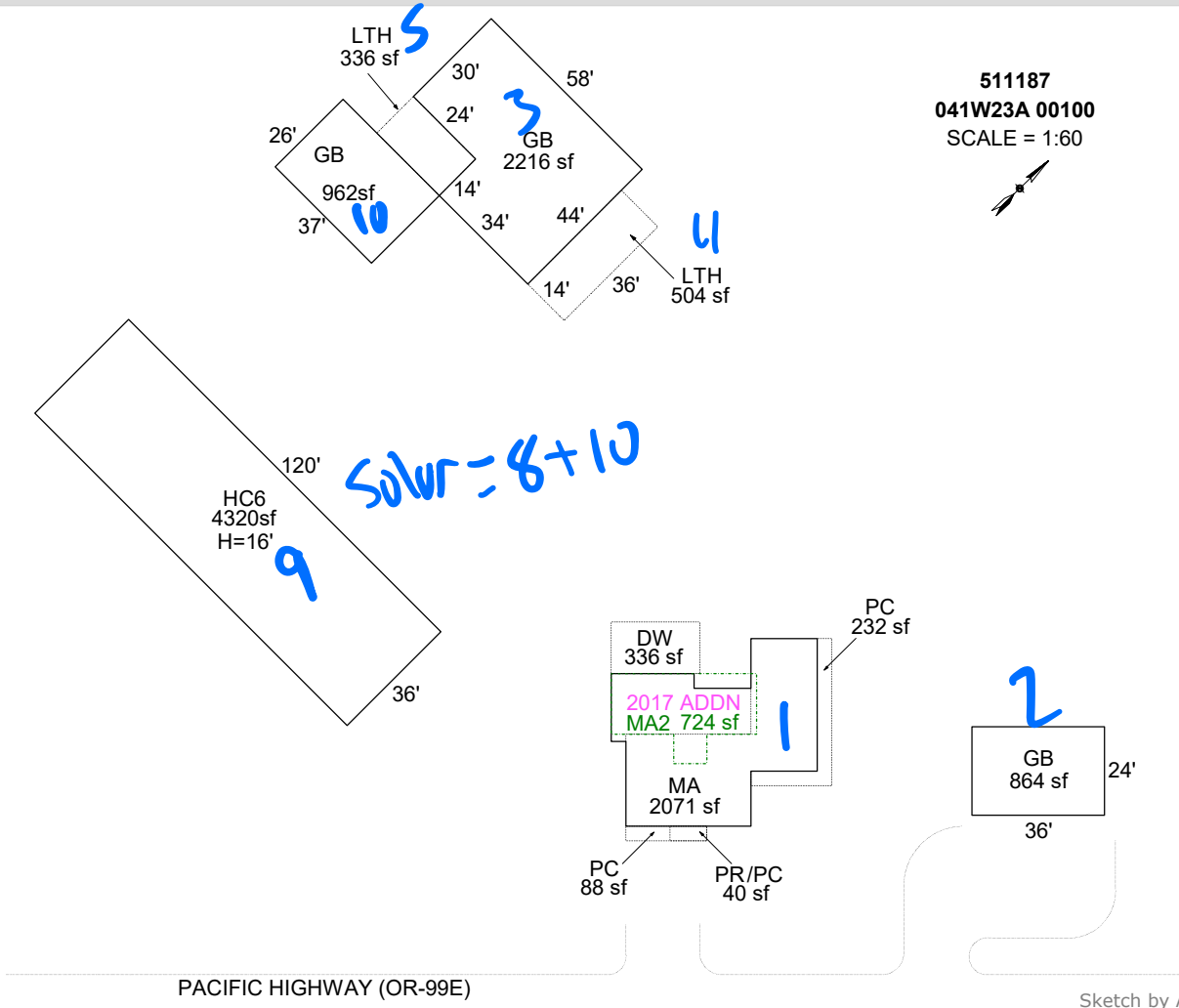

PACIFIC HIGHWAY (OR-99E)

Sketch by ApexSketch

AREA CALCULATIONS SUMMARY

Code	Description	Factor	Net Size	Perimeter	Net Totals
GBA1	LTH	1.0	504.0	100.0	
	LTH	1.0	336.0	76.0	
	HC6	1.0	4320.0	312.0	5160.0
GBA2	GB	1.0	864.0	120.0	
	GB	1.0	2216.0	204.0	
	GB	1.0	962.0	126.0	4042.0
GLA1	MA	1.0	2071.0	222.0	2071.0
GLA2	MA2	1.0	723.8	128.0	723.8
P/P	PR	1.0	40.0	28.0	
	PC	1.0	88.0	52.0	
	DW	1.0	336.0	76.0	
	PC	1.0	232.0	124.0	696.0
	Net LIVABLE	cnt	0 (rounded)		2,795
	Net BUILDING	cnt	0 (rounded)		9,202

COMMENT TABLE 1

DRAWN BY JRONDEMA 5/26/15
 UPDATED BY JRONDEMA 11/30/17, 12/12/18, 12/26/18
 UPDATED BY WWILLIAMS 8/17/23
 UPDATED BY CJURAN 02/13/2024 23-010392 GB
 UPDATED BY CLOBERG 03/06/25
 UPD BY WWILLIAMS 3/26/26

COMMENT TABLE 2

8/17/23 JS L4
 JJS 01/08/25
 JJS 1/20/26

COMMENT TABLE 3

TAGS
 TAGS L3
 TAGS L3

SKETCH/AREA TABLE ADDENDUM

SUBJECT INFO

File No.: 511187 Parcel No.: 041W23A 00100
 Property Address: 20457 HIGHWAY 99E NE
 City: AURORA County: MARION State: OR ZipCode: 97002
 Owner:
 Client: Client Address:
 Appraiser Name: Inspection Date:

SKETCH

511187
041W23A 00100
 SCALE = 1:20

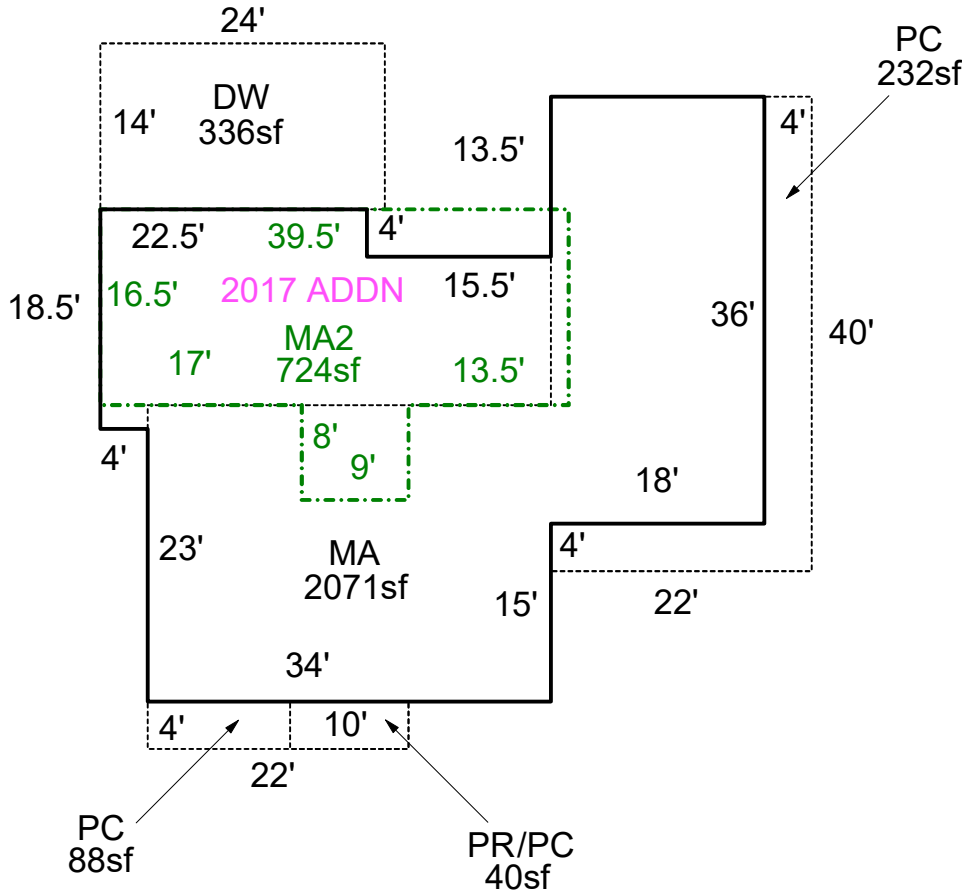

Sketch by ApexSketch

AREA CALCULATIONS SUMMARY

Code	Description	Factor	Net Size	Perimeter	Net Totals
GLA1	MA	1.0	2071.0	222.0	2071.0
GLA2	MA2	1.0	723.8	128.0	723.8
P/P	PR	1.0	40.0	28.0	
	DW	1.0	336.0	76.0	
	PC	1.0	232.0	124.0	
	PC	1.0	88.0	52.0	696.0

COMMENT TABLE 1

DRAWN BY JRONDEMA 5/26/15
 UPDATED BY JRONDEMA 11/30/17, 12/12/18, 12/26/18
 UPDATED BY WWILLIAMS 8/17/23
 UPDATED BY CJURAN 02/13/2024 23-010392 GB
 UPDATED BY CLOBERG 03/06/25
 UPD BY WWILLIAMS 3/26/26

COMMENT TABLE 2

8/17/23 JS L4
 JJS 01/08/25
 JJS 1/20/26

COMMENT TABLE 3

TAGS
 TAGS L3
 TAGS L3

Net LIVABLE cnt 0 (rounded) 2,795

SKETCH/AREA TABLE ADDENDUM

SUBJECT INFO

File No.: 511187 Parcel No.: 041W23A 00100
 Property Address: 20457 HIGHWAY 99E NE
 City: AURORA County: MARION State: OR ZipCode: 97002
 Owner:
 Client: Client Address:
 Appraiser Name: Inspection Date:

2017 - will be #10

SKETCH

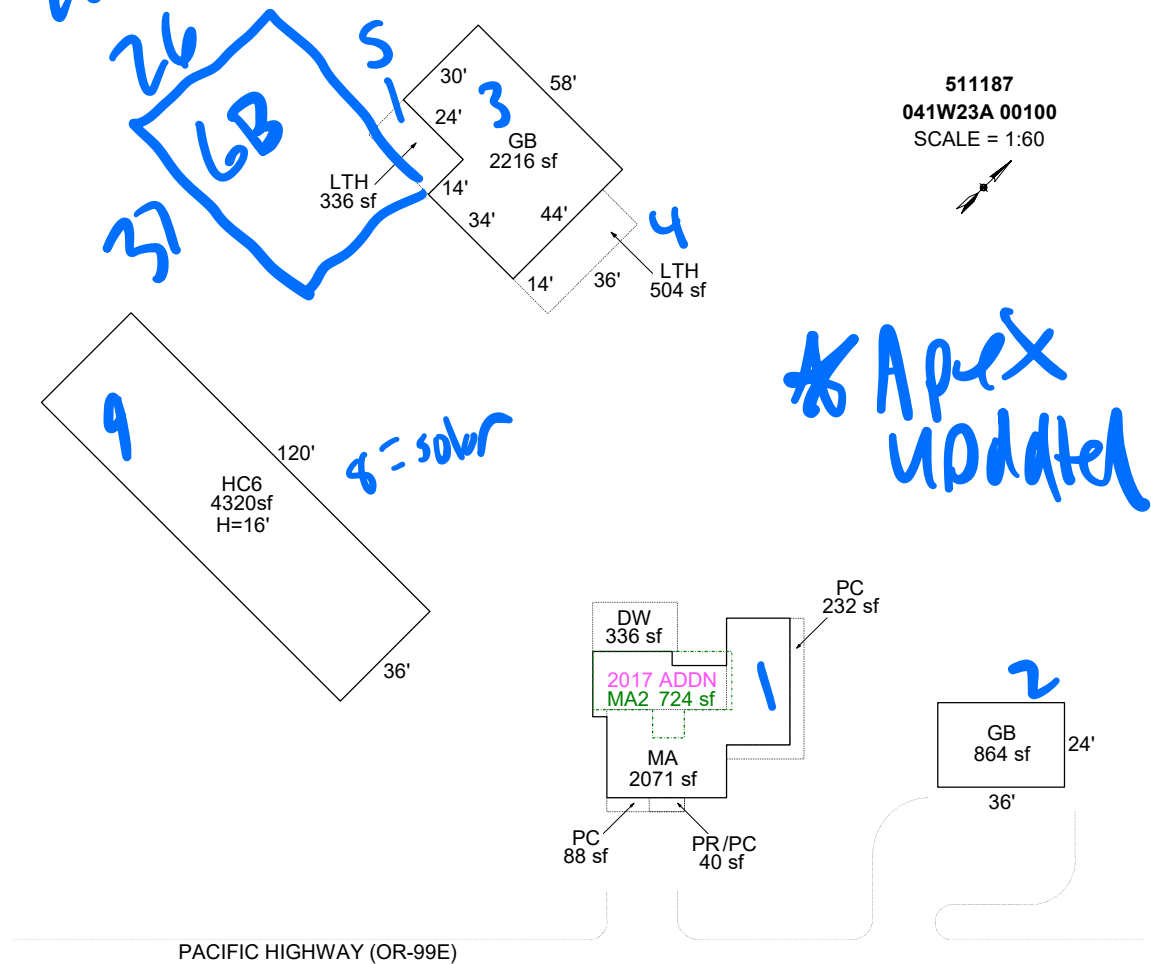

Sketch by ApexSketch

AREA CALCULATIONS SUMMARY

Code	Description	Factor	Net Size	Perimeter	Net Totals
GBA1	LTH	1.0	504.0	100.0	
	LTH	1.0	336.0	76.0	
	HC6	1.0	4320.0	312.0	5160.0
GBA2	GB	1.0	864.0	120.0	
	GB	1.0	2216.0	204.0	3080.0
GLA1	MA	1.0	2071.0	222.0	2071.0
GLA2	MA2	1.0	723.8	128.0	723.8
P/P	PR	1.0	40.0	28.0	
	PC	1.0	88.0	52.0	
	DW	1.0	336.0	76.0	
	PC	1.0	232.0	124.0	696.0
	Net LIVABLE	cnt	0 (rounded)		2,795
	Net BUILDING	cnt	5 (rounded)		8,240

COMMENT TABLE 1

DRAWN BY JRONDEMA 5/26/15
 UPDATED BY JRONDEMA 11/30/17
 UPDATED BY JRONDEMA 12/12/18
 UPDATED BY JRONDEMA 12/26/18
 UPDATED BY WWILLIAMS 8/17/23
 UPDATED BY CJURAN 02/13/2024 23-010392 GB
 UPDATED BY CLOBERG 03/06/25

COMMENT TABLE 2

8/17/23 JS L4
 JJS 01/08/25

COMMENT TABLE 3

TAGS
 TAGS L3

JJS 10.29.25 TAGS L3
 JJS 1.20.25 TAGS L3