

Acct ID: 517101 MTL: 061W34BC00400 Date: 10/2/25 Appr: MLH Prop Class: 451 RMV Prop Class: 451  
 Situs: 264 MONSON RD NE SILVERTON OR 97381 MaSaNh: 03 06 000 Unit: 83333 Year: 2025

Last Date Appraised: 01/15/2013 Appraiser: MATTHEW HAMILTON Tag: Y N Tag info: \_\_\_\_\_

Owner: ERIC & ANDREA VEGH RLT Last Sales Date: 05/29/2025 Roll Type: R

Cycle Tag Sales Verification Other: \_\_\_\_\_ Inspection level: 1 2 3 4 LCB TTO INSP AV: 601560

RMV Land: 415880 RMV Imp: 516880 RMV Total: 932760 MAV: 601560 MSAV: 0 SAV: 0

Comment: MLS 826582  
DOM 73

OSDs Sales Code 33, letter update Inventory Input MLH 11/5/25

Count	Code	Description	RMV	Code Area	Exception
1	MKTA	OSD - AVERAGE	50000	04500	0

**Land**

Site: 1 Code Area: 04500 Size: 1.00 Acres Use Code: 005 Zone: UT SAV Use: \_\_\_\_\_ Exception: 0  
 Class: ZBD Value Source: Rural Restrictive Description: \_\_\_\_\_ RMV: 50710 Exception: Y N  
 Adjustment(s): GSOIL, IRR Fire Patrol: \_\_\_\_\_ Description: \_\_\_\_\_  
 Comments: 18-19: DISQ FARM USE / 03-04:(F)03-0515; COMBINED R17100 INTO R17101 06-07: RECALC SETUP;#19 08-15-05

Site: 2 Code Area: 04500 Size: 0.88 Acres Use Code: 005 Zone: UT SAV Use: \_\_\_\_\_ Exception: 0  
 Class: ZBI Value Source: Rural Restrictive Description: \_\_\_\_\_ RMV: 44620 Exception: Y N  
 Adjustment(s): GSOIL, IRR Fire Patrol: \_\_\_\_\_ Description: \_\_\_\_\_  
 Comments: \_\_\_\_\_

Site: 3 Code Area: 04500 Size: 3.77 Acres Use Code: 005 Zone: UT SAV Use: \_\_\_\_\_ Exception: 0  
 Class: 28I Value Source: Rural Restrictive Description: TWO BENCH IRR RMV: 219840 Exception: Y N  
 Adjustment(s): GSOIL, IRR Fire Patrol: \_\_\_\_\_ Description: \_\_\_\_\_  
 Comments: 400028 05-06: THIS IS THE EFU PORTION OF THE PARCEL

Site: 4 Code Area: 04500 Size: 1.00 Acres Use Code: 005 Zone: UT SAV Use: \_\_\_\_\_ Exception: 0  
 Class: ZBI Value Source: Rural Restrictive Description: \_\_\_\_\_ RMV: 50710 Exception: Y N  
 Adjustment(s): GSOIL, IRR Fire Patrol: \_\_\_\_\_ Description: \_\_\_\_\_  
 Comments: //08-09: Market woodlot study by GW39 - change from woodlot to woodlot-M// 00400028

**Improvements - Residence / Manufactured Structures**

Bldg: 1 Code Area: 04500 Stat Class: 141 Year Blt: 1950 Eff Year Blt: 1988 Sq.Ft: 2644 % Complete: 100.00  
 Desc: One Story Only Dimensions: \_\_\_\_\_ RMV: 367350  
 Func Obsc: 100 Econ %: 100 Other %: 100 Exception: 0 Adjust: \_\_\_\_\_ Adjust RMV: 0

**Floors**

Type	Class	Display Group	Floor Size	Beds	Baths	Yr Blt	Eff Yr Blt	Inventory	Exception
First Floor	4	Finished	2644	3	FB-2/ HB-1	1950	1988	FP - 2, HVAC, ROOF, KIT, BTH - 1, BATH - 2	Y N

**Accessories**

Description	Class	Size SqFt	Eff Yr Blt	RMV	Quantity	Exception
YARD IMPROVEMENTS AVERAGE	4	1	2003	28890	1	Y N

**Improvements - Accessory Buildings**

Bldg: 2 Code Area: 04500 Stat Class: 351 Year Blt: 1988 Eff Year Blt: 2000 Sq.Ft: 2160 % Complete: 100.00  
 Desc: General Purpose Building (GB) MS Dimensions: 60x36 RMV: 12350  
 Func Obsc: 100 Econ %: 100 Other %: 100 Exception: 0 Adjust: \_\_\_\_\_ Adjust RMV: 0

**Floors**

Type	Class	Display Group	Floor Size	Beds	Baths	Yr Blt	Eff Yr Blt	Inventory	Exception
General Purpose Bldg	5	Finished	2160	0	0	1988	1988	FAIR <u>Ab</u>	Y N

**Accessories**

Description	Class	Size SqFt	Eff Yr Blt	RMV	Quantity	Exception
No accessory data available						

Bldg: 3 Code Area: 04500 Stat Class: 351 Year Blt: 1988 Eff Year Blt: 2000 Sq.Ft: 720-576 % Complete: 100.00  
 Desc: General Purpose Building (GB) Dimensions: 36x20 RMV: 4100  
 Func Obsc: 100 Econ %: 100 Other %: 100 Exception: 0 Adjust: \_\_\_\_\_ Adjust RMV: 0

**Floors**

Type	Class	Display Group	Floor Size	Beds	Baths	Yr Blt	Eff Yr Blt	Inventory	Exception
General Purpose Bldg	5	Finished	720	0	0	1988	1988	<u>Good</u>	Y N

**Accessories**

Description	Class	Size SqFt	Eff Yr Blt	RMV	Quantity
No accessory data available					

Bldg: 4 Code Area: 04500 Stat Class: 321 Year Blt: 1988 Eff Year Blt: 1988 Sq.Ft: 1080 % Complete: 100.00  
 Desc: Hay Cover (HC) Dimensions: 36x30 RMV: 2390  
 Func Obsc: 100 Econ %: 100 Other %: 100 Exception: 0 Adjust: Adjust RMV: 0

N/C

**Floors**

Type	Class	Display Group	Floor Size	Beds	Baths	Yr Blt	Eff Yr Blt	Inventory	Exception: Y N
Hay Cover	4	Finished	1080	0	0	1988	1988	FAIR	Exception: Y N

**Accessories**

Description	Class	Size SqFt	Eff Yr Blt	RMV	Quantity
No accessory data available					

Bldg: 5 Code Area: 04500 Stat Class: 341 Year Blt: 1983 Eff Year Blt: 1983 Sq.Ft: 144 % Complete: 100.00  
 Desc: Multi Purpose Shed (MP) Dimensions: 18x8 RMV: 730  
 Func Obsc: 100 Econ %: 100 Other %: 100 Exception: 0 Adjust: Adjust RMV: 0

I/O

**Floors**

Type	Class	Display Group	Floor Size	Beds	Baths	Yr Blt	Eff Yr Blt	Inventory	Exception: Y N
Multi-Purpose Bldg	4	Finished	144	0	0	1983	1983	FAIR	Exception: Y N

**Accessories**

Description	Class	Size SqFt	Eff Yr Blt	RMV	Quantity
No accessory data available					

Bldg: 6 Code Area: 04500 Stat Class: 316 Year Blt: 2003 Eff Year Blt: 2003 Sq.Ft: 13824 % Complete: 100.00  
 Desc: Arenas (HA) Dimensions: 192x72 RMV: 122960  
 Func Obsc: 100 Econ %: 100 Other %: 100 Exception: 0 Adjust: Adjust RMV: 0

N/C

**Floors**

Type	Class	Display Group	Floor Size	Beds	Baths	Yr Blt	Eff Yr Blt	Inventory	Exception: Y N
Horse Arena	5	Finished	13824	0	0	2003	2003	FAIR	Exception: Y N

**Accessories**

Description	Class	Size SqFt	Eff Yr Blt	RMV	Quantity
No accessory data available					

Bldg: 7 Code Area: 04500 Stat Class: 354 Year Blt: 2008 Eff Year Blt: 2008 Sq.Ft: 192 % Complete: 100.00  
 Desc: Lean-to Light (LTL) Dimensions: 24x8 RMV: 710  
 Func Obsc: 100 Econ %: 100 Other %: 100 Exception: 0 Adjust: Adjust RMV: 0

I/O

**Floors**

Type	Class	Display Group	Floor Size	Beds	Baths	Yr Blt	Eff Yr Blt	Inventory	Exception: Y N
Lean-to Light Duty	5	Finished	192	0	0	2008	2008	FAIR	Exception: Y N

**Accessories**

Description	Class	Size SqFt	Eff Yr Blt	RMV	Quantity
No accessory data available					

Bldg: 9 Code Area: 04500 Stat Class: 354 Year Blt: 1988 Eff Year Blt: 1988 Sq.Ft: 256 % Complete: 100.00  
 Desc: Lean-to Light (LTL) Dimensions: 8x32 RMV: 290  
 Func Obsc: 100 Econ %: 100 Other %: 100 Exception: 0 Adjust: Adjust RMV: 0

I/O

**Floors**

Type	Class	Display Group	Floor Size	Beds	Baths	Yr Blt	Eff Yr Blt	Inventory	Exception: Y N
Lean-to Light Duty	5	Finished	256	0	0	1988	1988		Exception: Y N

**Accessories**

Description	Class	Size SqFt	Eff Yr Blt	RMV	Quantity
No accessory data available					

Bldg: 10 Code Area: 04500 Stat Class: 905 Year Blt: 2012 Eff Year Blt: 2012 Sq.Ft: 0 % Complete: 100.00  
 Desc: Rural Solar Panel/Array Dimensions: RMV: 6000  
 Func Obsc: 100 Econ %: 100 Other %: 100 Exception: 0 Adjust: Adjust RMV: 0

N/C

**Floors**

Type	Class	Display Group	Floor Size	Beds	Baths	Yr Blt	Eff Yr Blt	Inventory	Exception: Y N
No floor data available									

**Accessories**

Description	Class	Size SqFt	Eff Yr Blt	RMV	Quantity
No accessory data available					

LTL 6x18 2000 I/O



# SKETCH/AREA TABLE ADDENDUM

## SUBJECT INFO

File No.: 517101 Parcel No.: 061W34BCC 00400  
 Property Address: 264 Monson Rd NE  
 City: Silverton County: State: OR ZipCode: 97381  
 Owner:  
 Client: Client Address:  
 Appraiser Name: Inspection Date:

## SKETCH

517101  
061W34BC 00400



See Page 1 for all structures

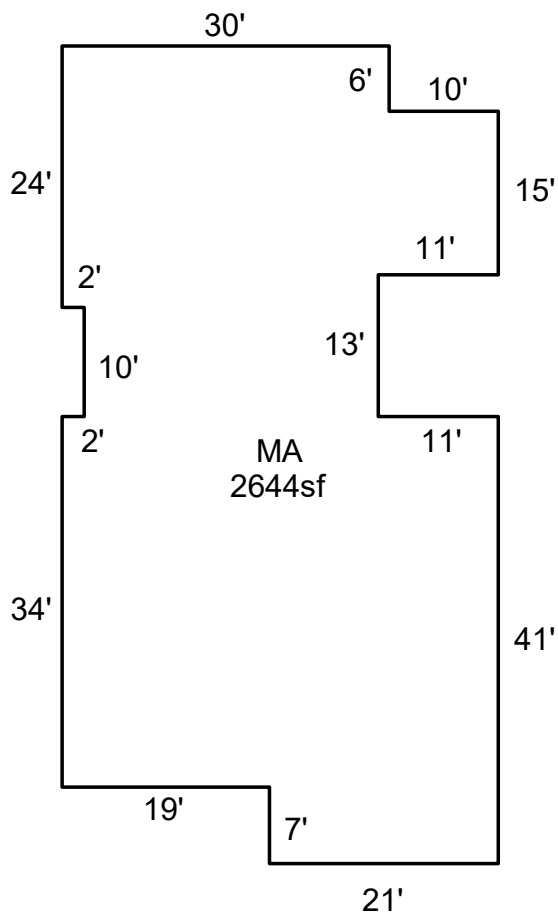

Sketch by ApexSketch

### AREA CALCULATIONS SUMMARY

Code	Description	Factor	Net Size	Perimeter	Net Totals
GLA1	MA	1.0	2644.0	256.0	2644.0
	Net LIVABLE	cnt	0 (rounded)		2,644

### COMMENT TABLE 1

Apex by JA 4/23/09  
 Apex edit by JA 5-6-09  
 Edit to add 12 Solar Panels 3/15/13 Jane  
 UPDATED BY CLOBERG 12/30/25

### COMMENT TABLE 2

MLH 10/02/25

### COMMENT TABLE 3

SV L4

