

Summary

Lead Appr: WW Clerk: _____ Lead Clerk: _____ Appr: MLH 3/18/26

Print Date:

9/26/2025

Acct ID: 521163 MTL: 071W060001400 Date: 11/21/25 Appr: MLH Prop Class: 5591 RMV Prop Class: 4591
Situs: 9982 SILVERTON RD NE SILVERTON OR 97381 MaSaNh: 03 06 000 Unit: 87000 Year: 2025
2026

Last Date Appraised: 07/01/2013 Appraiser: MATTHEW HAMILTON Tag: Y N Tag info: 2026 - NEW CONSTRUCTION (Residence)

Owner: LICHTY, ANDREW R Last Sales Date: 07/14/2009 Roll Type: R

Cycle: Tag Sales Verification Other: _____ Inspection level: 1 2 3 4 LCB TTC INSP 11/25/25 AV: 126058

RMV Land: 363180 RMV Imp: 106430 RMV Total: 469610 MAV: 105300 MSAV: 20758 SAV: 111699

Comment:

NEW MA @ 55%
update Inventory Retag for '27

Input MLH 2/13/26
Farm?

Notations

RP/MS	Code	Description
MS	ZONED	FARM EFU ZONED

CWO 3/6/26

OSDs

Count	Code	Description	RMV	Code Area	Exception
1	SAA	SA OSD - AVERAGE	50000	04500	0

Land

Site: 1 Code Area: 04500 Size: 1.00 Acres Use Code: 005 Zone: REST SAV Use: 011 Exception: 0
 Class: 0 Value Source: Farm Homesite Description: RMV: 87580 Exception: Y N
 Adjustment(s): GSOIL, IRR Fire Patrol: Description:
 Comments: Liability year - 2009 / 01-02; UPDATED LAND MKT VALUE BASED ON PT INFORMATION /02-03; CHANGED LAND TABLE FROM 93UA TO 00G TO REFLECT PART TOTAL INFORMATION 05-06: PART TOTALS UPDATED 05-06: F04-0857 COMBINES R21160 INTO R21163 05-06: F04-0859 LLA BETWEEN R21163 & R21164 / 06-07: INCREASE HOMESITE SIZE TO ONE ACRE AS PRESCRIBED BY STATUTE AND PICKING UP EXCEPTION VALUE, NO PAT LIAB WILL BE COLLECTED. 06-07: RECALC SETUP;#31 3-24-06

Site: 3 Code Area: 04500 Size: 2.24 Acres Use Code: 005 Zone: REST SAV Use: 011 Exception: 0
 Class: 2BI Value Source: Farm Use - EFU Description: TWO BENCH IRR RMV: 225600 Exception: Y N
 Adjustment(s): GSOIL, IRR Fire Patrol: Description:
 Comments: Liability year - 1974 / 400028/ 01-02: COMBINED LAND SEGGS - SAME SOIL CLASS, SAME LIAB YR, 19.58 TTL ACRES /01-02; UPDATED LAND MKT VALUE BASED ON PT INFORMATION

Improvements - Residence / Manufactured Structures

Bldg: 1 Code Area: 04500 Stat Class: 138 Year Blt: 1977 Eff Year Blt: 1977 Sq.Ft: 0 % Complete: 100.00
 Desc: Res other improvements Dimensions: RMV: 57140
 Func Obsc: 100 Econ %: 100 Other %: 100 Exception: 0 Adjust: Adjust RMV: 0

Floors

Type	Class	Display Group	Floor Size	Beds	Baths	Yr Blt	Eff Yr Blt	Inventory	Exception
Garage Detached	3	Unfinished	768	0	0	1977	1977	ROOF	Y N

Accessories

Description	Class	Size SqFt	Eff Yr Blt	RMV	Quantity
YARD IMPROVEMENTS FAIR	3	1	1977	8239	1

Bldg: 2 Code Area: 04500 Stat Class: 456 Year Blt: 1978 Eff Year Blt: 1978 Sq.Ft: 1440 % Complete: 100.00
 Desc: MANUF STRUCT, CLASS 5, 24' WIDE DOUBLE Dimensions: RMV: 43880
 Func Obsc: 100 Econ %: 100 Other %: 100 Exception: 0 Adjust: Adjust RMV: 0 Subtype: E

Floors

Type	Class	Display Group	Floor Size	Beds	Baths	Yr Blt	Eff Yr Blt	Inventory	Exception
First Floor	5	Finished	1440	3	FB-2	1978	1978	ROOF, SKRT+, HVAC+, KIT-, BATH - 2	Y N

Accessories

Description	Class	Size SqFt	Eff Yr Blt	RMV	Quantity
No accessory data available					

Improvements - Accessory Buildings

Bldg: 3 Code Area: 04500 Stat Class: 353 Year Blt: 1979 Eff Year Blt: 1979 Sq.Ft: 1200 % Complete: 100.00
 Desc: Machine Shed (MS) Dimensions: 40x30 RMV: 2190
 Func Obsc: 100 Econ %: 100 Other %: 100 Exception: 0 Adjust: Adjust RMV: 0

Floors

Type	Class	Display Group	Floor Size	Beds	Baths	Yr Blt	Eff Yr Blt	Inventory	Exception
Machine Shed	4	Finished	1200	0	0	1979	1979	<u>Fair</u>	Y N

Accessories

Description	Class	Size SqFt	Eff Yr Blt	RMV	Quantity
No accessory data available					

Bldg: 4 Code Area: 04500 Stat Class: 341 Year Blt: 2005 Eff Year Blt: 2005 Sq.Ft: 160 % Complete: 100.00
 Desc: Multi Purpose Shed (MP) Dimensions: 16x10 RMV: 2300
 Func Obsc: 100 Econ %: 100 Other %: 100 Exception: 0 Adjust: Adjust RMV: 0

F/O

Floors

Type	Class	Display Group	Floor Size	Beds	Baths	Yr Blt	Eff Yr Blt	Inventory	Exception: Y N
Multi-Purpose Bldg	5	Finished	160	0	0	2005	2005	<i>Fail</i>	

Accessories

Description	Class	Size SqFt	Eff Yr Blt	RMV	Quantity
No accessory data available					

2000

Bldg: 5 Code Area: 04500 Stat Class: 354 Year Blt: 2012 Eff Year Blt: 2012 Sq.Ft: 300 % Complete: 100.00
 Desc: Lean-to Light (LTL) Dimensions: 30x10 RMV: 920
 Func Obsc: 100 Econ %: 100 Other %: 100 Exception: 0 Adjust: Adjust RMV: 0

F/O

Floors

Type	Class	Display Group	Floor Size	Beds	Baths	Yr Blt	Eff Yr Blt	Inventory	Exception: Y N
Lean-to Light Duty	4	Finished	300	0	0	2012	2012		

Accessories

Description	Class	Size SqFt	Eff Yr Blt	RMV	Quantity
No accessory data available					

Bldg: 6 Code Area: 04500 Stat Class: 341 Year Blt: Eff Year Blt: Sq.Ft: 60 % Complete: 100.00
 Desc: Multi Purpose Shed (MP) Dimensions: RMV: 0
 Func Obsc: 100 Econ %: 100 Other %: 100 Exception: 0 Adjust: Adjust RMV: 0

N/C

Floors

Type	Class	Display Group	Floor Size	Beds	Baths	Yr Blt	Eff Yr Blt	Inventory	Exception: Y N
Multi-Purpose Bldg	5	Finished	60	0	0	0	0		

Accessories

Description	Class	Size SqFt	Eff Yr Blt	RMV	Quantity
No accessory data available					

Permits

Permit Number	Permit ID	Origin	Category	Type	Estimate Value	% Complete	Roll Type	Description
25-002225	83772	MARION COUNTY	NEW CONSTRUCTION	RESIDENCE	594444	0	R	4BD/4BTH SFD W/ OFFICE, 2 BONUS RMS, & ATTACHED GARAGE TO REPLACE EXISTING 3BDRM SFD

Farm Notes

2022FARM

2-28-22: Sent new owner self reporting F/F letter, due back in 30 days.

355 LTH 2000 12x30 F/O





ACCOUNT # _____ DATE: _____ RMV CLASS _____ PROP CLASS _____
 MTL _____ APPR _____ TAG Y N _____
 COMMENTS: _____

RESIDENCE / MANUFACTURED STRUCTURES

ACCESSORY IMPROVEMENTS / OUTBUILDINGS

STAT 152 QLTY + 0 FLOOR MA
 AREA 1879 EFF AREA _____ BED 2
ROOF + HVAC +
 BATH PKG: 2 BATH _____ BATH + 1 1/2 BTH
 FIREPLACE: 1
KITCHEN - +
 YR BLT 2025 EFF YR 2025 ECON _____
 % COMP 55 % GOOD _____ FUNC _____
 EXCEPT Y N LUMP SUM: _____
 MISC: _____
 YI CLASS 5 F G A E
 SKIRT + LIN FT _____
 COMMENT: _____

TYPE _____
 STAT / CLASS _____
 SIZE _____
 FAIR
 AVERAGE
 GOOD
 EXCELLENT
 BATH _____
 YR BLT _____
 EFF YR _____
 % COMP _____
 EXCEPT Y N
 MISC: _____
 COMMENT: _____

TYPE _____
 STAT / CLASS _____
 SIZE _____
 FAIR
 AVERAGE
 GOOD
 EXCELLENT
 BATH _____
 YR BLT _____
 EFF YR _____
 % COMP _____
 EXCEPT Y N
 MISC: _____
 COMMENT: _____

STAT _____ QLTY + - FLOOR MAZ
 AREA 957 EFF AREA _____ BED 2
 ROOF + HVAC +
 BATH PKG: 1 BATH _____ BATH + _____ 1/2 BTH
 FIREPLACE: _____
 KITCHEN - +
 YR BLT 2025 EFF YR 2025 ECON _____
 % COMP 55 % GOOD _____ FUNC _____
 EXCEPT Y N LUMP SUM: _____
 MISC: _____
 YI CLASS _____ F G A E
 SKIRT + LIN FT _____
 COMMENT: _____

TYPE _____
 STAT / CLASS _____
 SIZE _____
 FAIR
 AVERAGE
 GOOD
 EXCELLENT
 BATH _____
 YR BLT _____
 EFF YR _____
 % COMP _____
 EXCEPT Y N
 MISC: _____
 COMMENT: _____

TYPE _____
 STAT / CLASS _____
 SIZE _____
 FAIR
 AVERAGE
 GOOD
 EXCELLENT
 BATH _____
 YR BLT _____
 EFF YR _____
 % COMP _____
 EXCEPT Y N
 MISC: _____
 COMMENT: _____

STAT _____ QLTY + - FLOOR AGF
 AREA 950 EFF AREA _____ BED _____
ROOF + HVAC +
 BATH PKG: _____ BATH _____ BATH + _____ 1/2 BTH
 FIREPLACE: _____
 KITCHEN - +
 YR BLT 2025 EFF YR 2025 ECON _____
 % COMP 56 % GOOD _____ FUNC _____
 EXCEPT Y N LUMP SUM: _____
 MISC: _____
 YI CLASS _____ F G A E
 SKIRT + LIN FT _____
 COMMENT: _____

TYPE _____
 STAT / CLASS _____
 SIZE _____
 FAIR
 AVERAGE
 GOOD
 EXCELLENT
 BATH _____
 YR BLT _____
 EFF YR _____
 % COMP _____
 EXCEPT Y N
 MISC: _____
 COMMENT: _____

TYPE _____
 STAT / CLASS _____
 SIZE _____
 FAIR
 AVERAGE
 GOOD
 EXCELLENT
 BATH _____
 YR BLT _____
 EFF YR _____
 % COMP _____
 EXCEPT Y N
 MISC: _____
 COMMENT: _____

Percent Complete Form

Account # _____

Additions

New Homes

<u>Additions</u>		<u>New Homes</u>			
		<u>No Basement</u>		<u>Basement</u>	
% Item	% Sum	% Item	% Sum	% Item	% Sum
3%		Plans/Survey	3%		3%
2%	0%	Excavation	2%	0%	4%
3%		Foundation	3%		10%
35%	45%	Framing	14%	20%	16%
8%	50%	Trusses	7%	30%	7%
7%	60%	Roofing	7%	35%	7%
7%	65%	Windows/Ext Doors	7%	45%	6%
5%	70%	Siding	5%	50%	5%
4%	75%	Plumbing Rough-In	4%	55%	3%
3%		Electrical Rough-In	3%	55%	2%
2%		Heating Rough-In	2%		1%
	80%	Heating Unit	1%		1%
3%		Insulation	3%	60%	2%
5%	85%	Drywall (Finished)	5%	65%	4%
2%	90%	Paint Interior	2%	70%	2%
2%		Paint Exterior	2%		2%
		Cabinets	6%	75%	5%
2%		Electrical Fixtures	3%	80%	2%
2%	95%	Plumbing Fixtures	4%	85%	3%
3%		Floor Coverings & Countertops	7%	90%	6%
2%	100%	Interior Trim Carpentry	7%	95%	6%
		Porch/Entry/Stoop	2%		2%
		Finish Grade	1%	100%	1%

APPR MLH Date 1/1/26 YR For 26-27 % COMP 55
 APPR _____ Date _____ YR For _____ % COMP _____
 APPR _____ Date _____ YR For _____ % COMP _____
 APPR _____ Date _____ YR For _____ % COMP _____

Percent Complete Form

Account # _____

Gut & Remodels

Interior Trim Carpentry	7%	90%
Floor Coverings & Countertops	7%	85%
Plumbing Fixtures	4%	80%
Electrical Fixtures	3%	80%
Cabinets	6%	75%
Drywall (Finished)	5%	70%
Insulation	3%	65%

APPR _____ Date _____ YR For _____ % COMP _____
 APPR _____ Date _____ YR For _____ % COMP _____
 APPR _____ Date _____ YR For _____ % COMP _____
 APPR _____ Date _____ YR For _____ % COMP _____

Outbuilding Type: _____

	% Item	% Sum
Excavation/Foundation	10%	
Floor - Concrete/Wood	30%	40%
Walls - Framing	10%	
Walls - Covering/Siding	15%	65%
Roof - Framing/Trusses	15%	
Roof - Sheathing	5%	95%
Roof - Cover	10%	
Doors & Windows	5%	100%

APPR _____ Date _____ YR For _____ % COMP _____
 APPR _____ Date _____ YR For _____ % COMP _____
 APPR _____ Date _____ YR For _____ % COMP _____
 APPR _____ Date _____ YR For _____ % COMP _____

SKETCH/AREA TABLE ADDENDUM

SUBJECT INFO

File No.: 521163 Parcel No.: 071W06 01400
 Property Address: 9982 silverton Rd NE
 City: Silverton County: State: OR ZipCode: 97381
 Owner:
 Client: Client Address:
 Appraiser Name: Inspection Date:

SKETCH

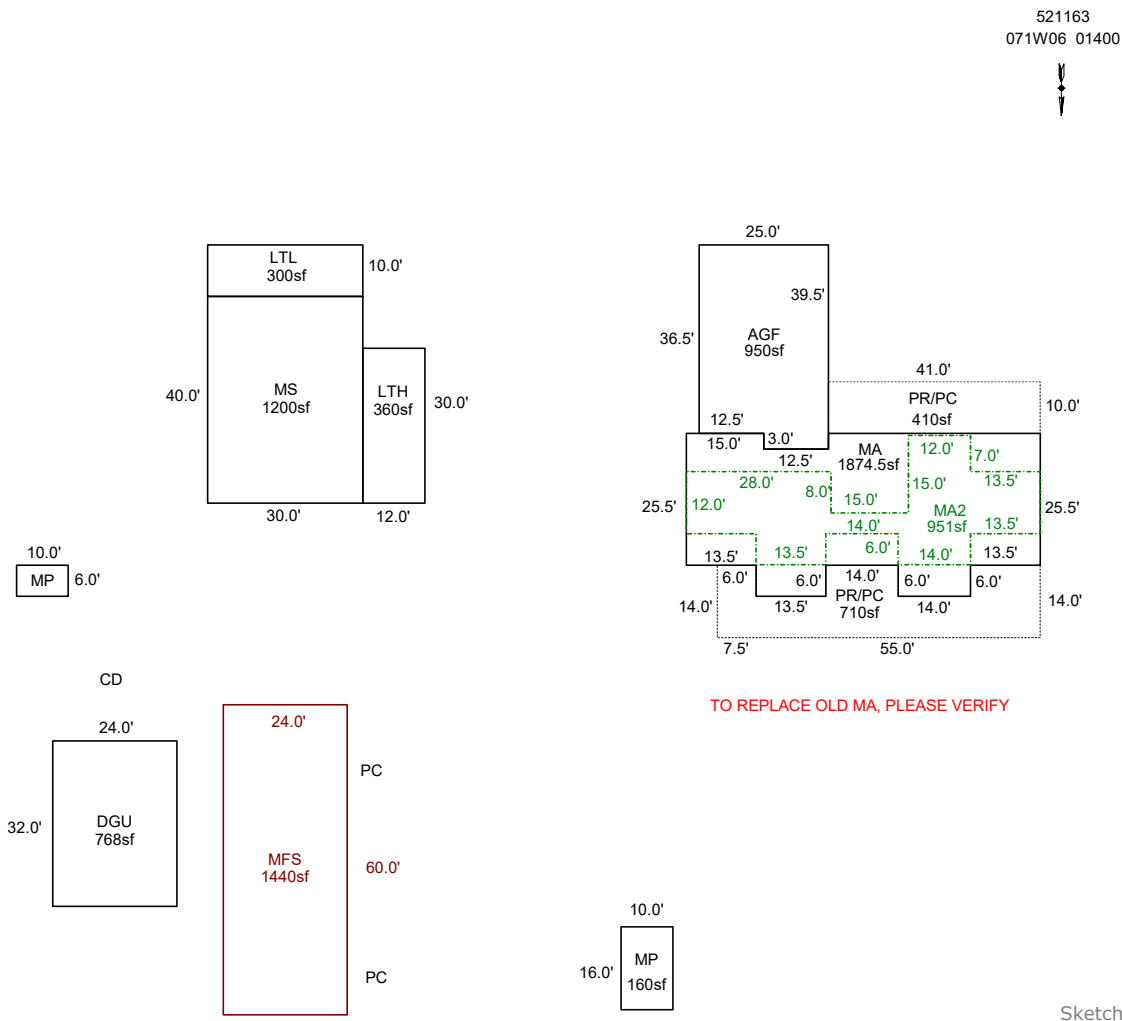

AREA CALCULATIONS SUMMARY

Code	Description	Factor	Net Size	Perimeter	Net Totals
GBA1	MP	1.0	60.0	32.0	
	LTL	1.0	300.0	80.0	360.0
GLA1	MFS	1.0	1440.0	168.0	1440.0
GAR	MA2	1.0	951.0	215.0	951.0
	DGU	1.0	768.0	112.0	
	AGF	1.0	950.0	129.0	1718.0
LTH	LTH	1.0	360.0	84.0	360.0
MA	MA	1.0	1874.3	218.0	1874.3
OTH	MS	1.0	1200.0	140.0	
	MP	1.0	160.0	52.0	1360.0
P/P	PR/PC	1.0	410.0	102.0	
	PR/PC	1.0	710.0	177.0	1120.0
	Net LIVABLE	cnt	4 (rounded)		5,392
	Net BUILDING	cnt	0 (rounded)		360

COMMENT TABLE 1

Apex by JA 12/11/09
 Updated to add MP and LTL 7/17/13-Jane
 UPDATED BY CLOBERG 07/07/25 25-002225 MA
 UPDATED BY CLOBERG 03/19/26

COMMENT TABLE 2

MLH 11/21/25

COMMENT TABLE 3

TAGS L2

SKETCH/AREA TABLE ADDENDUM

SUBJECT INFO

File No.: 521163 Parcel No.: 071W06 01400
 Property Address: 9982 silverton Rd NE
 City: Silverton County: State: OR ZipCode: 97381
 Owner:
 Client: Client Address:
 Appraiser Name: Inspection Date:

SKETCH

521163
071W06 01400

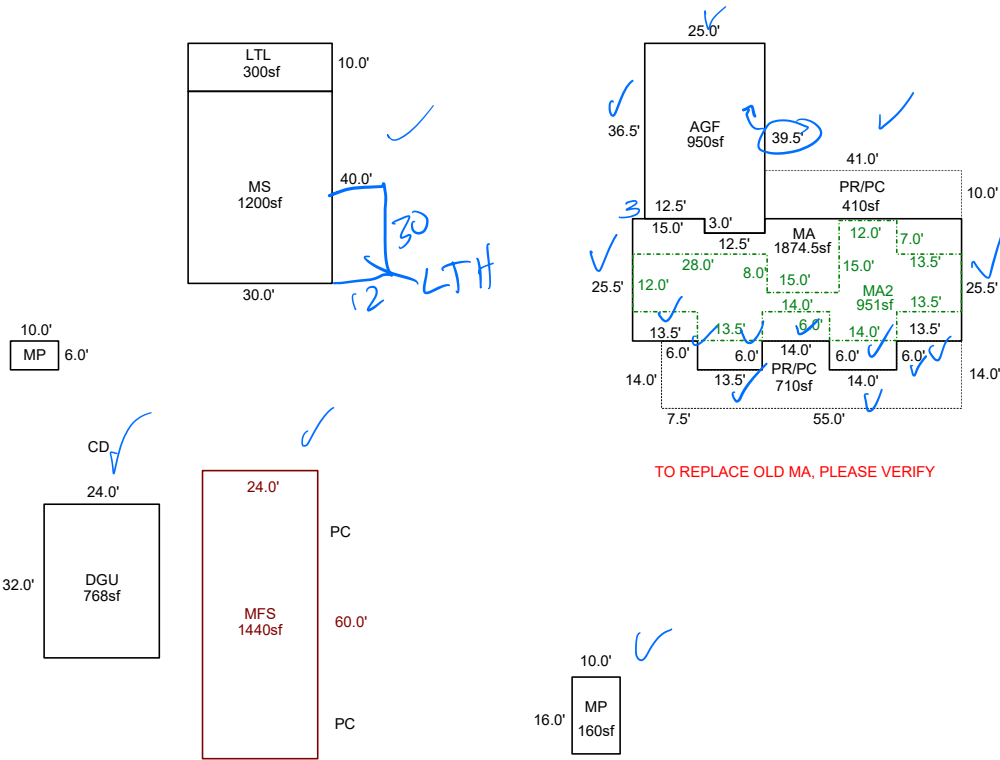

Sketch by ApexSketch

AREA CALCULATIONS SUMMARY

Code	Description	Factor	Net Size	Perimeter	Net Totals
GBA1	MP	1.0	60.0	32.0	
	LTL	1.0	300.0	80.0	360.0
GLA1	MFS	1.0	1440.0	168.0	1440.0
MA2	MA2	1.0	951.0	215.0	951.0
GAR	DGU	1.0	768.0	112.0	
	AGF	1.0	950.0	129.0	1718.0
MA	MA	1.0	1874.3	218.0	1874.3
OTH	MS	1.0	1200.0	140.0	
	MP	1.0	160.0	52.0	1360.0
P/P	PR/PC	1.0	410.0	102.0	
	PR/PC	1.0	710.0	177.0	1120.0
	Net LIVABLE	cnt	2 (rounded)		4,265
	Net BUILDING	cnt	2 (rounded)		360

COMMENT TABLE 1

Apex by JA 12/11/09
 Updated to add MP and LTL 7/17/13-Jane
 UPDATED BY CLOBERG 07/07/25 25-002225 MA

COMMENT TABLE 2

COMMENT TABLE 3

11/21/25 M2H Tags LZ