

Summary

Lead Appr: WW 11/20 Clerk: Lead Clerk: Appr: MLH 3/16/26

Print Date: 9/26/2025

Acct ID: 523701 MTL: 072W26D000100 Date: 11/10/25 Appr: MLH Prop Class: 551 RMV Prop Class: 551 SO1
Situs: 323 HOWELL PRAIRIE RD NE SALEM OR 97317 MaSaNh: 03 06 000 Unit: 65687 Year: 2025

Last Date Appraised: 04/26/2016 Appraiser: MATTHEW HAMILTON Tag: Y N Tag info: 2026 - NEW CONSTRUCTION (Outbuilding)

Owner: SCHURTER, KYLE Last Sales Date: 01/14/2016 Roll Type: R

Cycle Tag Sales Verification Other: Inspection level: 1 2 3 4 LCB TCO INSP AV: 260753

RMV Land: 571390 RMV Imp: 367290 RMV Total: 938680 MAV: 207010 MSAV: 53743 SAV: 130534

Comment: new UB @ 100% update inventory close tag email estimate

Notations

RP/MS	Code	Description
RP	ZONED	FARM EFU ZONED

OSDs CWO 1/13/25 check new aerials 5/1/27 may need to adjust hs acreage for expanded farm use.

Count	Code	Description	RMV	Code Area	Exception
1	SAA	SA OSD - AVERAGE	50000	92410	0

Land

Site: 1 Code Area: 92410 Size: 2.00 Acres Use Code: 005 Zone: REST SAV Use: 011 Exception: 0
 Class: Value Source: Farm Homesite Description: RMV: 38360 Exception: Y N
 Adjustment(s): GSOIL, IRR Fire Patrol: Description:
 Comments: Liability year - 2009 / 17-18: PER #102 INCREASE HOMESITE TO 2.0 ACRES. RECAPTURE PORTION OF DEF TAXES OF 1.0 ACRE IF DISQ BY 2027-28//05-06: RECALC SETUP; APPR NO.31, 6/15/04

Site: 3 Code Area: 92410 Size: 21.90 Acres Use Code: 005 Zone: REST SAV Use: 011 Exception: 0
 Class: 2BI Value Source: Farm Use - EFU Description: TWO BENCH IRR RMV: 483030 Exception: Y N
 Adjustment(s): GSOIL, IRR Fire Patrol: Description:
 Comments: Liability year - 1974

Improvements - Residence / Manufactured Structures

Bldg: 1 Code Area: 92410 Stat Class: 143 Year Blt: 1972 Eff Year Blt: 1982 Sq.Ft: 2178 % Complete: 100.00
 Desc: One Story with basement Dimensions: RMV: 354590
 Func Obsc: 100 Econ %: 100 Other %: 100 Exception: 0 Adjust: Adjust RMV: 0

Floors

Type	Class	Display Group	Floor Size	Beds	Baths	Yr Blt	Eff Yr Blt	Inventory	Exception
First Floor	4	Finished	1719	3	FB-1/ HB-1	1972	1982	FP - 1, HVAC, ROOF, KIT+, BTH - 1, BATH - 1	Y N
Basement	4	Finished	459	0	FB-1	1972	1982	HVAC, BATH - 1	Y N
Basement	4	Unfinished	405	0	0	1972	1982		Y N

Accessories

Description	Class	Size SqFt	Eff Yr Blt	RMV	Quantity	Exception
YARD IMPROVEMENTS AVERAGE	4	1	1982	25359	1	Y N

Improvements - Accessory Buildings

Bldg: 2 Code Area: 92410 Stat Class: 351 Year Blt: 1991 Eff Year Blt: 1991 Sq.Ft: 1536 % Complete: 100.00
 Desc: General Purpose Building (GB) Dimensions: 48x32 RMV: 10890
 Func Obsc: 100 Econ %: 100 Other %: 100 Exception: 0 Adjust: Adjust RMV: 0

Floors

Type	Class	Display Group	Floor Size	Beds	Baths	Yr Blt	Eff Yr Blt	Inventory	Exception
General Purpose Bldg	5	Finished	1536	0	0	1991	1991	FAIR	Y N

Accessories

No accessory data available

Bldg: 3 Code Area: 92410 Stat Class: 341 Year Blt: 2000 Eff Year Blt: 2000 Sq.Ft: 120 % Complete: 100.00
 Desc: Multi Purpose Shed (MP) Dimensions: 12x10 RMV: 1810
 Func Obsc: 100 Econ %: 100 Other %: 100 Exception: 0 Adjust: Adjust RMV: 0

Floors

Type	Class	Display Group	Floor Size	Beds	Baths	Yr Blt	Eff Yr Blt	Inventory	Exception
Multi-Purpose Bldg	5	Finished	120	0	0	2000	2000	FAIR	Y N

Accessories

Description	Class	Size SqFt	Eff Yr Blt	RMV	Quantity
No accessory data available					

Permits

Permit Number	Permit ID	Origin	Category	Type	Estimate Value	% Complete	Roll Type	Description
25-002074	83639	MARION COUNTY	NEW CONSTRUCTION	OUTBUILDING	0	0	R	AGEX 94 X 140 Storage Bldg for Farm use, No plmg

352 UB 5 94x140 Fair 2025 NEW



SKETCH/AREA TABLE ADDENDUM

SUBJECT INFO

File No.: 523701 Parcel No.: 072W26D 00100
 Property Address: 323 HOWELL PRAIRIE RD NE
 City: SALEM County: MARION State: OR ZipCode: 97317
 Owner:
 Client: Client Address:
 Appraiser Name: Inspection Date:

SKETCH

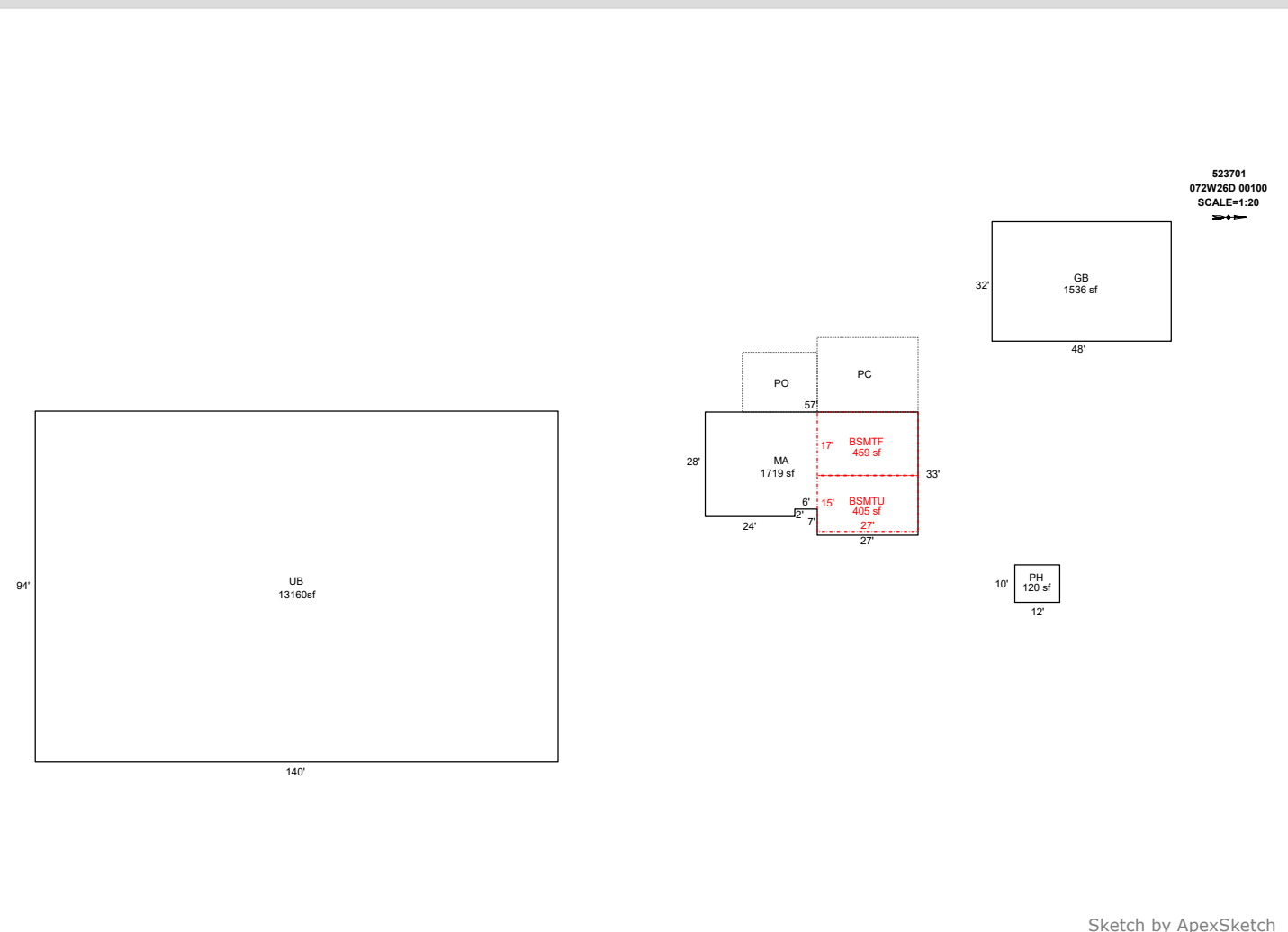

AREA CALCULATIONS SUMMARY

Code	Description	Factor	Net Size	Perimeter	Net Totals
GBA1	PH	1.0	120.0	44.0	
	GB	1.0	1536.0	160.0	1656.0
GLA0	BSMTF	1.0	459.0	88.0	459.0
GLA1	MA	1.0	1719.0	184.0	1719.0
BSMT	BSMTU	1.0	405.0	84.0	405.0
UB	UB	1.0	13160.0	468.0	13160.0
	Net LIVABLE	cnt	1 (rounded)		15,338
	Net BUILDING	cnt	0 (rounded)		1,656

COMMENT TABLE 1

DRAWN BY JRONDEMA 4/28/16
 UPDATED BY CLOBERG 03/17/26

COMMENT TABLE 2

MLH 11/18/25

COMMENT TABLE 3

TAGS L1

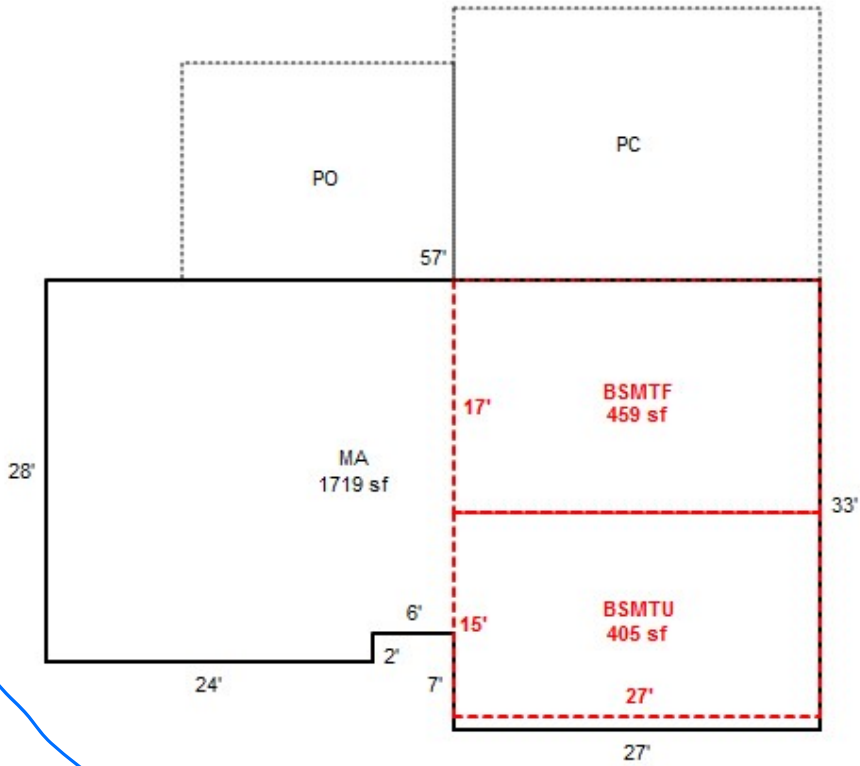
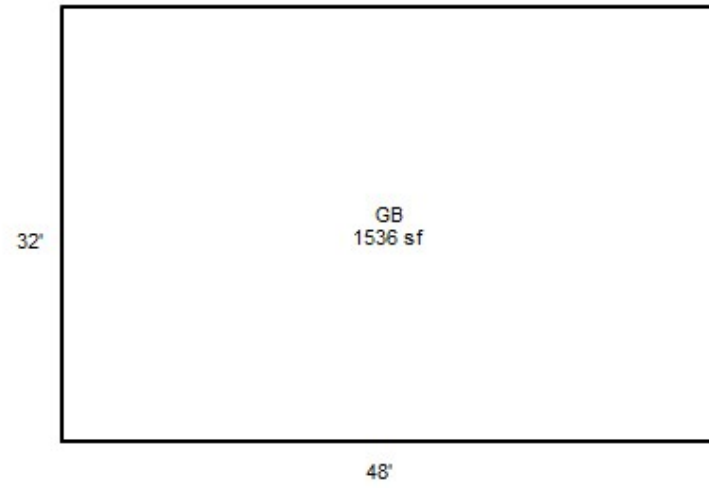

140
UB 94

MLH
1/18/25 TAGSLI

