

Acct ID: 533982 MTL: 091W04B000900 Date: 3.20.26 Appr: JJS Prop Class: 551 RMV Prop Class: 551
 Situs: 9384 GOLF CLUB RD SE AUMSVILLE OR 97325 MaSaNh: 07 06 000 Unit: 29497 Year: 2026

Last Date Appraised: 02/03/2022 Appraiser: MATT LORD Tag: Y N Tag info: _____
 Owner: LI, SUMEI Last Sales Date: 06/30/2021 Roll Type: R
 Cycle: ag Sales Verification Other: _____ Inspection level: 2 3 4 LCB TO INSP AV: 123921
 RMV Land: 466200 RMV Imp: 131370 RMV Total: 597570 MAV: 84900 MSAV: 39021 SAV: 81809
 Comment: 2/3/22 L3 MLORD

Converting upstairs Attic to living space w/ Bathroom

Notations

RP/MS	Code	Description
RP	ZONED	FARM EFU ZONED

OSDs

Count	Code	Description	RMV	Code Area	Exception
1	SAN	SA OSD - NO LANDSCAPE	40000	29540	0

Land

Site: 1 Code Area: 29540 Size: 1.00 Acres Use Code: 005 Zone: UT SAV Use: 011 Exception: 0
 Class: 4BDSS Value Source: Farm Homesite Description: FOUR BENCH DRY SPECIAL SOUTH RMV: 23270 Exception: Y N
 Adjustment(s): IRR, WASTE Fire Patrol: Description:
 Comments: Liability year - 2009 / 2900040 /00-01; SEPERATED INCREMENT FROM HOMESITE /02-03: REAPPRAISAL 05-06: F05-0267 CREATES R336564 FROM R33982, NO IMPS MOVING

Site: 2 Code Area: 29540 Size: 16.43 Acres Use Code: 005 Zone: UT SAV Use: 011 Exception: 0
 Class: 4BISS Value Source: Farm Use - EFU Description: FOUR BENCH IRR SPECIAL SOUTH RMV: 401530 Exception: Y N
 Adjustment(s): IRR, WASTE Fire Patrol: Description:
 Comments: Liability year - 1980 / 2900040 //F05-694 ACREAGE CORRECTION, NO VALUE CHANGE

Site: 3 Code Area: 29540 Size: 2.00 Acres Use Code: 005 Zone: UT SAV Use: 011 Exception: 0
 Class: WST Value Source: WASTE RURAL Description: Rural WASTELAND RMV: 1400 Exception: Y N
 Adjustment(s): IRR, WASTE Fire Patrol: Description:
 Comments: Liability year - 1980 / //08-09: Market wasteland study by GW39 - change from wasteland to wasteland-M//2900040 05-06: F05-0267 CREATES R336564 FROM R33982, NO IMPS MOVING

Add Bath + Trade w/ 11/27 1992 R/W/P/S 90%

Improvements - Residence / Manufactured Structures

Bldg: 1 Code Area: 29540 Stat Class: 132 + Year Blt: 1930 Eff Year Blt: 1945 Sq.Ft: 1424 % Complete: 100.00
 Desc: Multi Story above grade Dimensions: RMV: 127490
 Func Obsc: 100 Econ %: 100 Other %: 100 Exception: 0 Adjust: Adjust RMV: 0

Floors

Type	Class	Display Group	Floor Size	Beds	Baths	Yr Blt	Eff Yr Blt	Inventory	Exception
First Floor	3 +	Finished	1424	2	FB-1/ HB-1	1930	1945	KIT-, ROOF, HVAC, BTH - 1, BATH - 1	Y N
Attic	3 +	Unfinished	448	1	0	1930	1945		Y N

Accessories

413A I/O

Description	Class	Size SqFt	Eff Yr Blt	RMV	Quantity	Exception
PATIO	3	50	1986	223	1	Y N
PATIO	3	133	1945	468	1	Y N
ROOF EXTENSION OR PATIO COVER	3	50	1986	1175	1	Y N
ROOF EXTENSION OR PATIO COVER	3	133	1945	2468	1	Y N

Improvements - Accessory Buildings

Bldg: 2 Code Area: 29540 Stat Class: 351 Year Blt: 1986 Eff Year Blt: 1986 Sq.Ft: 960 % Complete: 100.00
 Desc: General Purpose Building (GB) Dimensions: 40x24 RMV: 3790
 Func Obsc: 100 Econ %: 100 Other %: 100 Exception: 0 Adjust: Adjust RMV: 0

Floors

Type	Class	Display Group	Floor Size	Beds	Baths	Yr Blt	Eff Yr Blt	Inventory	Exception
General Purpose Bldg	4	Finished	960	0	0	1986	1986	FAIR	Y N

Accessories

No accessory data available

Bldg: 3 Code Area: 29540 Stat Class: 341 Year Blt: 1986 Eff Year Blt: 1986 Sq.Ft: 96 % Complete: 100.00
 Desc: Multi Purpose Shed (MP) Dimensions: 12x8 RMV: 90
 Func Obsc: 100 Econ %: 100 Other %: 100 Exception: 0 Adjust: Adjust RMV: 0

Floors

Type	Class	Display Group	Floor Size	Beds	Baths	Yr Blt	Eff Yr Blt	Inventory	Exception: Y N
Multi-Purpose Bldg	4	Finished	96	0	0	1986	1986	FAIR	

Accessories

Description	Class	Size SqFt	Eff Yr Blt	RMV	Quantity
No accessory data available					

Permits

Permit Number	Permit ID	Origin	Category	Type	Estimate Value	% Complete	Roll Type	Description
25-008638	85535	MARION COUNTY	TAGS/PERMITS	REPAIR/REMODEL	60872	0	R	INT REMODEL TO CONVERT UPSTAIRS ATTIC INTO HABITABLE LIVING SPACE & ADD HALF BATH



Per Builder still under construction

Percent Complete Form

Account # 533982

Additions

New Homes

<u>Additions</u>		<u>New Homes</u>				
<u>% Item</u>	<u>% Sum</u>		<u>No Basement</u>		<u>Basement</u>	
			<u>% Item</u>	<u>% Sum</u>	<u>% Item</u>	<u>% Sum</u>
3%	0%	Plans/Survey	3%	0%	3%	0%
2%		Excavation	2%		4%	
3%		Foundation	3%		10%	
35%	45%	Framing	14%	20%	16%	35%
8%	50%	Trusses	7%	30%	7%	40%
7%	60%	Roofing	7%	35%	7%	45%
7%	65%	Windows/Ext Doors	7%	45%	6%	55%
5%	70%	Siding	5%	50%	5%	60%
4%	75%	Plumbing Rough-In	4%		3%	
3%		Electrical Rough-In	3%	55%	2%	65%
2%	80%	Heating Rough-In	2%		1%	
		Heating Unit	1%	1%		
3%		Insulation	3%	60%	2%	
5%	85%	Drywall (Finished)	5%	65%	4%	70%
2%	90%	Paint Interior	2%	70%	2%	75%
2%		Paint Exterior	2%		2%	
		Cabinets	6%	75%	5%	80%
2%	95%	Electrical Fixtures	3%	80%	2%	
2%		Plumbing Fixtures	4%	85%	3%	85%
3%		100%	Floor Coverings & Countertops	7%	90%	6%
2%	Interior Trim Carpentry		7%	95%	6%	95%
	Porch/Entry/Stoop		2%	100%	2%	100%
	Finish Grade		1%		1%	

APPR 555
 APPR _____
 APPR _____
 APPR _____

Date 3.20.26 YR For 26-27
 Date _____ YR For _____
 Date _____ YR For _____
 Date _____ YR For _____

% COMP 90
 % COMP _____
 % COMP _____
 % COMP _____

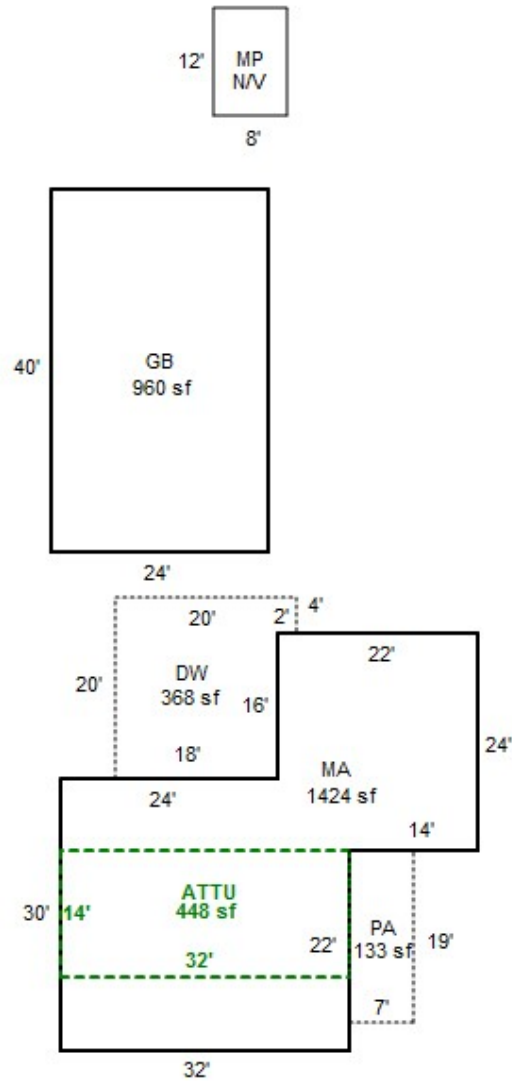

SSS 3.24.26 Trgs L2