

Summary

Lead Appr: WW Clerk: _____ Lead Clerk: _____ Appr: MLH 4/7/26

Print Date: 9/26/2025

Acct ID: 519333 MTL: 062W33B001400 Date: 4/2/26 Appr: MLH Prop Class: 921 RMV Prop Class: 451
Situs: 5774 HAZELGREEN RD NE SALEM OR 97305 MaSaNh: 03 06 000 Unit: 90267 Year: 2025

2026

Last Date Appraised: 08/08/2024 Appraiser: MATTHEW HAMILTON Tag: Y N Tag info: _____
Owner: BAKER CHARTER SCHOOL Last Sales Date: 07/10/2025 Roll Type: R
Cycle: Tag Sales Verification Other: _____ Inspection level: 1 2 3 4 LCB TTO INSP AV: 0
RMV Land: 493340 RMV Imp: 2065150 RMV Total: 2558490 MAV: 0 MSAV: 0 SAV: 0
Comment: 24-25: L2 08.08.24 GRH/WW
LEVEL 4 C19 4-27-20 06WW
Imp: ELEM SCHOOL CLASS D

EMAIL BRADLI

Classrooms onsite but not connected
Retag for 27 Input MLH
4/2/26

OSDs

Count	Code	Description	RMV	Code Area	Exception
2	MKTA	OSD - AVERAGE	50000	92410	0

Land

Site: 1 Code Area: 92410 Size: 3.29 Acres Use Code: 005 Zone: REST SAV Use: _____ Exception: 0
 Class: 2B1 Value Source: Rural Restrictive Description: TWO BENCH IRR RMV: 169120 Exception: Y N
 Adjustment(s): GSOIL, IRR Fire Patrol: _____ Description: _____
 Comments: 21-22: #06 CYCLE C19, NO CHG //IRREG; ORIG VAL = 51540 /01-02; CORRECTING ACCTS W/NO MKT VALUE - XTCV SEGMENTS - VALUE TAKEN FROM XTCV ACCT 06-07: RECALC SETUP, APPR NO 52, 10/21/05

Site: 2 Code Area: 92410 Size: 4.56 Acres Use Code: 005 Zone: REST SAV Use: _____ Exception: 0
 Class: 2BD Value Source: Rural Restrictive Description: TWO BENCH DRY RMV: 224220 Exception: Y N
 Adjustment(s): GSOIL, IRR Fire Patrol: _____ Description: _____
 Comments: IRREG; ORIG VAL = 83070 /01-02; CORRECTING ACCTS W/NO MKT VALUE - XTCV SEGMENTS - VALUE TAKEN FROM XTCV ACCT 06-07: RECALC SETUP;#T41 10-20-05

Improvements - Commercial Industrial

Bldg: 2 Code Area: 92410 Stat Class: 820 Year Blt: 1998 Eff Year Blt: _____ Sq.Ft: 1792 % Complete: 100.00
 Desc: OTHER SCHOOLS Dimensions: _____ RMV: 110920
 Func Obsc: 100 Econ %: 100 Other %: 100 Exception: 0 Adjust: _____ Adjust RMV: 0

Section 1

SC Desc: RELOCATABLE CLASSROOM SqFt: 1792 Depreciation Type: MarshallAndSwiftTables
 Stories: _____ Perimeter: 184 Shape: _____ Exception: Y N Depreciation Value: 20

Occupancies

Code	Description	Quality	Class	Description	Height	%Area
598	Relocatable Classroom	2.00	D	Wood or Steel Framed Exterior Walls	10	100

Components

Code	Description	%	Quality	Depr %	Input 1 Value	Input 2 Value	Input 3 Value	Input 4 Value	Input 5 Value
1	Base Cost	100							
3	Default Heating	100							
764	Fire Alarm System				1792				

Additions

Type	Description	Units	Cost	Depr %
Base Cost	EP&O	0	28440	0

Bldg: 3 Code Area: 92410 Stat Class: 820 Year Blt: 1989 Eff Year Blt: _____ Sq.Ft: 12476 % Complete: 100.00
 Desc: OTHER SCHOOLS Dimensions: _____ RMV: 1870310
 Func Obsc: 100 Econ %: 100 Other %: 100 Exception: 0 Adjust: _____ Adjust RMV: 0

Section 1

SC Desc: ELEMENTARY SCHOOL SqFt: 12476 Depreciation Type: MarshallAndSwiftTables
 Stories: _____ Perimeter: 580 Shape: _____ Exception: Y N Depreciation Value: 20

Occupancies

Code	Description	Quality	Class	Description	Height	%Area
365	Elementary School (Entire)	2.00	D	Wood or Steel Framed Exterior Walls	10	100

Components

Code	Description	%	Quality	Depr %	Input 1 Value	Input 2 Value	Input 3 Value	Input 4 Value	Input 5 Value
1	Base Cost	100							
3	Default Heating	100							
681	Sprinklers	100							
764	Fire Alarm System				12476				
896	Stud Walls-Wood Siding	100							

Additions

Type	Description	Units	Cost	Depr %
Base Cost	EP&O	0	256207	0

N/C

Improvements - Accessory Buildings

Bldg: 1 Code Area: 92410 Stat Class: 342 Year Blt: 1998 Eff Year Blt: 1998 Sq.Ft: 4800 % Complete: 100.00
 Desc: Metal Component Building (MC) Dimensions: 80x60 RMV: 83920
 Func Obsc: 100 Econ %: 100 Other %: 100 Exception: 0 Adjust: Adjust RMV: 0

Floors

Type	Class	Display Group	Floor Size	Beds	Baths	Yr Blt	Eff Yr Blt	Inventory	Exception: Y * N
Metal Componet Bldg	6	Finished	4800	0	0	1998	1998	AVG	

Accessories

Description	Class	Size SqFt	Eff Yr Blt	RMV	Quantity
No accessory data available					

Permits

Permit Number	Permit ID	Origin	Category	Type	Estimate Value	% Complete	Roll Type	Description
25-002529	83465	MARION COUNTY	NEW CONSTRUCTION	ADDITION	250000	0	R	BLDG 1 - NEW PORTABLE CLASSROOM, 77 OCCUPANTS (NOT TIED TO ACTUAL ENROLLMENT.)
25-002540	83466	MARION COUNTY	NEW CONSTRUCTION	ADDITION	250000	0	R	BLDG 2 - NEW PORTALBE CLASSROOM, 77 OCCUPANTS (NOT TIED TO ACTUAL ENROLLMENT.)
25-002541	83467	MARION COUNTY	NEW CONSTRUCTION	ADDITION	250000	0	R	BLDG 3 - NEW PORTALBE CLASSROOM, 77 OCCUPANTS (NOT TIED TO ACTUAL ENROLLMENT.)
25-002542	83468	MARION COUNTY	NEW CONSTRUCTION	ADDITION	250000	0	R	BLDG 4 - NEW PORTALBE CLASSROOM, 77 OCCUPANTS (NOT TIED TO ACTUAL ENROLLMENT.)
25-002544	83469	MARION COUNTY	NEW CONSTRUCTION	ADDITION	250000	0	R	BLDG 5 - NEW PORTALBE CLASSROOM, 77 OCCUPANTS (NOT TIED TO ACTUAL ENROLLMENT.)







SKETCH/AREA TABLE ADDENDUM

SUBJECT INFO

File No.: 519333 Parcel No.: 062W33B 01400
 Property Address: 5774 HAZELGREEN RD NE
 City: SALEM County: MARION State: OR ZipCode: 97305
 Owner:
 Client: Client Address:
 Appraiser Name: Inspection Date:

SKETCH

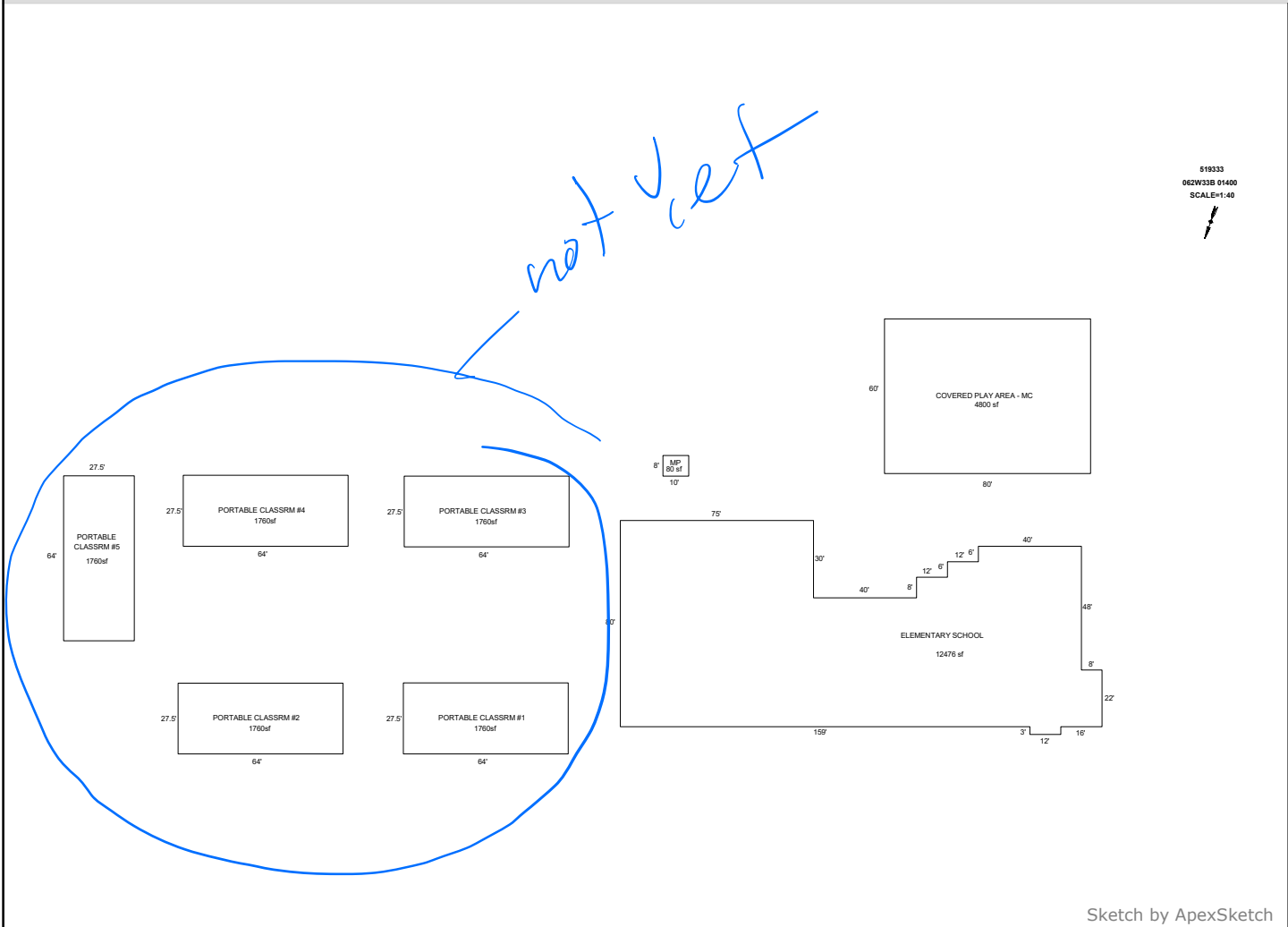

AREA CALCULATIONS SUMMARY

Code	Description	Factor	Net Size	Perimeter	Net Totals
GBA1	MP	1.0	80.0	36.0	
	COVERED PLAY A	1.0	4800.0	280.0	
	PORTABLE CLASS	1.0	1760.0	183.0	
	PORTABLE CLASS	1.0	1760.0	183.0	
	PORTABLE CLASS	1.0	1760.0	183.0	
	PORTABLE CLASS	1.0	1760.0	183.0	13680.0
GLA1	ELEMENTARY SCH	1.0	12476.0	580.0	12476.0
	Net LIVABLE	cnt	0 (rounded)		12,476
	Net BUILDING	cnt	7 (rounded)		13,680

COMMENT TABLE 1

DRAWN BY JRONDEMA 10/16/17
 UPDATED BY WW 6/7/23
 UPDATED BY CLOBERG 09/05/25 25-002529 BLDG 1
 25-002540 BLDG 2, 25-002541 BLDG 3, 25-002542 BL
 25-002544 BLDG 5

COMMENT TABLE 2

RAM ID 446099 COM

COMMENT TABLE 3

6/7/23

4/2/26 MLH Tags LZ